

Subdivision of T 44 N, R 38 E

Chains

55.55 Day channel of Skull creek, course N. W.
60.60 Road, bears N. E. and S. W.

76.60 Intersect the N. bdy. of the tp. at
N 89° 40' E, 3.35 chs from the cor. of
secs. 32 and 33

Set an iron post 3 ft. long, 2 ins.
diam. 24 ins. in the ground for
closing corner of secs. 4 and 5
with brass cap mkd.

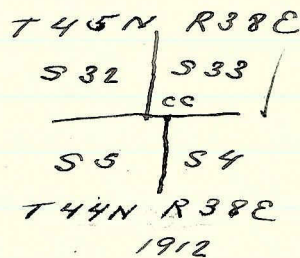

Dig pits 24 x 18 x 12 ins. crosswise on
each line, E. and W. 3 ft. and S. of
post, 7 ft. dist. and raise a mound
of earth 4 ft. base, 2 ft. high S of cor.
Land, S. 36.00 chs. low rolling mountains
N. 40.60 chs. level land.

Soil, in mountains, rocky. 4th. rate
unfit for cultivation,
level land, good loam soil,
1st. rate.

Good growth sage brush, little grass,
no timber. General N. W. slope.

Oct. - 29, 1912.

Oct. 30, 1912

at the cor. of secs. 5, 6, 31 and 32 on the
S. bdy. of the tp., established by me
Oct. 14, 1912, at 8 h. a.m. l.m.t., I
set off 41° 38' N. on the lat. arc, 13° 47' S.
on the decl. arc. and determine a true
meridian with the solar.

Thence I run
N 01° E bet. secs. 31 and 32

Over high mountains.

4.00 High mountain ridge, bears E. and W.
descend N. slope

21.10 Ravine, course N. W.