

chains

N, S, and W edges. and change the mound of stone necessary from the S. to the W. side of cor.

At the point of intersection of S. bdy. of T 40 N, R 32 E with the E. bdy. of T 40 N R 31 E.

Set an iron post 3 ft. long, 3 ins. diam. 2 1/4 ins. in the ground for closing corner of T po. 39 and 40 N, R 32 E with brass cap mkd.

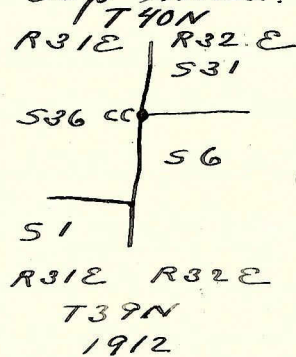

and raise a mound of stone 2 ft. base 1 1/2 ft. high E. of cor.

Land, high, rough mountains, with southerly and north westerly slope.

Soil, thin and rocky, wholly unfit for cultivation.

Good growth sagebrush, little grass, no timber.

Sept. 5, 1912.

General Description.

This bdy. is wholly across rough mountainous land. The E. 4 miles 18.60 chs. drains to the S.E. At this point there is a divide formed by an arm of the Jackson mountains running to the S.E. from the main range. From the 4 mile 18.60 ch. point to the 5 mile 36.00 ch. point the mountains drain to the S.W. and from the 5 mile 36.00 ch. point to the closing up cor. of T po. 39 and 40 N, R 32 E they drain N.W. into Jackson creek. The mountains are high and rough, unfit for cultivation, but are a good stock range, there being more than the usual amount of kumage and plenty of water.

Sept. 5, 1912.

Winfred A. Pray
U.S. Surveyor