

## Subdivision of T18N, R22E

chains.

for cultivation. Good growth sagebrush, little grass, no timber. Rolling basalt mountains, no signs of mineral, land of very little value. Slopes westerly.

- N 0° 3' W on a true line bet. secs. 5 and 6  
Over rolling mountains
- 16.25 Ravine, course N. W.
- 38.20 Ridge, bears E. and W.
- 40.00 Set a basalt stone  $21 \times 8 \times 5$  ins.  
14 ins. in the ground for  $\frac{1}{4}$  sec. cor.  
marked  $\frac{1}{4}$  on the W. face; and  
raise a mound of stone 2 ft. base  
 $1\frac{1}{2}$  ft. high W. of cor.
- 55.50 Ravine, course S. W.
- 77.10 Rocky hill, bears E. and W.
- 78.74 Intersect the N. bdy. of the tp. at  
W., 1.61 chs. from the cor. of secs.  
31 and 32, established by me June  
, 1911.
- Set an iron post 3 ft. long, 2 ins.  
diam. 24 ins. in the ground for  
closing corner of secs. 5 and 6 with  
brass cap mkd

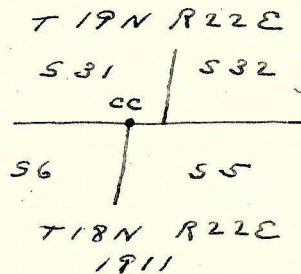

and raise a mound of stone 2 ft. base,  $1\frac{1}{2}$  ft. high S. of cor.  
Land, mountainous.  
Soil, rocky. 4th rate, wholly unfit for cultivation. Good growth sagebrush, little grass, no timber. Rolling basalt mountains, no signs of mineral, land of very little value, slopes S. W.

Aug. 3, 1911.