

UNSURVEYED TOWNSHIP 22 SOUTH RANGE 69 EAST OF THE MOUNT DIABLO MERIDIAN, NEVADA

PROTRACTION DIAGRAM NO 3

CLARK COUNTY

STATUS OF PUBLIC DOMAIN
LAND AND MINERAL TITLES

MT PLAT

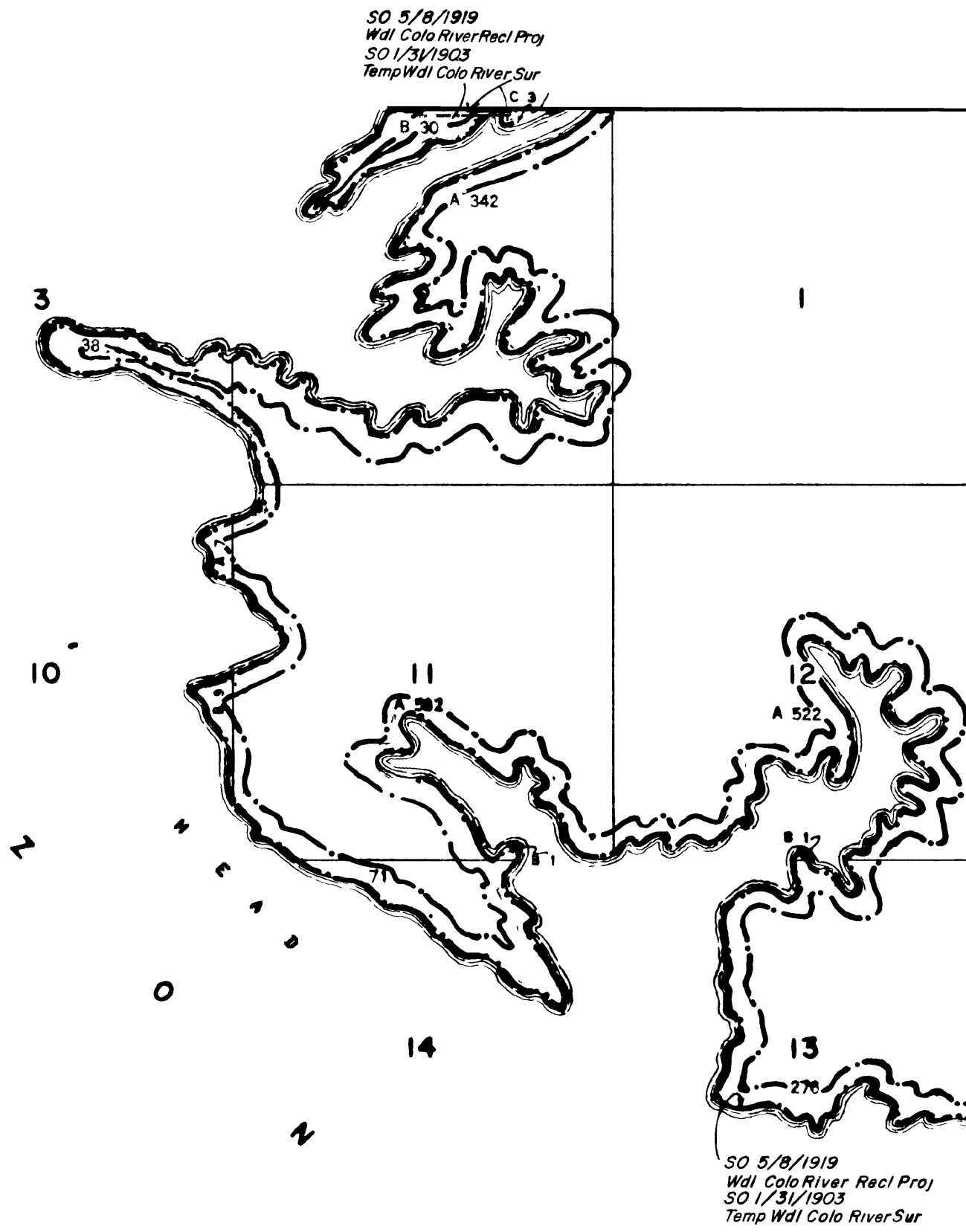

INDEX TO SEGREGATED TRACTS				
RESURVEY TRACT NO	ORIGINAL SURVEY			
	T	R	SEC	SUBDIVISION

FOR ORDERS EFFECTING DISPOSAL OR USE OF UNIDENTIFIED LANDS WITHDRAWN FOR CLASSIFICATION, MINERALS, WATER AND/OR OTHER PUBLIC PURPOSES, REFER TO INDEX OF MISCELLANEOUS DOCUMENTS.

Wdl Pwr Site Res 446 SO 9/5/1914 affects all lands within 1/2 mile of Colo River

Wdl Pwr Site CI 210 SO 12/12/1928 affects lands below 1250' above sea level

All Tp included in Wdl Lake Mead N. Rec Area Act of Cong 10/8/5

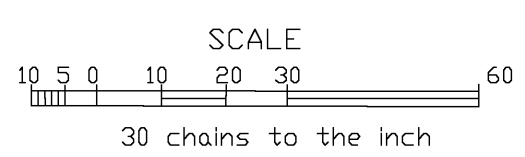

WARNING STATEMENT
This plat is the Bureau's representation of the Record of Title and should be used only as a graphic display of the township survey data. Records hereon do not reflect title changes which may have been effected by lateral movements of rivers or other bodies of water. Refer to the cadastral surveys for official survey information.

CURRENT TO	BY
1-4-84	NL
9/3/85	JACIL <i>JACIL</i>

N-050
T. 22S
R. 69E