

CLARK COUNTY  
LAS VEGAS GR DIST

## STATUS OF PUBLIC DOMAIN LAND AND MINERAL TITLES AND ACQUIRED LANDS

MT  
SUPPL Sec 13

[illegible]

FOR ORDERS EFFECTING DISPOSAL OR USE OF  
UNIDENTIFIED LANDS WITHDRAWN FOR CLASSIFICATION,  
MINERALS, WATER AND/OR OTHER PUBLIC PURPOSES.  
REFER TO INDEX OF MISCELLANEOUS DOCUMENTS.

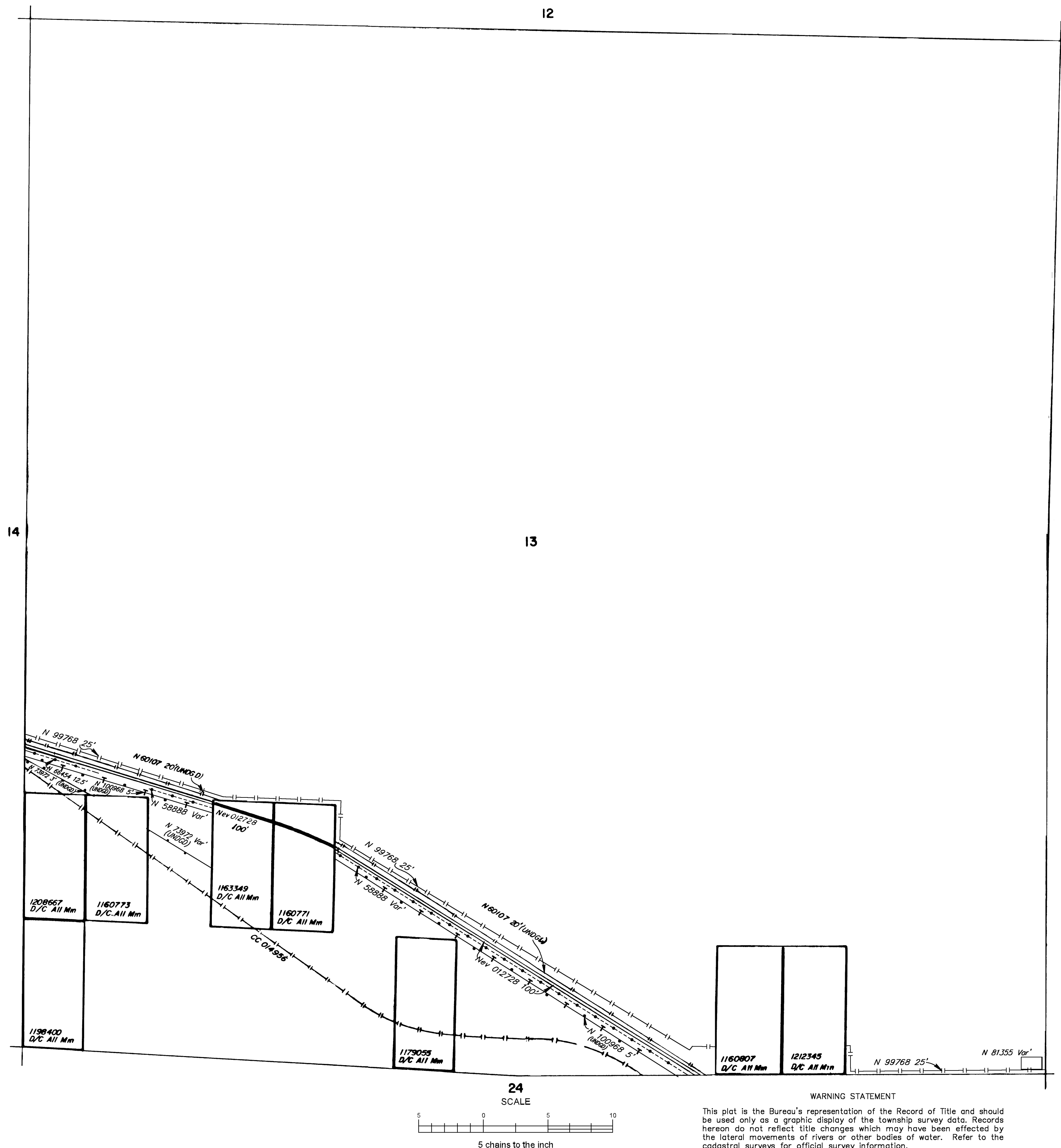

CURRENT TO	BY	CURRENT TO	BY
05/16/2024	TJ		

PLAT TYPE
-----------

T. 22 S  
R. 59 E  
Sec 13