

# UNSURVEYED TOWNSHIP 21 SOUTH RANGE 64 EAST OF THE MOUNT DIABLO MERIDIAN, NEVADA

PROTRACTION DIAGRAM NO 5

CLARK COUNTY

STATUS OF PUBLIC DOMAIN  
LAND AND MINERAL TITLES

## MT PLAT

INDEX TO SEGREGATED TRACTS				
TRACT NO	ORIGINAL SURVEY			
	T	R	SEC	SUBDIVISION

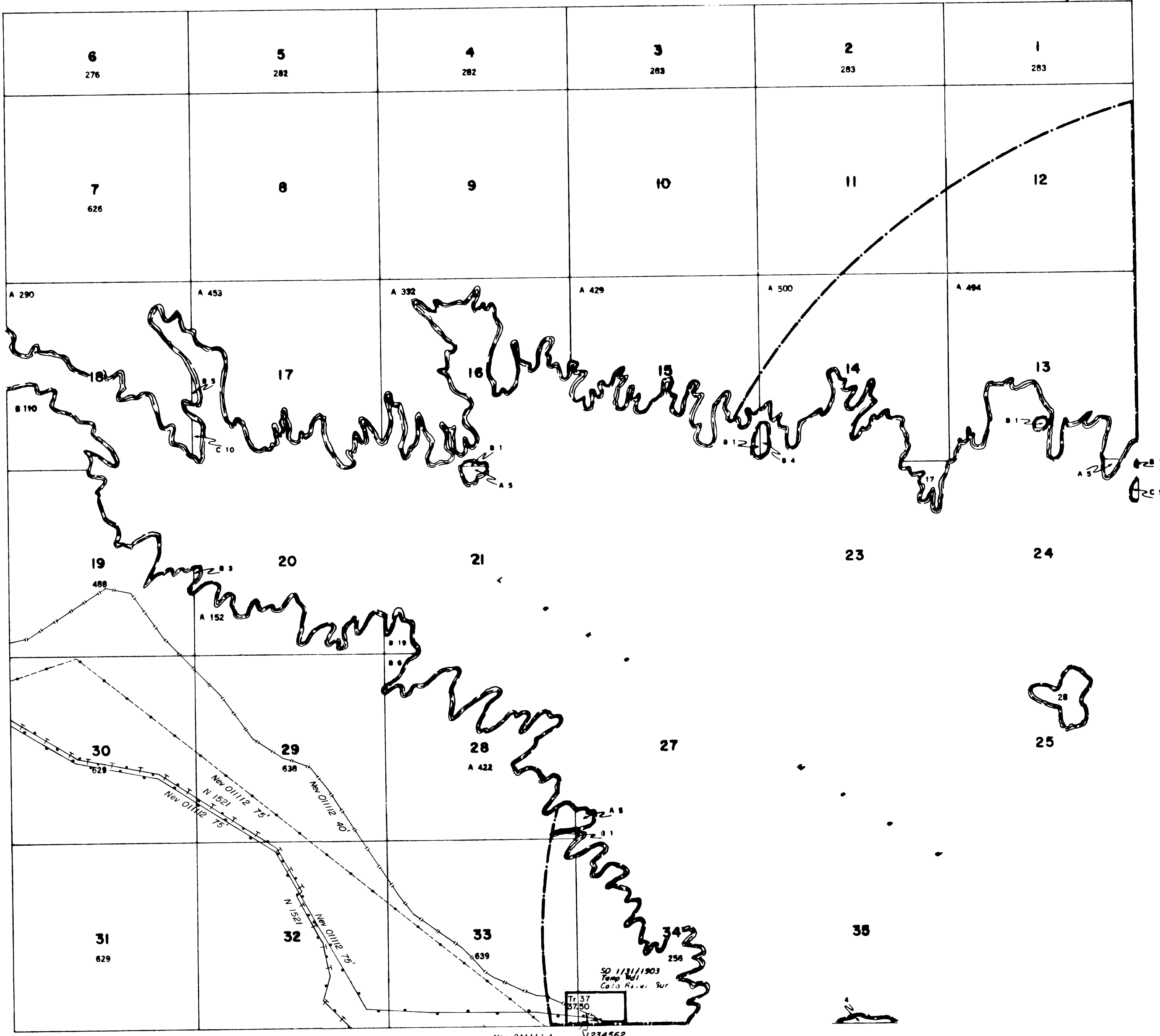

FOR ORDERS EFFECTING DISPOSAL OR USE OF UNIDENTIFIED LANDS WITHDRAWN FOR CLASSIFICATION, MINERALS, WATER AND/OR OTHER PUBLIC PURPOSES, REFER TO INDEX OF MISCELLANEOUS DOCUMENTS.

SO 1/7/1929 WdL Pwr Site CL 210 affects all lands at an altitude of less than 1250' above sea level to be interpreted to include when surveyed every smallest legal subdiv any part of which lies at altitude within Secs 2,3,4,5, 6,7,8,9,10,11,12,13,14,15,16,17,18,20,21,22,23, 24,25,26,27,28,29,33,34,35,36

All Tp included in WdL Recl Proj SO 8/7/1920

All Tp included in WdL Lake Mead N. Rec Area Act of Cong 10/8/1964

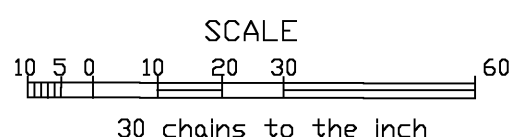

WARNING STATEMENT  
This plat is the Bureau's representation of the Record of Title and should be used only as a graphic display of the township survey data. Records hereon do not reflect title changes which may have been effected by lateral movements of rivers or other bodies of water. Refer to the cadastral surveys for official survey information.

CURRENT TO	BY
8-3-82	
12-13-82	
5-17-97	JML

T. 21 S.  
R. 64 E.