

# UNSURVEYED TOWNSHIP 19 SOUTH RANGE 66 EAST OF THE MOUNT DIABLO MERIDIAN, NEVADA

PROTRACTION DIAGRAM NO 41

CLARK COUNTY  
LAS VEGAS GR DIST

STATUS OF PUBLIC DOMAIN  
LAND AND MINERAL TITLES

## MT PLAT

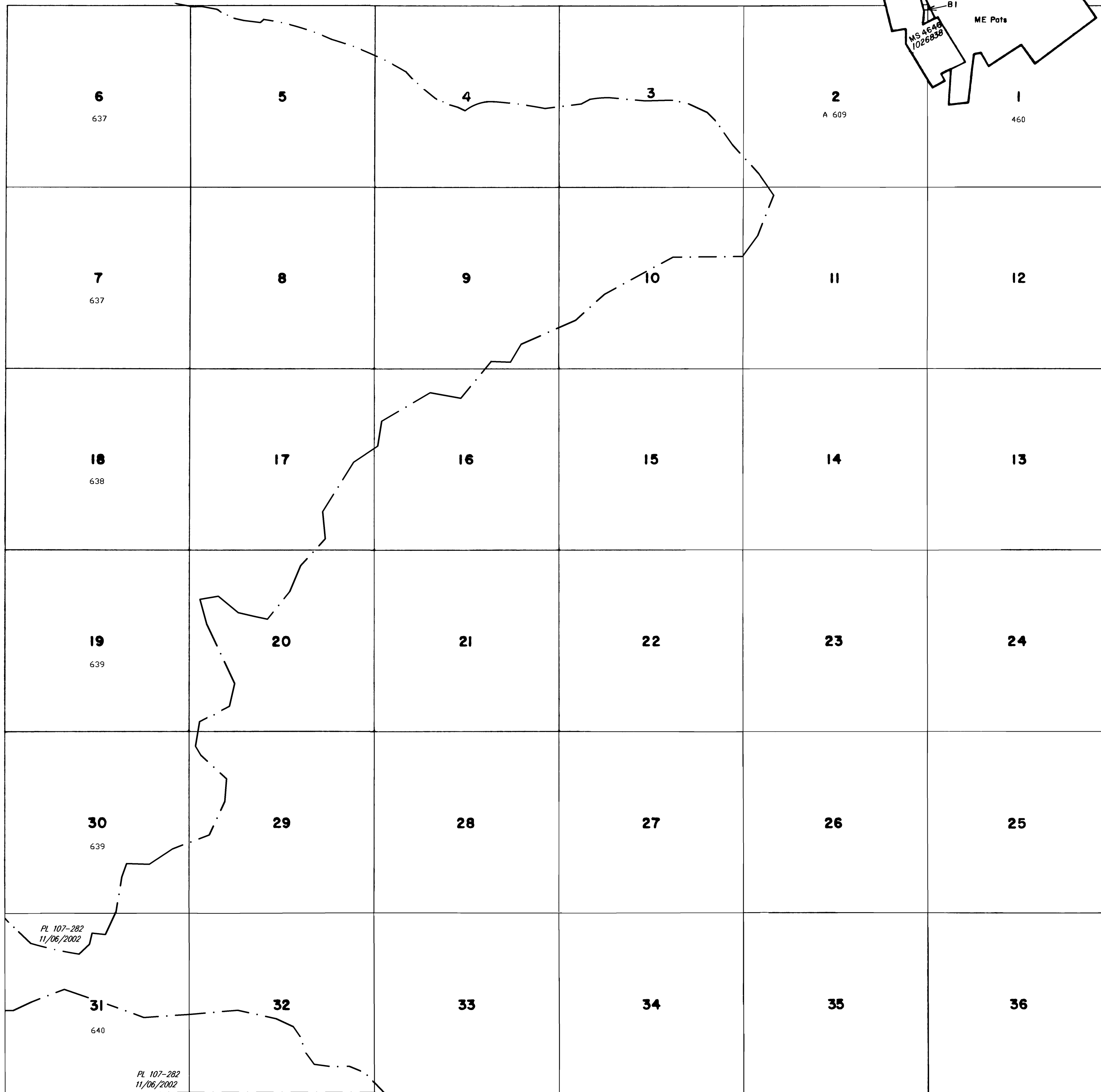

INDEX TO SEGREGATED TRACTS				
RESURVEY		ORIGINAL SURVEY		
TRACT NO	T	R	SEC	SUBDIVISION

**FOR ORDERS EFFECTING DISPOSAL OR USE OF UNIDENTIFIED LANDS WITHDRAWN FOR CLASSIFICATION, MINERALS, WATER AND/OR OTHER PUBLIC PURPOSES, REFER TO INDEX OF MISCELLANEOUS DOCUMENTS.**

*PL 107-282 Muddy Mountain wilderness Area  
N 76664 Affects:  
Secs: 2-11, 16-20, 29-33*

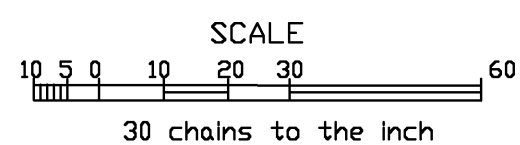

**WARNING STATEMENT**

This plat is the Bureau's Record of Title and should be used only as a graphic display of the township survey data. Records hereon do not reflect title changes which may have been effected by lateral movements of rivers or other bodies of water. Refer to the cadastral surveys for official survey information.

CURRENT TO	BY
08/31/05	GRC
7/31/06	SLL

N 050  
T. 19S  
R. 66E