

TOWNSHIP 19 SOUTH RANGE 60 EAST OF THE MOUNT DIABLO MERIDIAN, NEVADA

LAS VEGAS GR DIST

STATUS OF PUBLIC DOMAIN
LAND AND MINERAL TITLES
AND ACQUIRED LANDS

MTP Suppl Sec 31

INDEX TO SEGREGATED TRACTS				
RESURVEY TRACT NO	ORIGINAL SURVEY			
	T	R	SEC	SUBDIVISION

FOR ORDERS EFFECTING DISPOSAL OR USE OF UNIDENTIFIED LANDS WITHDRAWN FOR CLASSIFICATION, MINERALS, WATER AND/OR OTHER PUBLIC PURPOSES, REFER TO INDEX OF MISCELLANEOUS DOCUMENTS.

Certain lands in Secs 31 of this township are affected by unrecorded public dedications for roads and utilities due to previous small tract Cl. See the historical index for specific lands affected by small tract Cl.

N 55952 Natural Gas Pipeline affects TP:
Sec 31; E2SWNESW, W2SESESW, S2SWSESW, S2SESESE. (W/1)

N 59043 R/W Powerline affects TP:
Sec 31; NWNESWSW, NWNWSESW. (W/1)

N 59198 R/W Rd & Drainage Channel affects TP:
Sec 31; Lots 18 & 20, SWNESWSW, N2SESESW, W2SWSESW. (W/1)

N 58560 R/W Rd 25' affects TP:
Sec 31; Lots 5&6, N2NWNENWNW, N2SWSESW, N2SESESESW. (W/1)

N 61329 Water Pipeline Var' Affects;

- Sec 17: Lot 18, 19;
- Sec 19: SE1/4SE1/4SE1/4SE1/4;
- Sec 20: W1/2NW1/4SE1/4SW1/4;
- Sec 29: W1/2W1/2SW1/4NW1/4;
- W1/2W1/2SW1/4NW1/4NW1/4;
- N1/2NE1/4NE1/4NW1/4NW1/4;
- Sec 30: S1/2SW1/4SW1/4SW1/4SE1/4;
- E1/2SE1/4SE1/4NE1/4;
- E1/2NE1/4NE1/4NE1/4;
- Sec 31: E1/2NE1/4SE1/4SW1/4;
- E1/2E1/2NE1/4SW1/4;
- W1/2SW1/4SW1/4NE1/4;
- E1/2E1/2SE1/4NW1/4;
- E1/2NE1/4NE1/4NW1/4;
- W1/2NW1/4NE1/4;
- N1/2NW1/4NW1/4NE1/4;
- N1/2NE1/4NE1/4.

CURRENT TO	BY	CURRENT TO	BY
01/23/2025	TJ		

PLAT TYPE

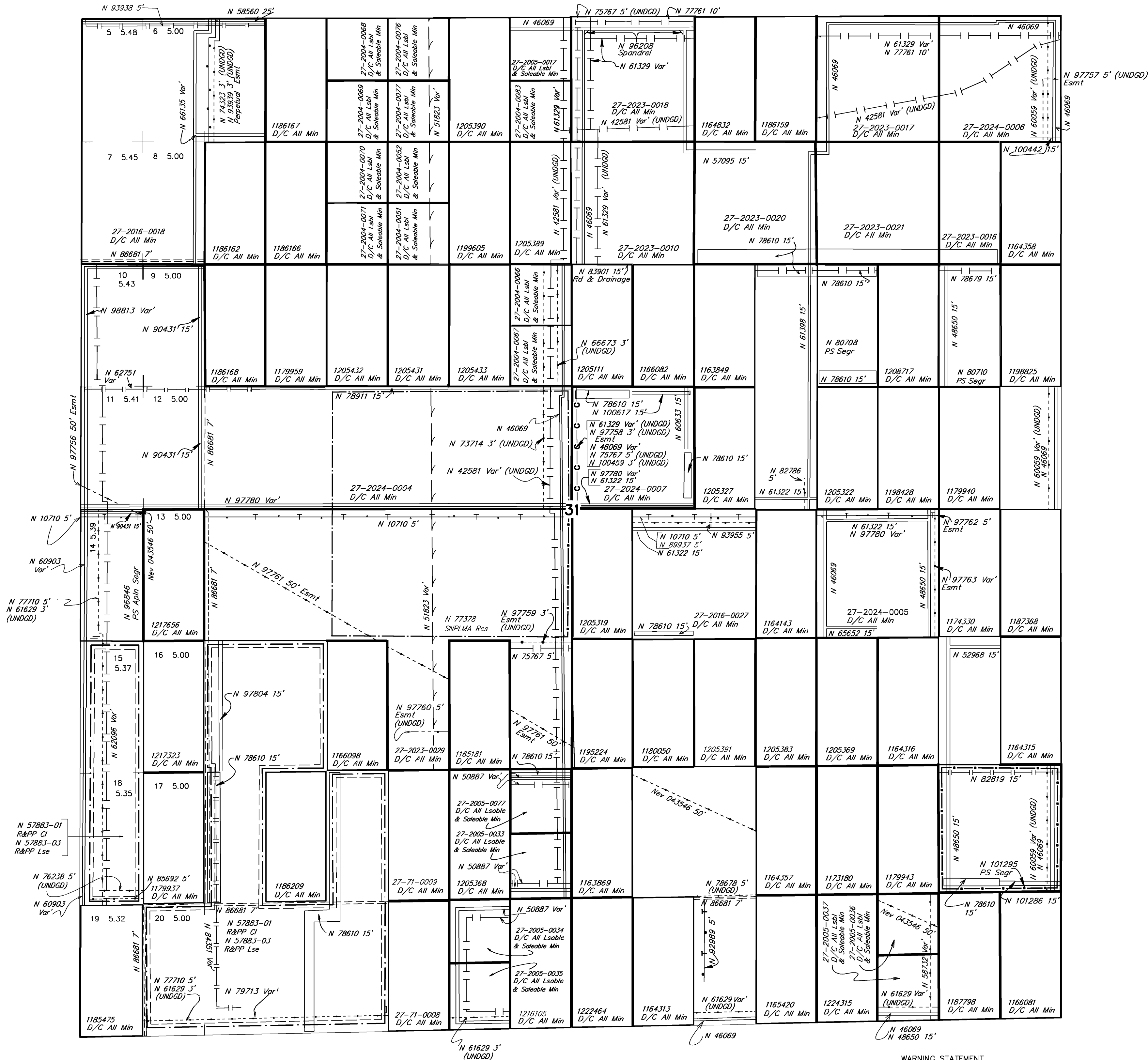

WARNING STATEMENT

This plat is the Bureau's representation of the Record of Title and should be used only as a graphic display of the township survey data. Records hereon do not reflect title changes which may have been effected by the lateral movements of rivers or other bodies of water. Refer to the cadastral surveys for official survey information.

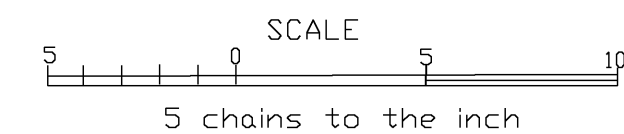

T. 19 S
R. 60 E
Sec 31