

CLARK COUNTY  
LAS VEGAS GR DIST

## STATUS OF PUBLIC DOMAIN LAND AND MINERAL TITLES

[illegible]

FOR ORDERS EFFECTING DISPOSAL OR USE OF  
UNIDENTIFIED LANDS WITHDRAWN FOR CLASSIFICATION,  
MINERALS, WATER AND/OR OTHER PUBLIC PURPOSES,  
REFER TO INDEX OF MISCELLANEOUS DOCUMENTS.

All Tp included in Wal Desert National Wildlife R  
PLO 4079 8/26/1966: N 219

N 54955, PLO 7828, Wdl Desert Natl Wildlife R Ext:  
Entire Tp

| CURRENT TO | BY  | CURRENT TO | BY |
|------------|-----|------------|----|
| 7/2/2013   | MS  |            |    |
| 2/7/2019   | ART |            |    |
|            |     |            |    |
|            |     |            |    |
|            |     |            |    |

|           |        |
|-----------|--------|
| PLAT TYPE | N-050  |
|           | T. 18S |
|           | R. 61E |

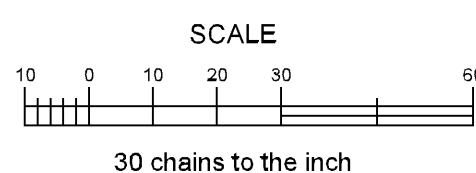
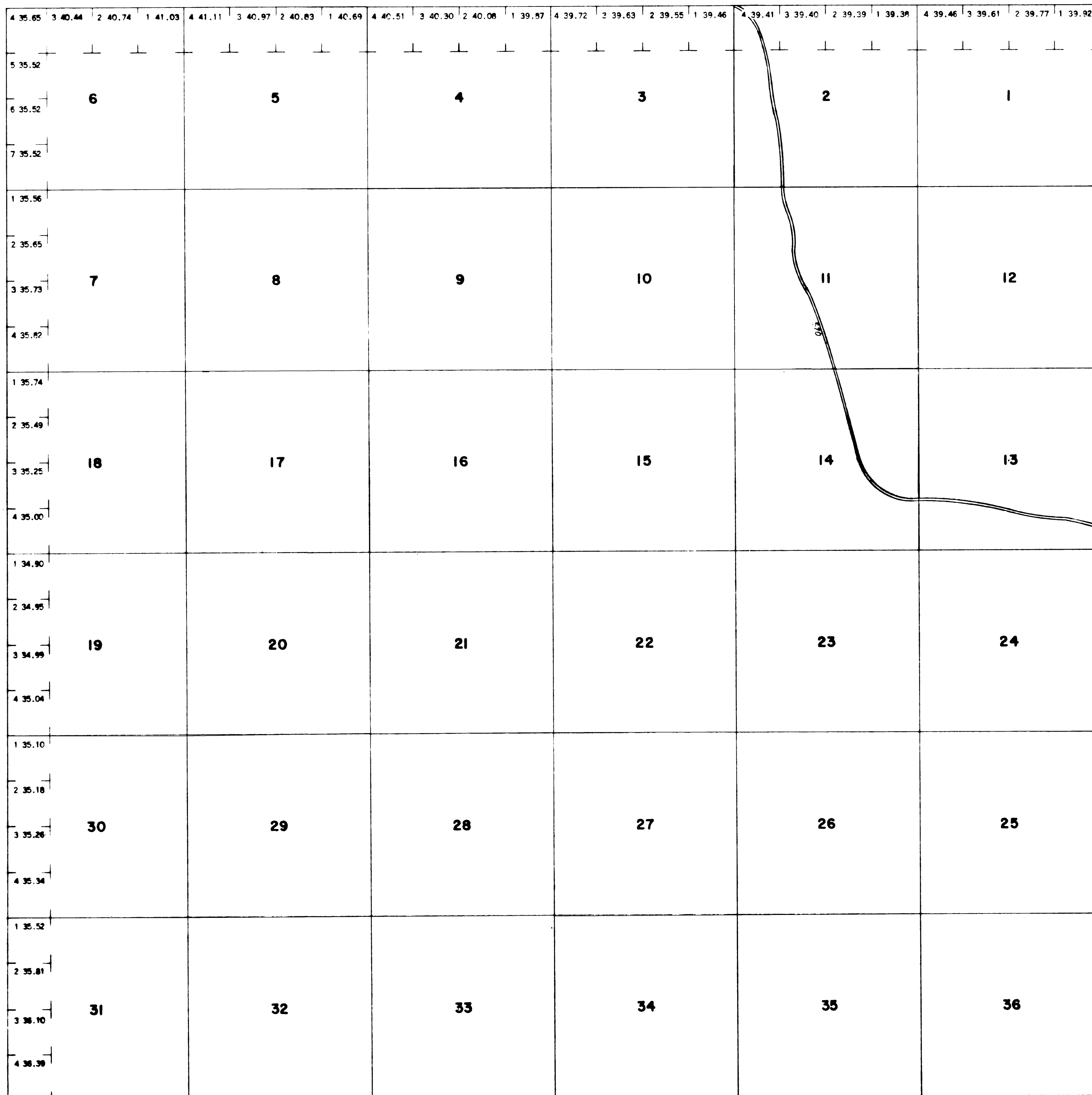

### WARNING STATEMENT

This plot is the Bureau's representation of the Record of Title and should be used only as a graphic display of the township survey data. Records hereon do not reflect title changes which may have been effected by the lateral movements of rivers or other bodies of water. Refer to the cadastral surveys for official survey information.