

UNSURVEYED TOWNSHIP 13 SOUTH RANGE 62 EAST OF THE MOUNT DIABLO MERIDIAN, NEVADA

PROTRACTION DIAGRAM NO 27

CLARK COUNTY
LAS VEGAS GR DIST

STATUS OF PUBLIC DOMAIN
LAND AND MINERAL TITLES

MT/USE PLAT

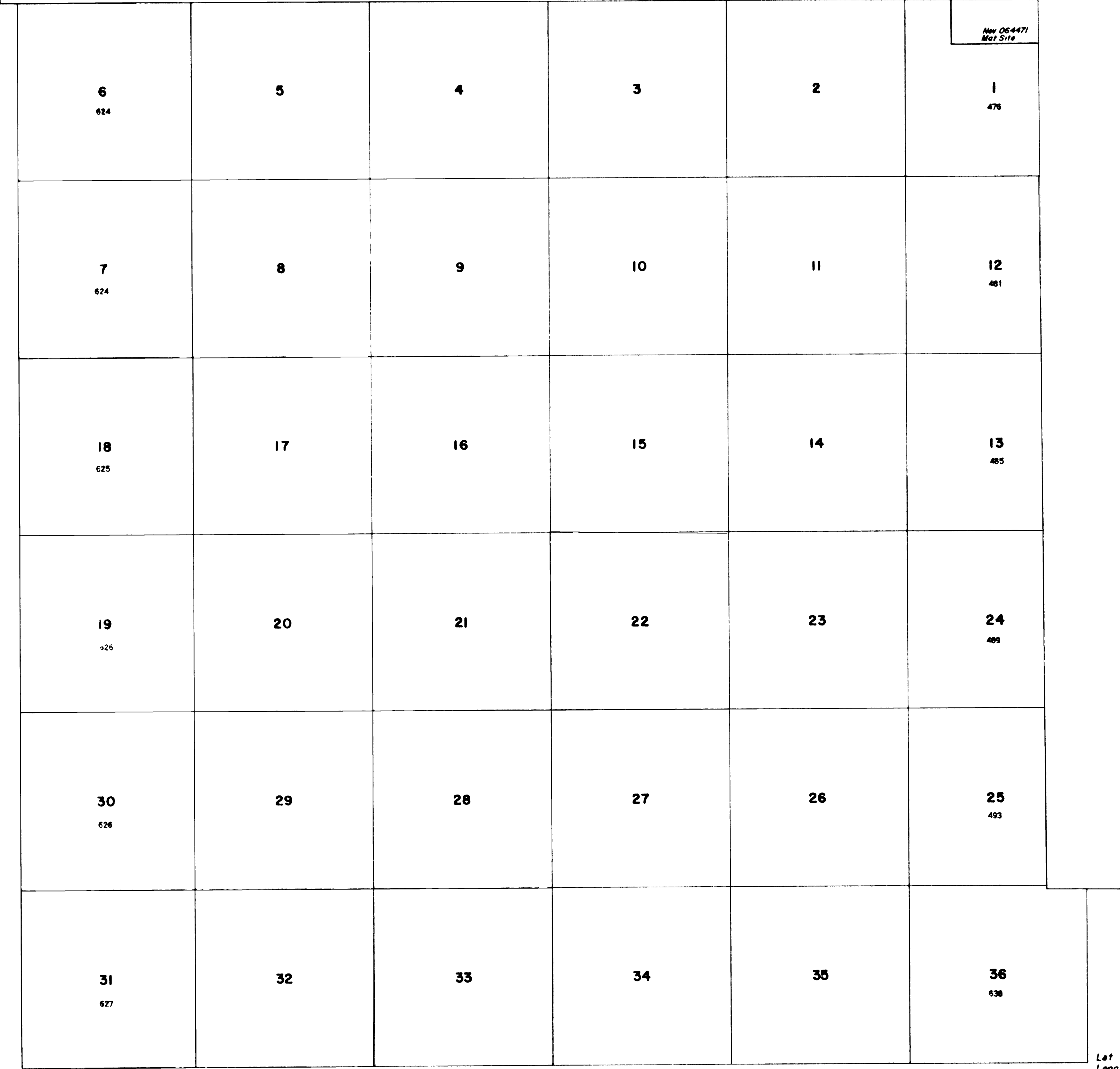

INDEX TO SEGREGATED TRACTS				
RESURVEY		ORIGINAL SURVEY		
TRACT NO	T	R	SEC	SUBDIVISION

FOR ORDERS EFFECTING DISPOSAL OR USE OF
UNIDENTIFIED LANDS WITHDRAWN FOR CLASSIFICATION,
MINERALS, WATER AND/OR OTHER PUBLIC PURPOSES,
REFER TO INDEX OF MISCELLANEOUS DOCUMENTS.

All Tp included in Wdl Desert National Wildlife R
PLO 4079 8/26/1966; N 219

N 54955, PLO 7828, Wdl Desert Natl Wildlife R Ext:
Entire Tp

CURRENT TO	BY
5/16/90	
11/11/91	BC
4-2-92	OK
10-26-93	OK
8/25/94	OK
7/2/13	MS
2/7/2019	ART

Lat 36°45'09 07"N
Long 114°58'34 77"W

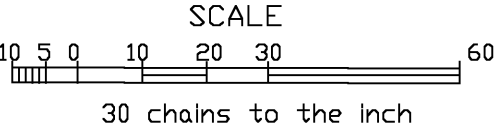

WARNING STATEMENT
This plat is the Bureau's representation of the Record of Title and should be used only as a graphic display of the township survey data. Records hereon do not reflect title changes which may have been effected by the lateral movements of rivers or other bodies of water. Refer to the cadastral surveys for official survey information.

PLAT TYPE

N-050
T-13-S-
R-62-E