

UNSURVEYED TOWNSHIP 13 SOUTH RANGE 49 EAST OF THE MOUNT DIABLO MERIDIAN, NEVADA

PROTRACTION DIAGRAM NO 44

NYE COUNTY

STATUS OF PUBLIC DOMAIN
LAND AND MINERAL TITLES

MT PLAT

INDEX TO SEGREGATED TRACTS				
RESURVEY	ORIGINAL SURVEY			
	TRACT NO	T	R	SEC

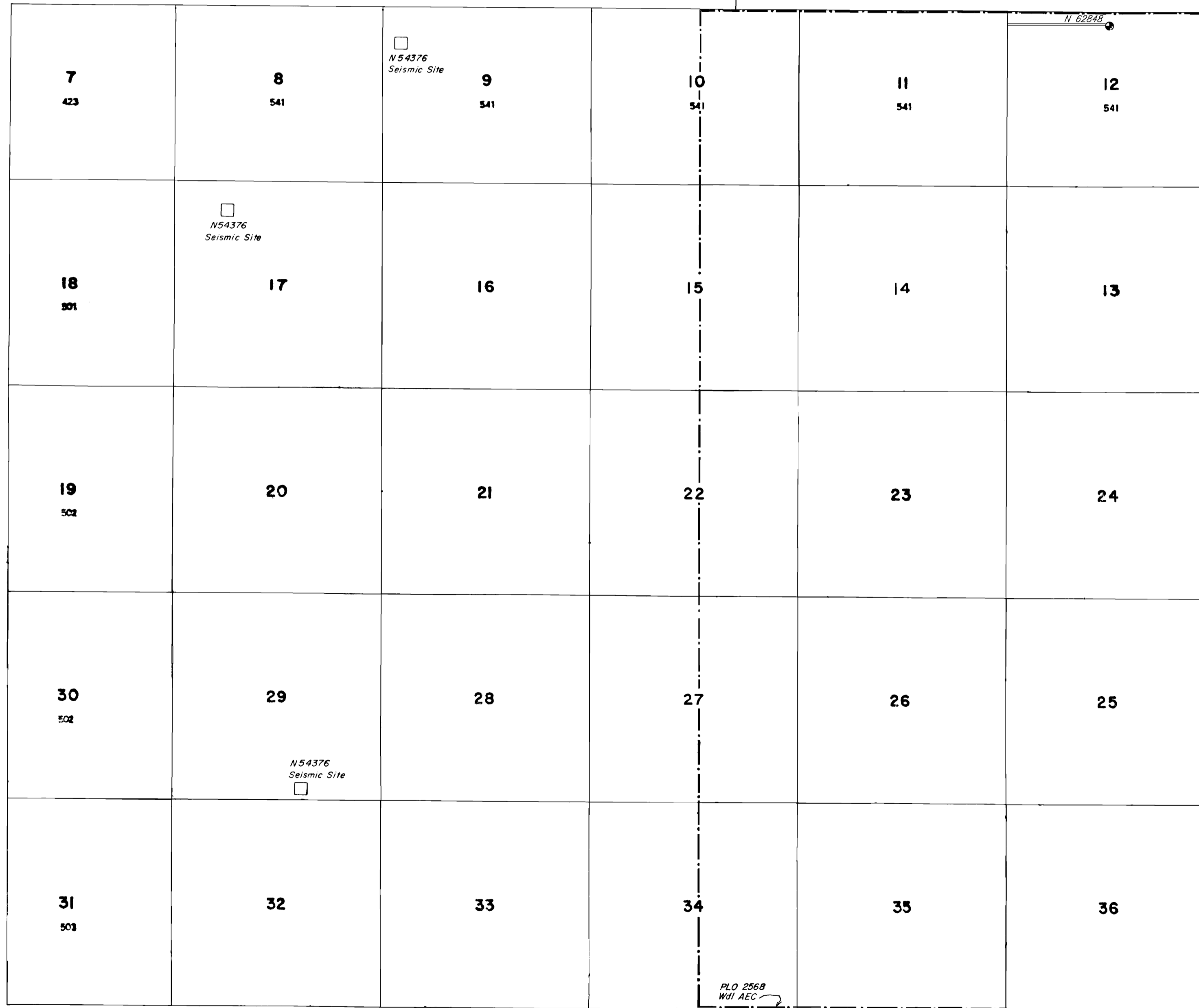

FOR ORDERS EFFECTING DISPOSAL OR USE OF UNIDENTIFIED LANDS WITHDRAWN FOR CLASSIFICATION, MINERALS, WATER AND/OR OTHER PUBLIC PURPOSES, REFER TO INDEX OF MISCELLANEOUS DOCUMENTS.

- N 47748 R/W Res Site Characterization Studies
- Secs: 7-9
 - Sec 10: W1/2
 - Sec 15: W1/2
 - Secs: 16-21
 - Sec 22: W1/2
 - Sec 27: W1/2
 - Secs: 28-33
 - Sec 34: W1/2

CURRENT TO	BY
9/27/02	MS
4/30/2004	SL
1/20/06	MS
5/25/07	S.L.L.
1/14/08	MS
6/17/09	MS
10/7/09	MS
3/15/11	MS
8/20/13	MS
1/19/16	MS

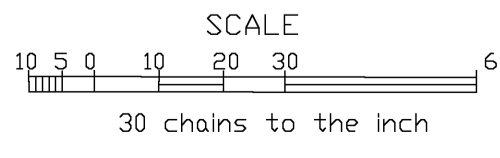

WARNING STATEMENT
This plat is the Bureau's representation of the Record of Title and should be used only as a graphic display of the township survey data. Records hereon do not reflect title changes which may have been effected by lateral movements of rivers or other bodies of water. Refer to the cadastral surveys for official survey information.

N-050
T. 13S
R. 49E