

UNSURVEYED TOWNSHIP 12½ SOUTH RANGE 62 EAST OF THE MOUNT DIABLO MERIDIAN, NEVADA

PROTRACTION DIAGRAM NO 27

CLARK COUNTY

STATUS OF PUBLIC DOMAIN
LAND AND MINERAL TITLES

MT/USE PLAT

INDEX TO SEGREGATED TRACTS				
RESURVEY	ORIGINAL SURVEY			
TRACT NO	T	R	SEC	SUBDIVISION

FOR ORDERS EFFECTING DISPOSAL OR USE OF
UNIDENTIFIED LANDS WITHDRAWN FOR CLASSIFICATION,
MINERALS, WATER AND/OR OTHER PUBLIC PURPOSES,
REFER TO INDEX OF MISCELLANEOUS DOCUMENTS.

All Tp included in Wdl Desert Natl Wildlife R
PLO 4079 8/26/1966; N 219

N 54955, PLO 7828, Wdl Desert Natl Wildlife R Ext:
Entire Tp

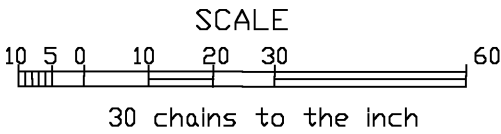
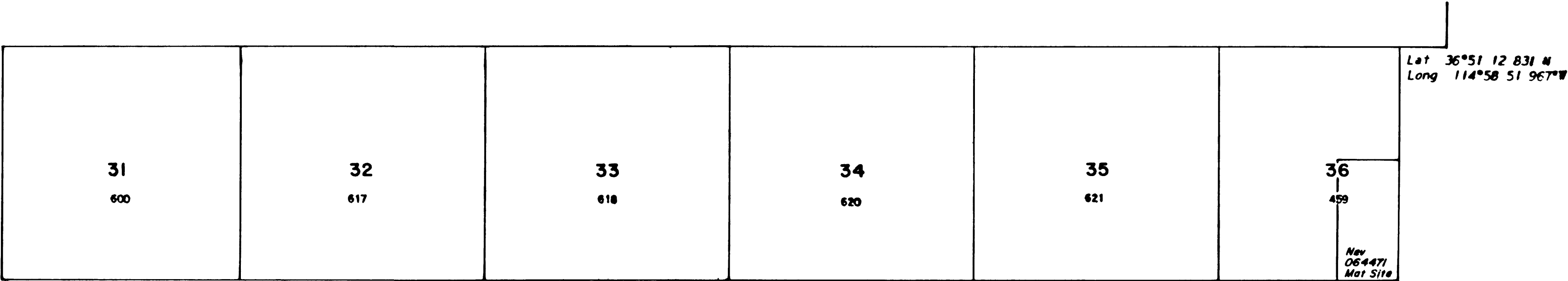

WARNING STATEMENT
This plat is the Bureau's representation of the Record of Title and should be used only as a graphic display of the township survey data. Records hereon do not reflect title changes which may have been effected by the lateral movements of rivers or other bodies of water. Refer to the cadastral surveys for official survey information.

CURRENT TO	BY	CURRENT TO	BY
7/2/2013	MS		
2/7/2019	ART		

PLAT TYPE	

N - 050

T 12 ½ S
R 62 E