

UNSURVEYED TOWNSHIP 12 SOUTH RANGE 55 EAST OF THE MOUNT DIABLO MERIDIAN, NEVADA

PROTRACTION DIAGRAM NO 67

STATUS OF PUBLIC DOMAIN
LAND AND MINERAL TITLES

MT PLAT

INDEX TO SEGREGATED TRACTS				
RESURVEY	ORIGINAL SURVEY			
TRACT NO	T	R	SEC	SUBDIVISION

FOR ORDERS EFFECTING DISPOSAL OR USE OF
UNIDENTIFIED LANDS WITHDRAWN FOR CLASSIFICATION,
MINERALS, WATER AND/OR OTHER PUBLIC PURPOSES,
REFER TO INDEX OF MISCELLANEOUS DOCUMENTS.

N 16095, PL 106-65 amdt by PL 116-283 Mil Wdl
DAF/NTTR: Entire Tp

Primary Admin Juris FWS per Memorandum
of Understanding 04/22/1999.
All Lds lying W/1 Lincoln & Clark County;

CURRENT TO	BY	CURRENT TO	BY
07/25/2017	RLL		
12/14/2018	ART		
10/01/2021	LAJ		

T. 12 S
R. 55 E
N-050

PLAT TYPE

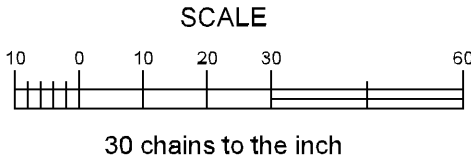
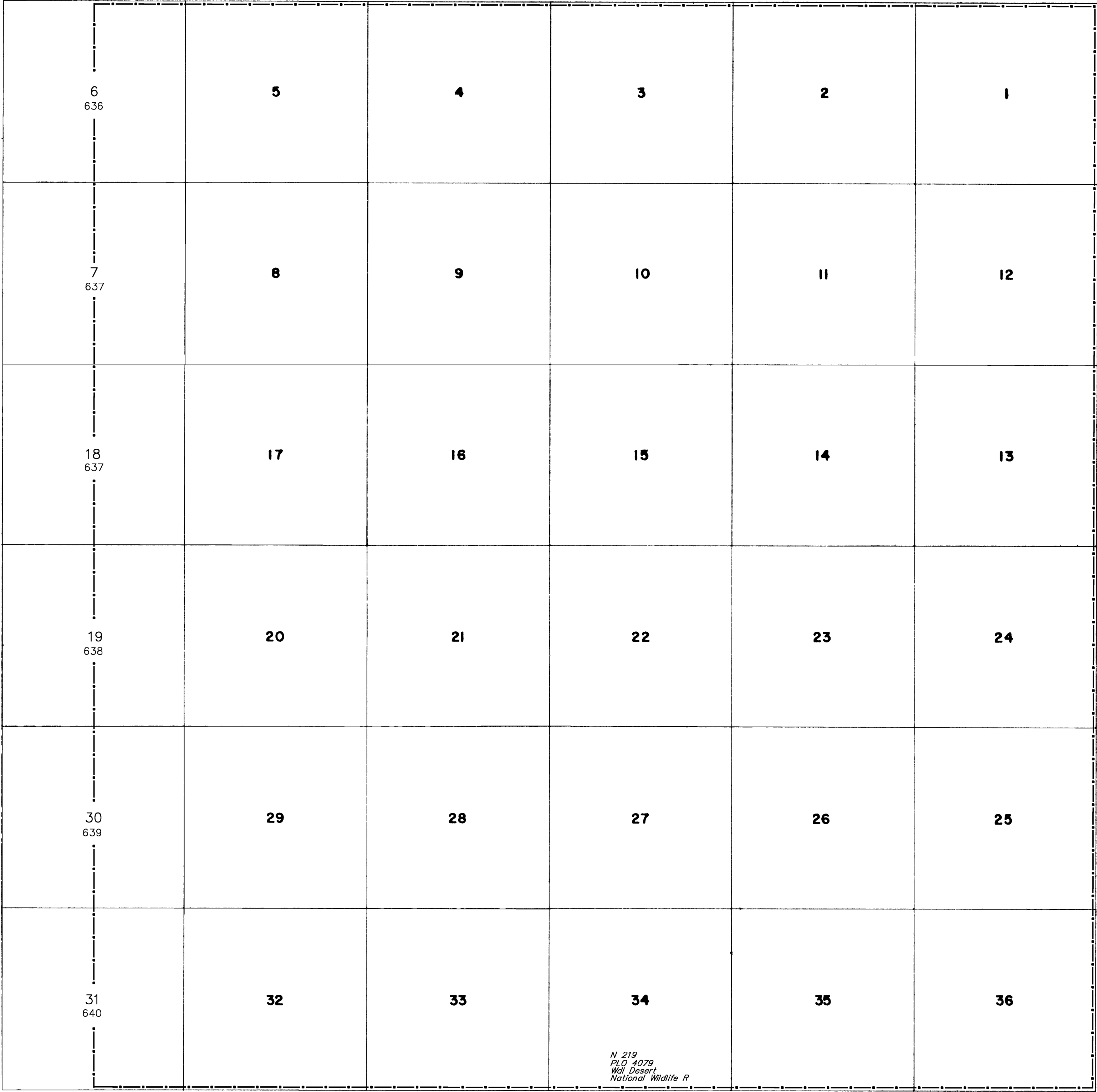

WARNING STATEMENT

This plat is the Bureau's representation of the Record of Title and should be used only as a graphic display of the township survey data. Records hereon do not reflect title changes which may have been effected by the lateral movements of rivers or other bodies of water. Refer to the cadastral surveys for official survey information.