

# UNSURVEYED TOWNSHIP 9 SOUTH RANGE 58 EAST OF THE MOUNT DIABLO MERIDIAN, NEVADA

PROTRACTION DIAGRAM NO 74

LINCOLN COUNTY

STATUS OF PUBLIC DOMAIN  
LAND AND MINERAL TITLES

## MT PLAT

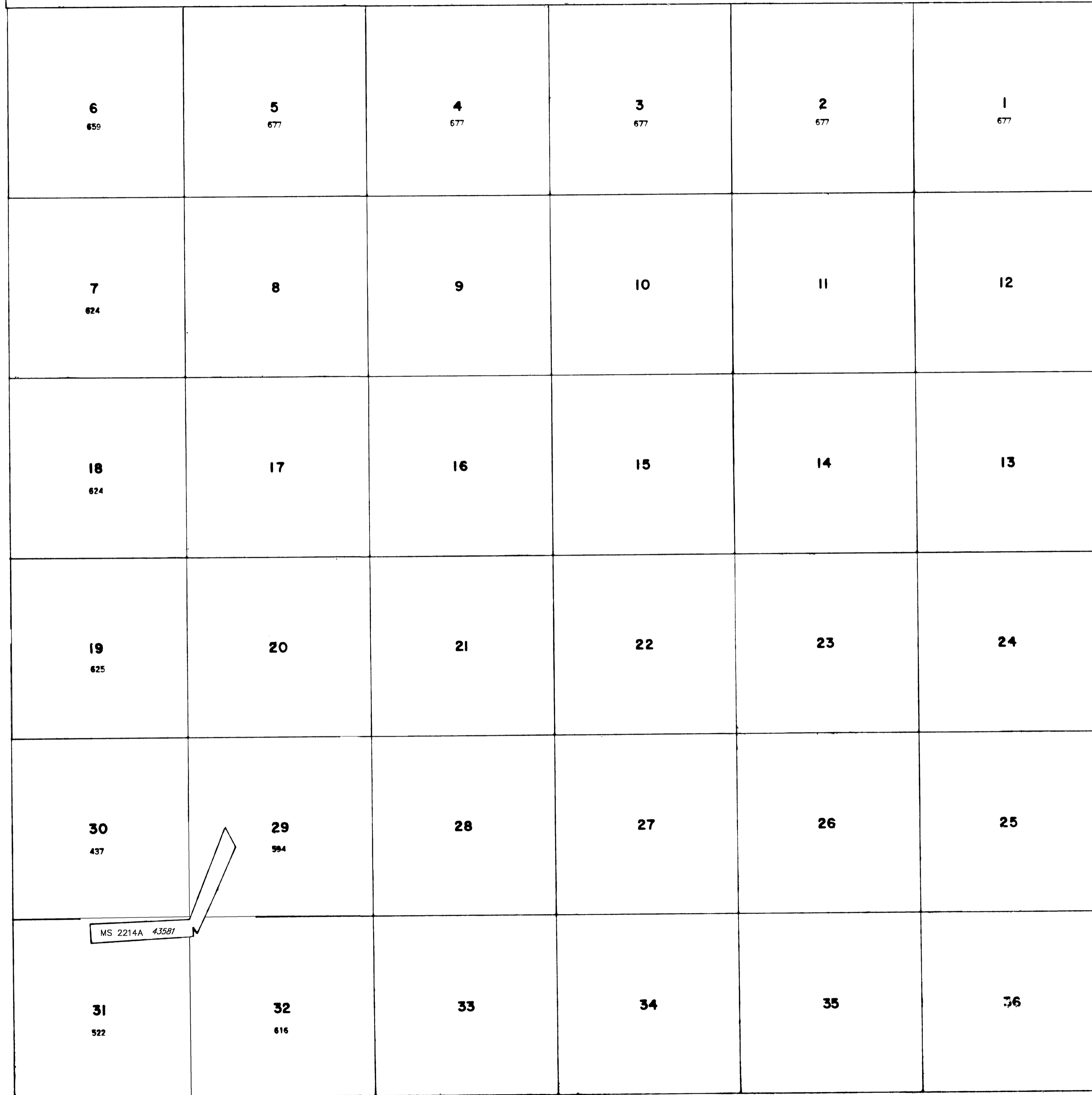

INDEX TO SEGREGATED TRACTS				
RESURVEY	ORIGINAL SURVEY			
TRACT NO	T	R	SEC	SUBDIVISION

FOR ORDERS EFFECTING DISPOSAL OR USE OF UNIDENTIFIED LANDS WITHDRAWN FOR CLASSIFICATION, MINERALS, WATER AND/OR OTHER PUBLIC PURPOSES. REFER TO INDEX OF MISCELLANEOUS DOCUMENTS.

N 219, PLO 4079, Wdl Desert National Wildlife R: Entire Tp

N 16095, PL 106-65, Amdt by PL 116-283 Mil Wdl DAF/NTR: Entire Tp.

Primary Admin Juris FWS per Memorandum of Understanding 04/22/1999.

- Sec 1-12: Entire Section;
- Sec 13: N1/2, SE1/4;
- Sec 14: N1/2, SW1/4;
- Sec 15-22: Entire Section;
- Sec 23: W1/2, SE1/4;
- Sec 24: NE1/4, S1/2;
- Sec 25-36: Entire Section.

Primary Admin Juris DAF per Memorandum of Understanding 04/22/1999.

- Sec 13: SW1/4;
- Sec 14: SE1/4;
- Sec 23: NE1/4;
- Sec 24: NW1/4.

CURRENT TO	BY	CURRENT TO	BY
09/26/2017	RLL		
1/29/2019	ART		
06/01/2021	LAJ		
10/12/2021	LAJ		

PLAT TYPE
-----------

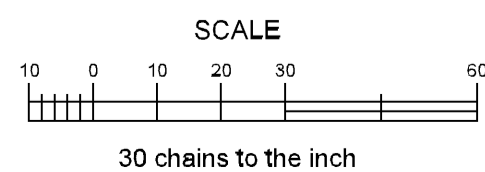

WARNING STATEMENT

This plat is the Bureau's representation of the Record of Title and should be used only as a graphic display of the township survey data. Records hereon do not reflect title changes which may have been effected by the lateral movements of rivers or other bodies of water. Refer to the cadastral surveys for official survey information.