

UNSURVEYED TOWNSHIP 6 SOUTH RANGE 71 EAST OF THE MOUNT DIABLO MERIDIAN, NEVADA

PROTRACTION DIAGRAM NO 227

LINCOLN COUNTY  
ELY GR DIST

STATUS OF PUBLIC DOMAIN  
LAND AND MINERAL TITLES

MT PLAT

INDEX TO SEGREGATED TRACTS				
RESURVEY		ORIGINAL SURVEY		
TRACT NO	T	R	SEC	SUBDIVISION

FOR ORDERS EFFECTING DISPOSAL OR USE OF  
UNIDENTIFIED LANDS WITHDRAWN FOR CLASSIFICATION,  
MINERALS, WATER AND/OR OTHER PUBLIC PURPOSES,  
REFER TO INDEX OF MISCELLANEOUS DOCUMENTS.

RI 36 Hydrologic Study Sec 6

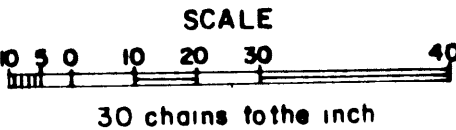
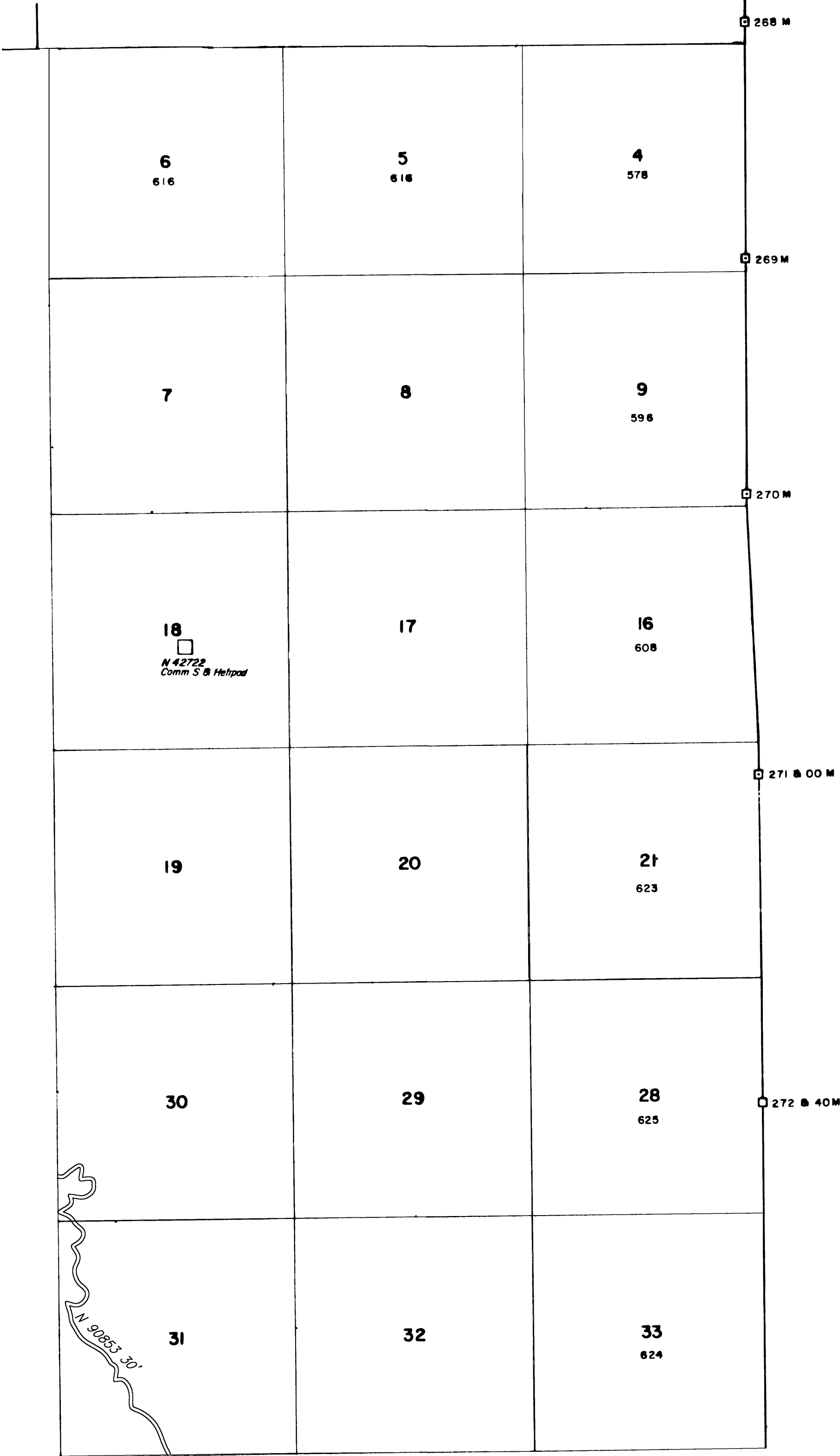

WARNING STATEMENT

This plat is the Bureau's representation of the Record of Title and should be used only as a graphic display of the township survey data. Records hereon do not reflect title changes which may have been effected by lateral movements of rivers or other bodies of water. Refer to the cadastral surveys for official survey information.

CURRENT TO	BY
9-29-80	
2-25-83	
3-25-83	
4-27-87	BC
6-5-87	BC
6-11-87	BC
5-7-92	LK
11/9/16	DMG

N-050  
T 6S  
R. 71E