

**LIDA TOWNSITE PLAT**  
**Sec 36 Sheet 2**

[illegible]

FOR ORDERS EFFECTING DISPOSAL OR USE OF  
UNIDENTIFIED LANDS WITHDRAWN FOR CLASSIFICATION,  
MINERALS, WATER AND/OR OTHER PUBLIC PURPOSES,  
REFER TO INDEX OF MISCELLANEOUS DOCUMENTS.

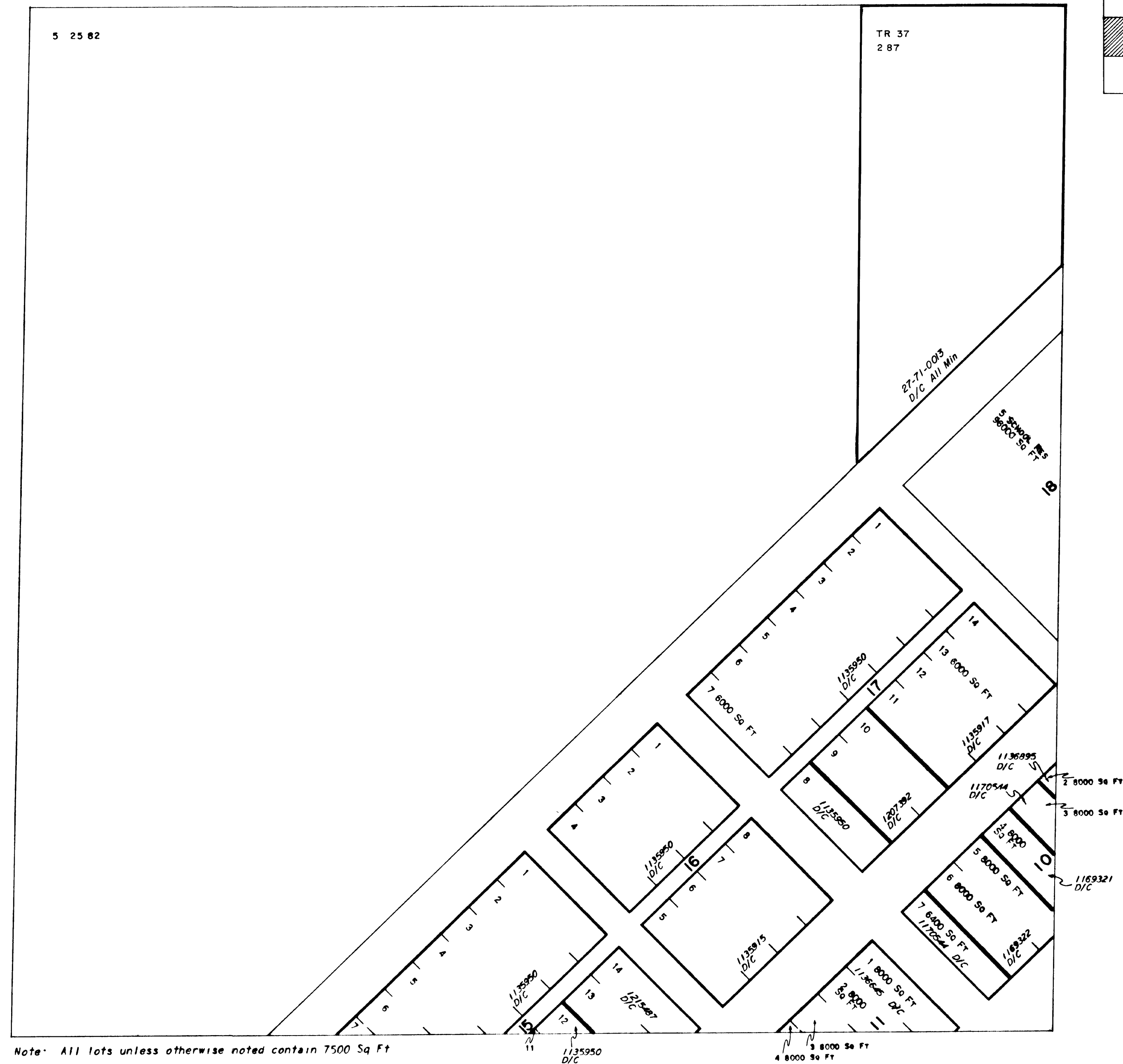

Note: All lots unless otherwise noted contain 7500 Sq Ft

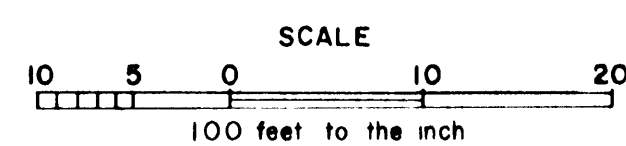

**WARNING STATEMENT**  
This plat is the Bureau's Record of Title, and should be used only as a graphic display of the township survey data. Records hereon do not reflect title changes which may have been effected by lateral movements of rivers or other bodies of water. Refer to the cadastral surveys for official survey information.

[illegible]

N-060  
LIDA Tns  
SHEET 2  
T. 5 S.  
R. 40 E.