

PROTRACTION DIAGRAM NO. 245

N.P.D. "BEANS"
Lat. 37° 53' 38.633" N.
Long. 118° 18' 59.977" W.

MT PLAT

[illegible]

FOR ORDERS EFFECTING DISPOSAL OR USE OF UNIDENTIFIED LANDS WITHDRAWN FOR CLASSIFICATION, MINERALS, WATER AND/OR OTHER PUBLIC PURPOSES, REFER TO INDEX OF MISCELLANEOUS DOCUMENTS.

The following actions affect this Tp:
All Tp included in #dl Inyo N.F. CO 899 7/1/1998

R-03658 Determination P.L.167(Act of Cong 7/23/1955)
complete 8/21/1963. All N.F. surface management by USFS

New 061193 Determination P.L. 167 (Act of Cong 7/23/1955)
complete 12/4/1964 . All N.F surface management by USFS

NOTE: Full jurisdiction of lands between Von Schmidt and
U.S.C. & G.S. Line accepted by Nev., Ltr Aug 30, 1968
File 1813.1-4 a

[illegible]

N-060
T. I S
R. 33 E

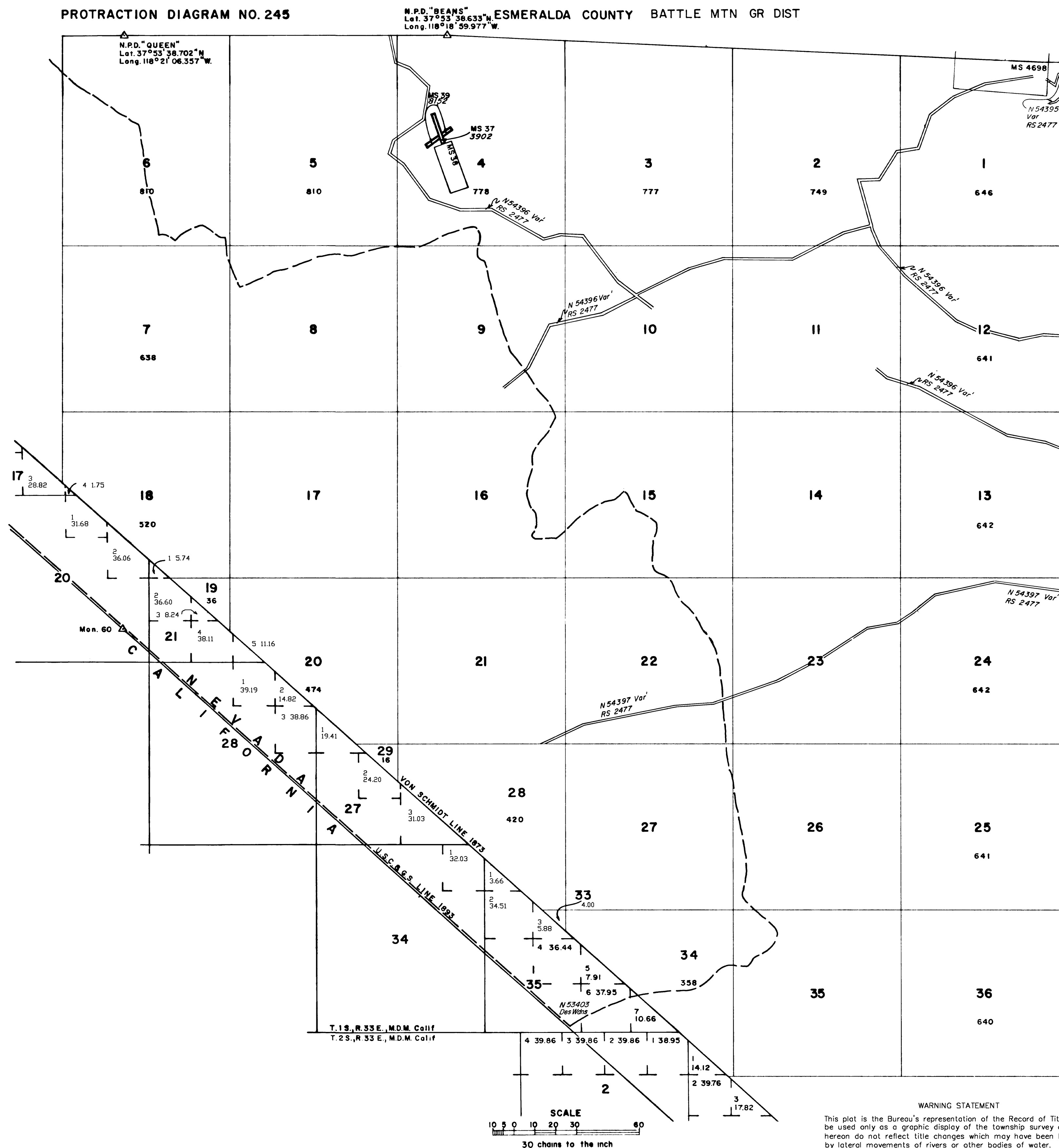

Lat. 37°48'11.76"N.
Long. 118°14'56.75"W.

WARNING STATEMENT

This plot is the Bureau's representation of the Record of Title and should be used only as a graphic display of the township survey data. Records hereon do not reflect title changes which may have been effected by lateral movements of rivers or other bodies of water. Refer to the cadastral surveys for official survey information.