

UNSURVEYED TOWNSHIP 47 NORTH RANGE 25 EAST OF THE MOUNT DIABLO MERIDIAN, NEVADA

PROTRACTION DIAGRAM NO. 302

HUMBOLDT COUNTY
SUSANVILLE GR DIST

STATUS OF PUBLIC DOMAIN
LAND AND MINERAL TITLES

MT PLAT

| INDEX TO SEGREGATED TRACTS | | | | |
|----------------------------|---|-----------------|-----|-------------|
| RESURVEY | | ORIGINAL SURVEY | | |
| TRACT NO | T | R | SEC | SUBDIVISION |
| | | | | |
| | | | | |
| | | | | |
| | | | | |
| | | | | |
| | | | | |
| | | | | |
| | | | | |
| | | | | |
| | | | | |

FOR ORDERS EFFECTING DISPOSAL OR USE OF UNIDENTIFIED LANDS WITHDRAWN FOR CLASSIFICATION, MINERALS, WATER AND/OR OTHER PUBLIC PURPOSES, REFER TO INDEX OF MISCELLANEOUS DOCUMENTS.

All TP included in Surface Wdl Charles Sheldon Antelope R EO 7522 12/12/1936; Chgd to Sheldon National Wildlife Refuge PLO 5634 5/3/1978

O R E G O N

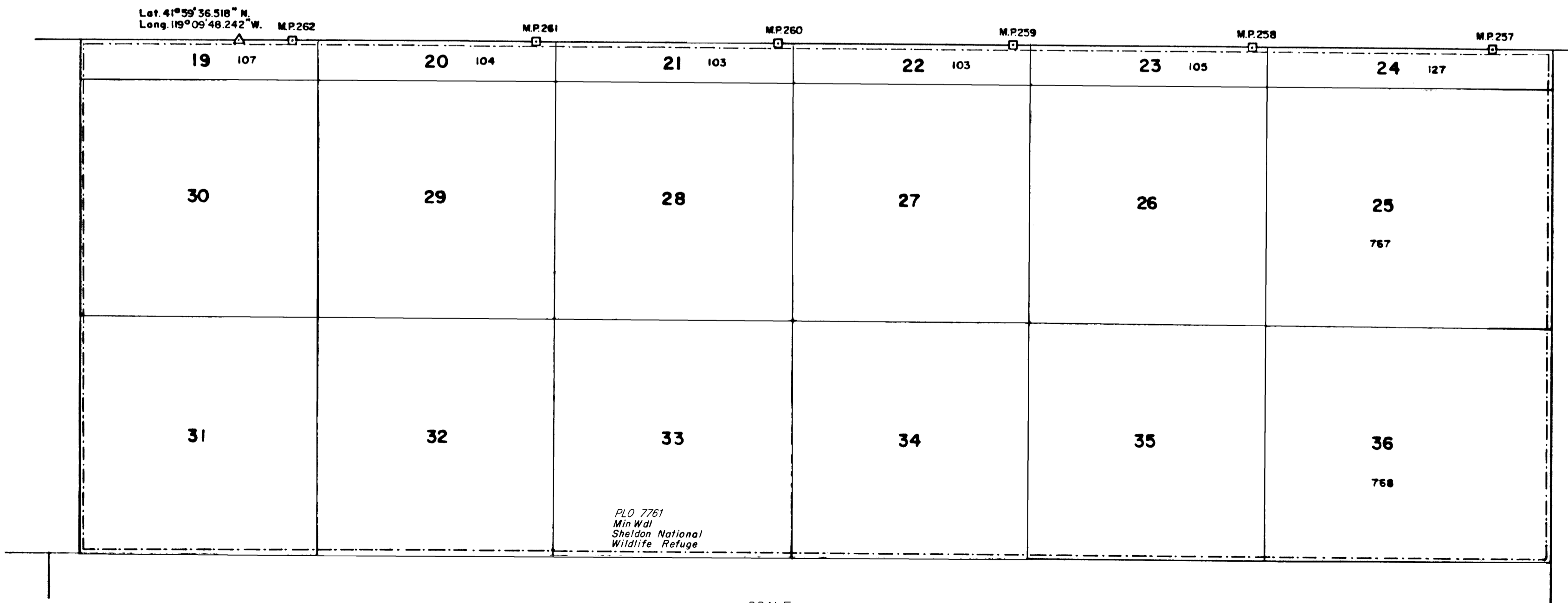

| CURRENT TO | BY |
|------------|-----|
| 7/21/92 | LK |
| 5/11/11 | MS |
| 2/20/20 | ART |
| | |
| | |
| | |
| | |
| | |

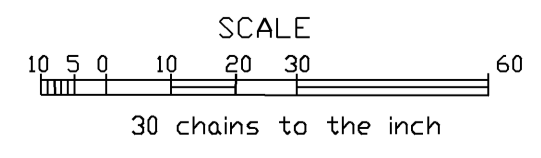

WARNING STATEMENT
This plat is the Bureau's representation of the Record of Title and should be used only as a graphic display of the township survey data. Records hereon do not reflect title changes which may have been effected by the lateral movements of rivers or other bodies of water. Refer to the cadastral surveys for official survey information.

C 020
T. 47 N
R. 25 E