

# TOWNSHIP 46 NORTH RANGE 55 EAST OF THE MOUNT DIABLO MERIDIAN, NEVADA

ELKO COUNTY

STATUS OF PUBLIC DOMAIN  
LAND AND MINERAL TITLES

## MT/USE PLAT

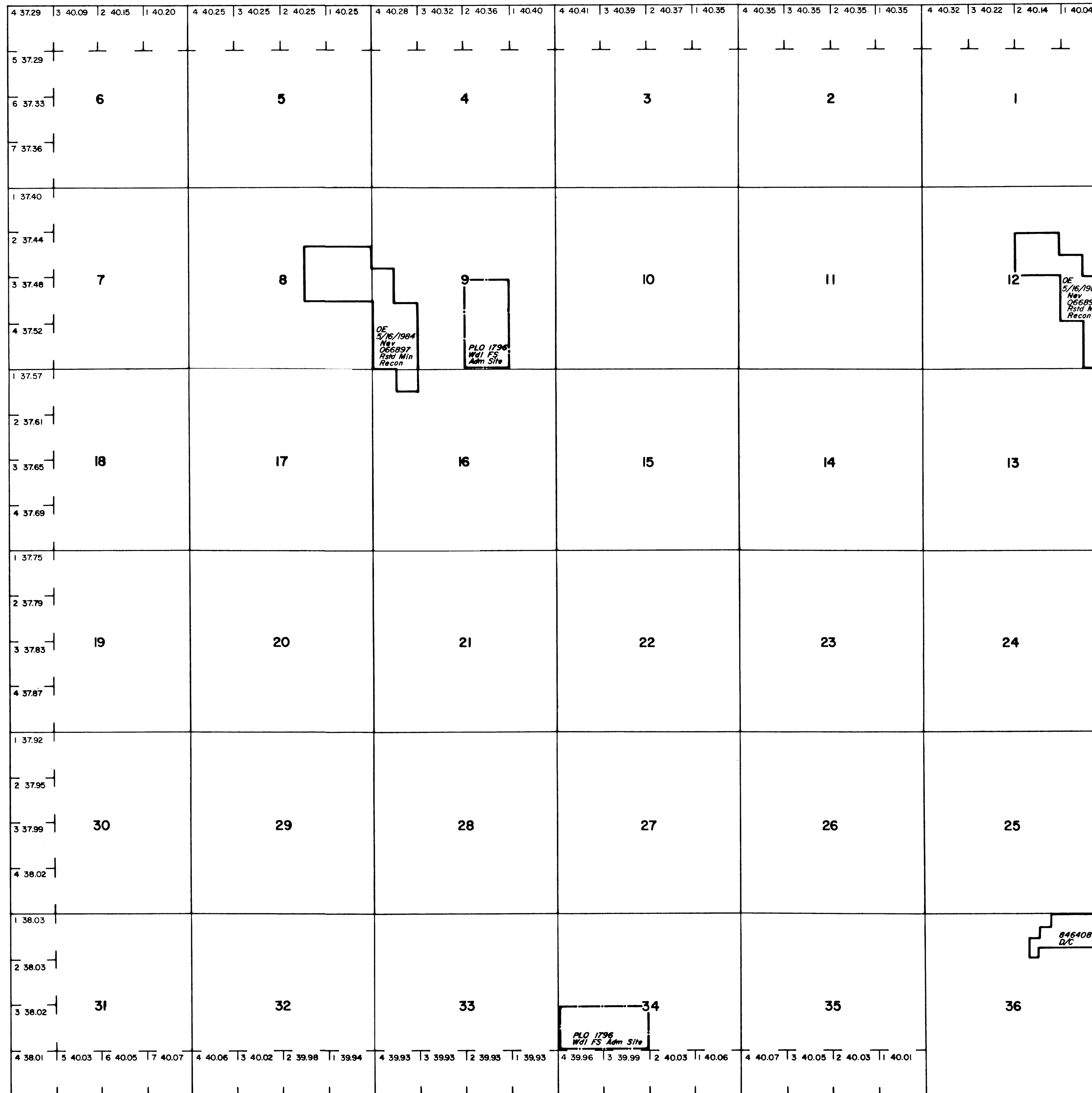

INDEX TO SEGREGATED TRACTS				
RESURVEY	ORIGINAL SURVEY			
TRACT NO	T	R	SEC	SUBDIVISION

FOR ORDERS EFFECTING DISPOSAL OR USE OF UNIDENTIFIED LANDS WITHDRAWN FOR CLASSIFICATION, MINERALS, WATER AND/OR OTHER PUBLIC PURPOSES. REFER TO INDEX OF MISCELLANEOUS DOCUMENTS.

All Tp included in WdI Humboldt N.F. Proc. 832 1/20/1909.  
All Tp included in Nev 050713 Determination P.L. 167 (Act of Cong. 7/23/1955) complete 2/21/1961. All N.F. surface management by USFS except, mining claims in Secs: 7, 8 & 18 - North Star, North Star 1, North Star 2 & North Star 5.  
Pat. 4387 on MS 37A & 37B unable to accurately locate in this Tp.

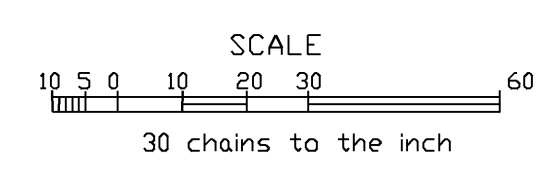

WARNING STATEMENT  
This plat is the Bureau's representation of the Record of Title and should be used only as a graphic display of the township survey data. Records hereon do not reflect title changes which may have been effected by the lateral movements of rivers or other bodies of water. Refer to the cadastral surveys for official survey information.

Lat. 41°49'29" N.  
Long. 115°42'20" W.

CURRENT TO	BY
12/9/15	MS
06/24/2020	LAJ

N OIO  
T. 46.N...  
R. 55.E....