

PARTIALLY SURVEYED TOWNSHIP 46 NORTH RANGE 53 EAST OF THE MOUNT DIABLO MERIDIAN, NEVADA

PROTRACTION DIAGRAM No. 134

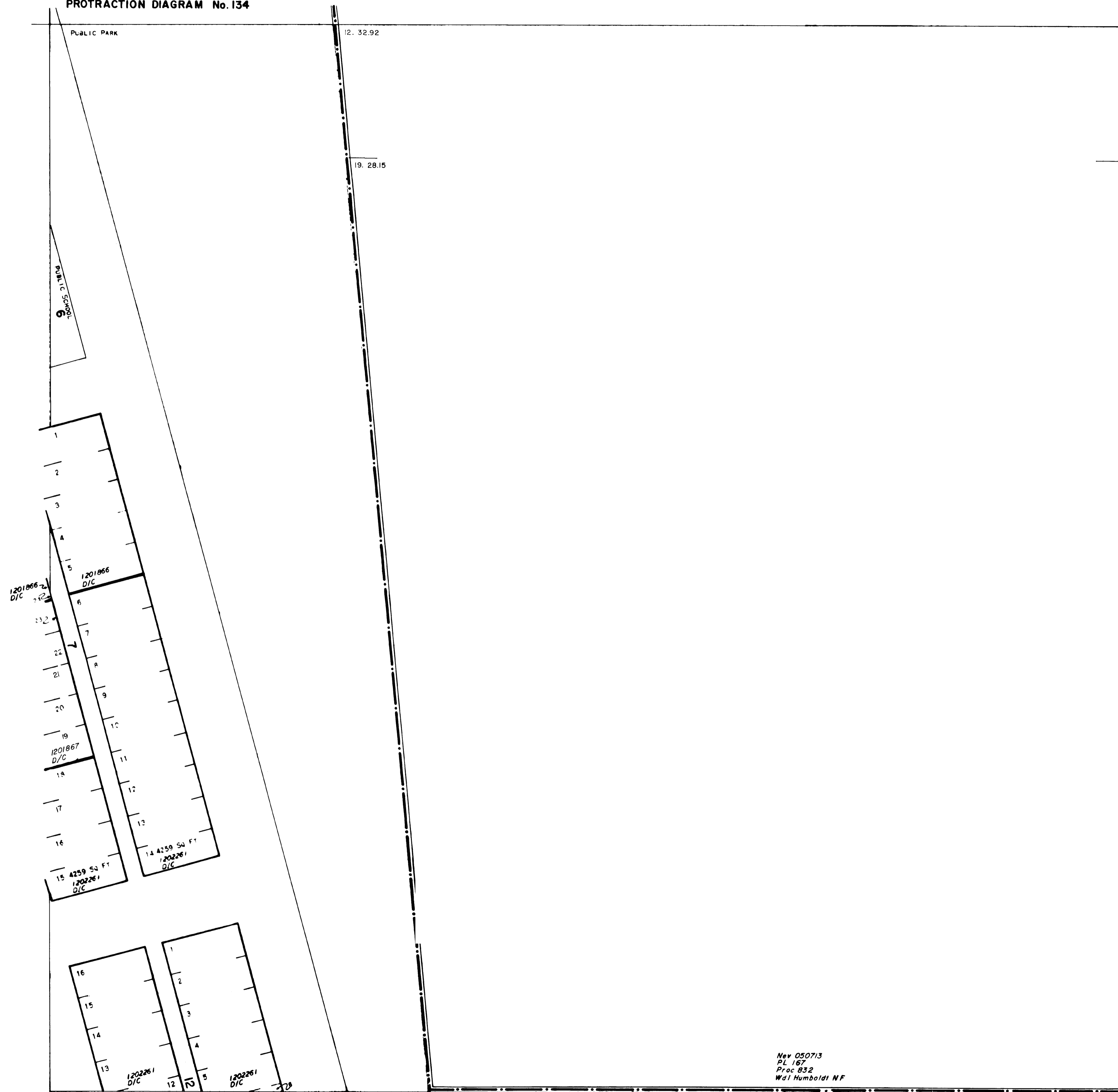

STATUS OF PUBLIC DOMAIN  
LAND AND MINERAL TITLES

EAST MOUNTAIN CITY  
TOWNSITE PLAT  
Sec 36 SE 1/4 SE 1/4

INDEX

NW 1/4 SE 1/4	NE 1/4 SE 1/4
SW 1/4 SE 1/4	SE 1/4 SE 1/4
SUPPL	PLAT

T 46 N 53 E  
R 45 N 53 E

**FOR ORDERS EFFECTIVE DISPOSAL OR USE OF  
UNDETERMINED LANDS WITHDRAWN FOR CLASSIFICATION,  
MINERALS, WATER AND/OR OTHER PUBLIC PURPOSES,  
REFER TO INDEX OF MISCELLANEOUS DOCUMENTS.**

*Nev 050713 Determination P.L. 167 (Act of Cong. 7/23/1955)  
complete 2/21/1961. All N.F. surface management by USFS*

DEPENDENT RESURVEY AND SURVEY 7/15/1991

CURRENT TO	BY
5-20-92	AD BC

N-010  
T.46N  
R.53E

Note: All lots unless otherwise noted  
contain 4200 Sq Ft



WARNING STATEMENT

This plot is the Bureau's representation of the Record of Title and should be used only as a graphic display of the township survey data. Records hereon do not reflect title changes which may have been effected by lateral movements of rivers or other bodies of water. Refer to the cadastral surveys for official survey information.

Nev 050713  
PL 167  
Proc 832  
Wd Humboldt NF