

TOWNSHIP 46 NORTH RANGE 45 EAST OF THE MOUNT DIABLO MERIDIAN, NEVADA

ELKO COUNTY
ELKO GR DIST

STATUS OF PUBLIC DOMAIN
LAND AND MINERAL TITLES

OG PLAT

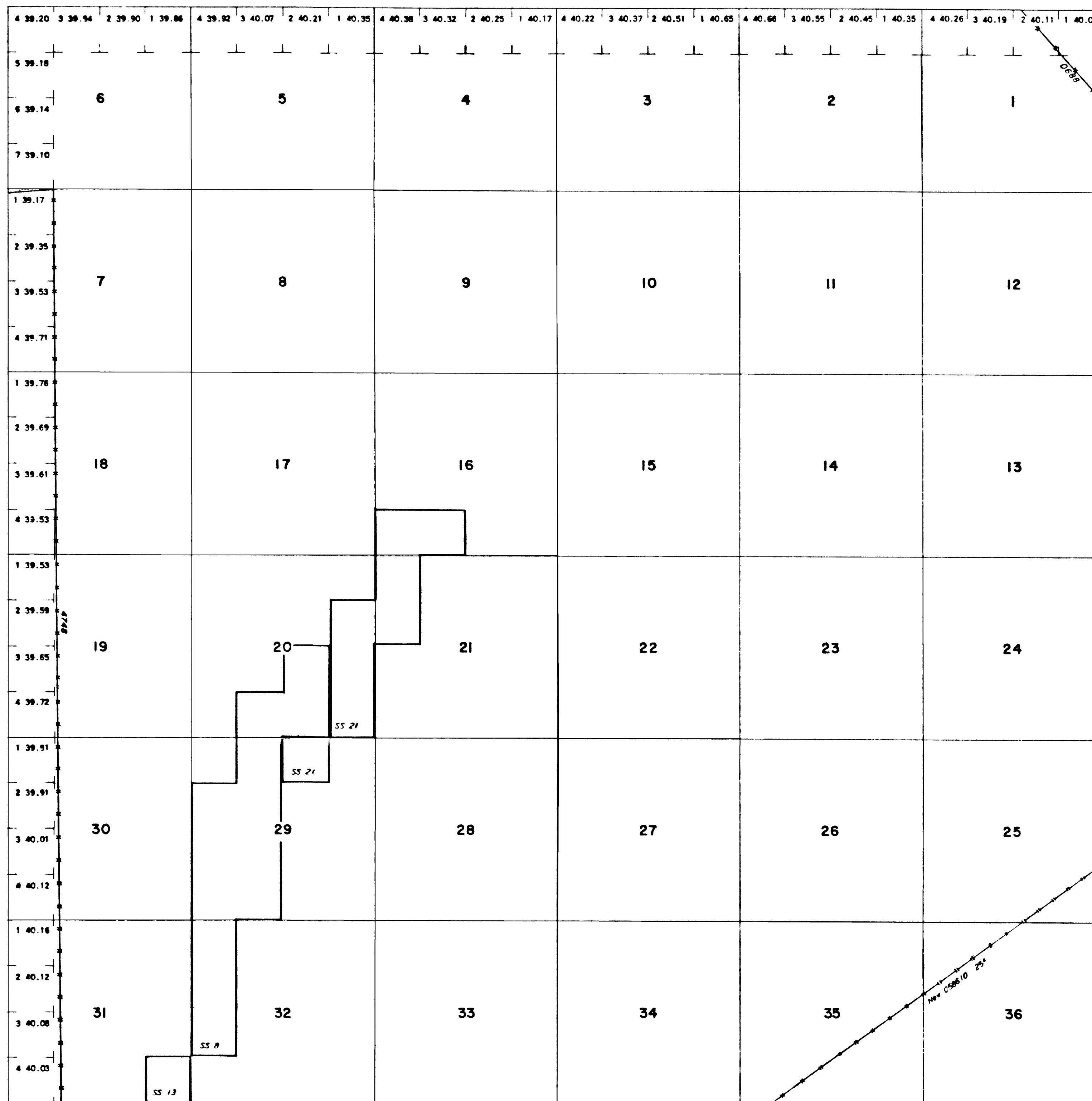

INDEX TO SEGREGATED TRACTS				
RESURVEY	ORIGINAL SURVEY			
TRACT NO	T	R	SEC	SUBDIVISION

FOR ORDERS EFFECTING DISPOSAL OR USE OF UNIDENTIFIED LANDS WITHDRAWN FOR CLASSIFICATION, MINERALS, WATER AND/OR OTHER PUBLIC PURPOSES, REFER TO INDEX OF MISCELLANEOUS DOCUMENTS.

N. 93666 Withdrawal Act effective 9/24/2015 segregates all public and national forest system lands from location and entry under the U.S. mining laws in this township and range. Segregation expires 9/23/2017.

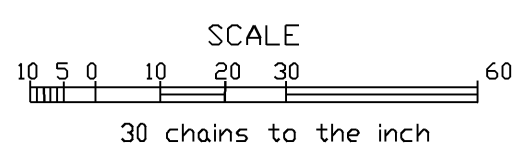

WARNING STATEMENT

This plat is the Bureau's representation of the Record of Title and should be used only as a graphic display of the township survey data. Records hereon do not reflect title changes which may have been effected by lateral movements of rivers or other bodies of water. Refer to the cadastral surveys for official survey information.

CURRENT TO	BY
1-25-06	
5/10/06	
1-1-06	
11/16/06	
12/16/15	MS

N-010
T. 46 N.
R. 45 E.