

# TOWNSHIP 46 NORTH RANGE 41 EAST OF THE MOUNT DIABLO MERIDIAN, NEVADA

HUMBOLDT COUNTY  
WINNEMUCCA GR DIST

STATUS OF PUBLIC DOMAIN  
LAND AND MINERAL TITLES

## MT PLAT

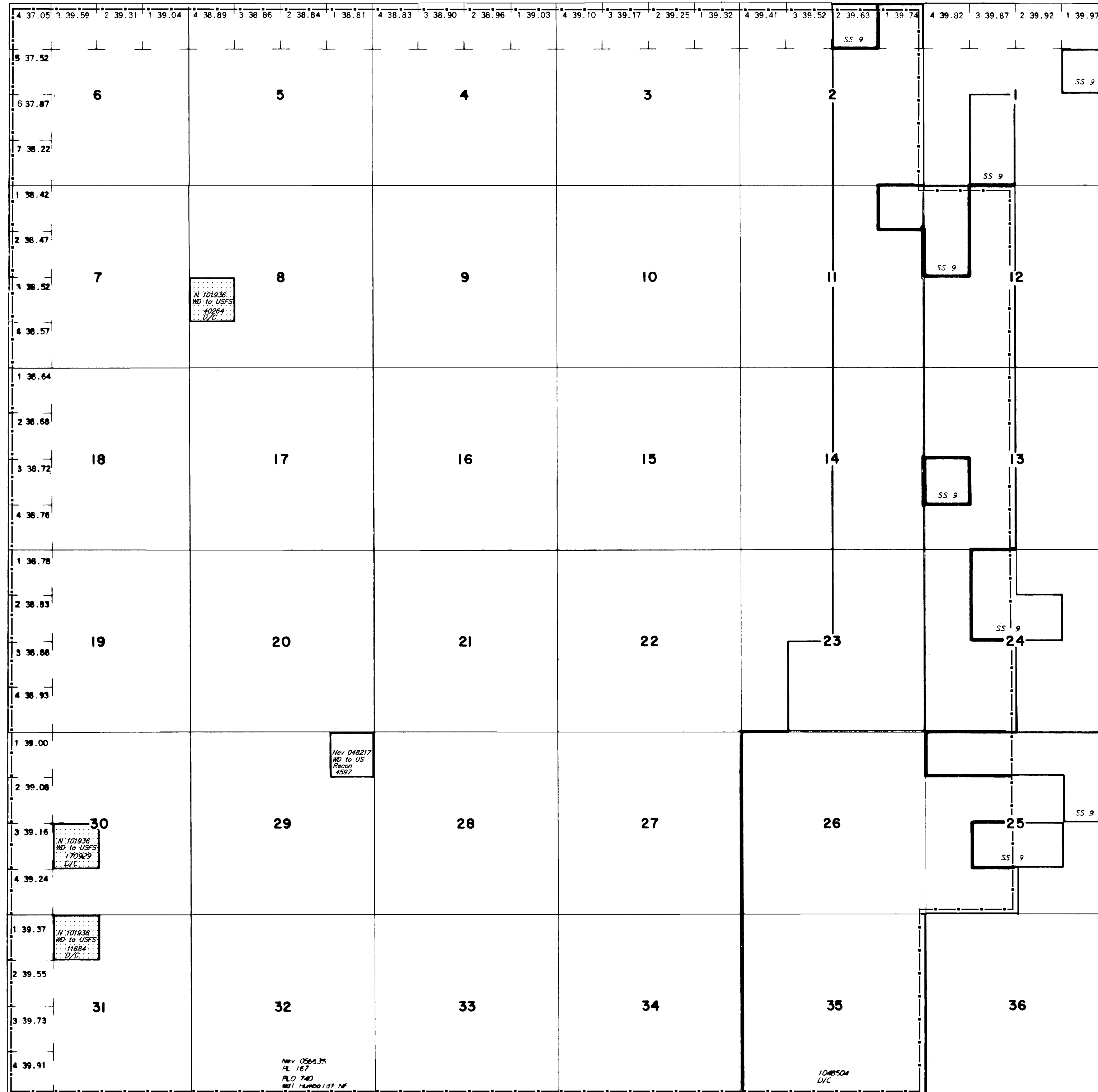

INDEX TO SEGREGATED TRACTS				
RESURVEY	ORIGINAL SURVEY			
TRACT NO	T	R	SEC	SUBDIVISION

FOR ORDERS EFFECTING DISPOSAL OR USE OF UNIDENTIFIED LANDS WITHDRAWN FOR CLASSIFICATION, MINERALS, WATER AND/OR OTHER PUBLIC PURPOSES, REFER TO INDEX OF MISCELLANEOUS DOCUMENTS.

Nev 056635 Determination P.L. 167 (Act of Cong 7/23/1955) complete 4/30/1962. All N.F. surface management by USFS

CURRENT TO	BY	CURRENT TO	BY
06/26/2023	DMG		

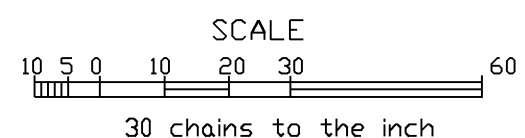

WARNING STATEMENT  
This plat is the Bureau's representation of the Record of Title and should be used only as a graphic display of the township survey data. Records hereon do not reflect title changes which may have been effected by the lateral movements of rivers or other bodies of water. Refer to the cadastral surveys for official survey information.

PLAT TYPE