

TOWNSHIP 46 NORTH RANGE 20 EAST OF THE MOUNT DIABLO MERIDIAN, NEVADA

WASHOE COUNTY
SUSANVILLE GR DIST

STATUS OF PUBLIC DOMAIN
LAND AND MINERAL TITLES

MT/USE PLAT

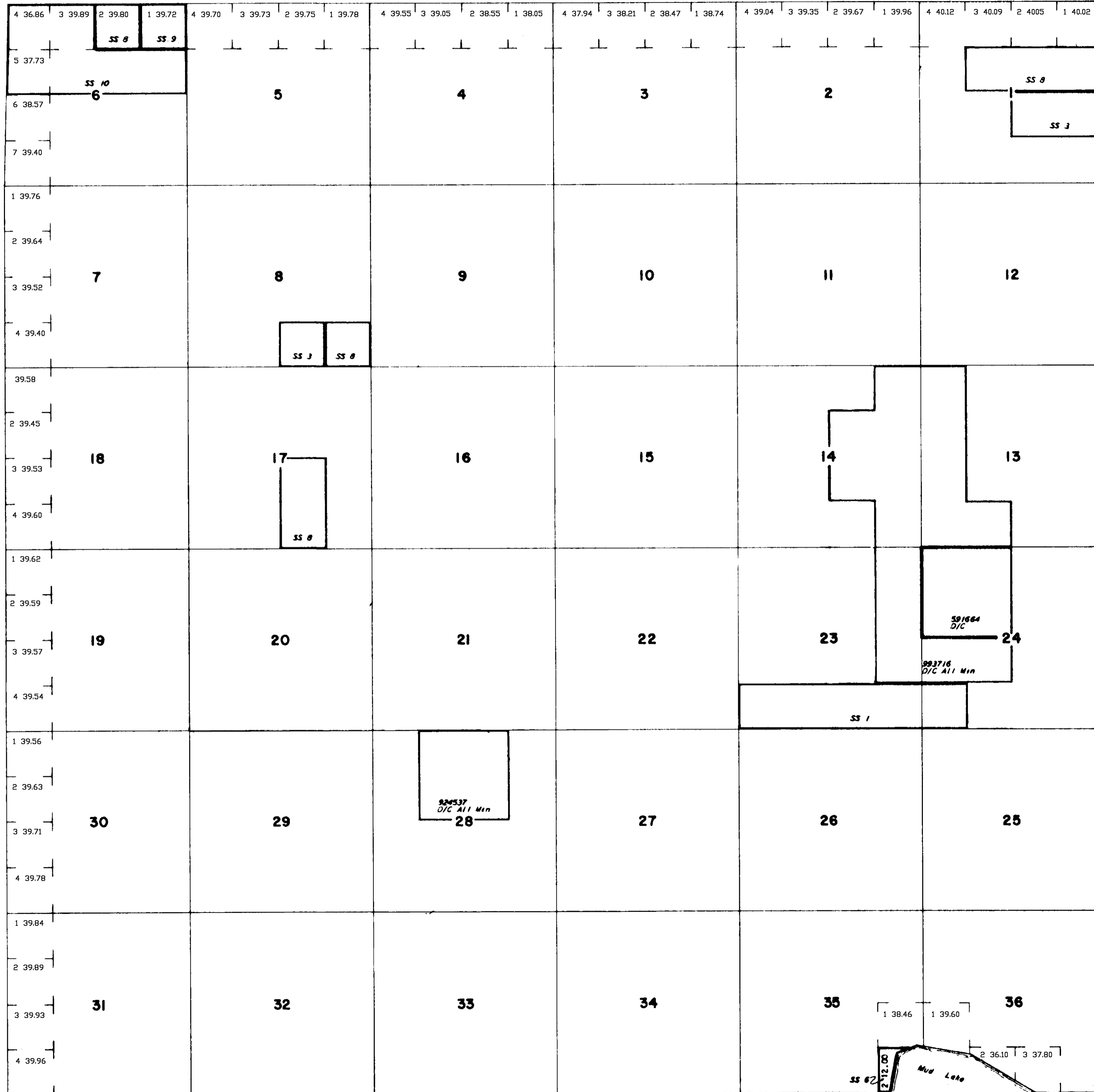

INDEX TO SEGREGATED TRACTS				
RESURVEY		ORIGINAL SURVEY		
TRACT NO	T	R	SEC	SUBDIVISION

FOR ORDERS EFFECTING DISPOSAL OR USE OF UNIDENTIFIED LANDS WITHDRAWN FOR CLASSIFICATION, MINERALS, WATER AND/OR OTHER PUBLIC PURPOSES, REFER TO INDEX OF MISCELLANEOUS DOCUMENTS.

*WSA (see Dist/50 maps for exact Bdrs)
Sec: 1, 2, 11-13, 24, 25, 36*

CURRENT TO	BY
11/18/15	MS
06/18/2020	LAJ

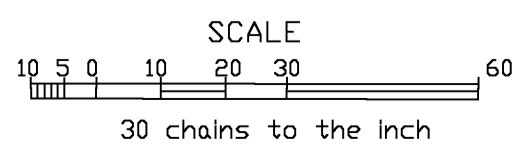

WARNING STATEMENT
This plat is the Bureau's representation of the Record of Title and should be used only as a graphic display of the township survey data. Records hereon do not reflect title changes which may have been effected by the lateral movements of rivers or other bodies of water. Refer to the cadastral surveys for official survey information.

C-020
T. 46N.
R. 20E