

TOWNSHIP 45 NORTH RANGE 23 EAST OF THE MOUNT DIABLO MERIDIAN, NEVADA

WASHOE COUNTY
SUSANVILLE GR DIST

STATUS OF PUBLIC DOMAIN
LAND AND MINERAL TITLES
AND ACQUIRED LANDS

MT PLAT

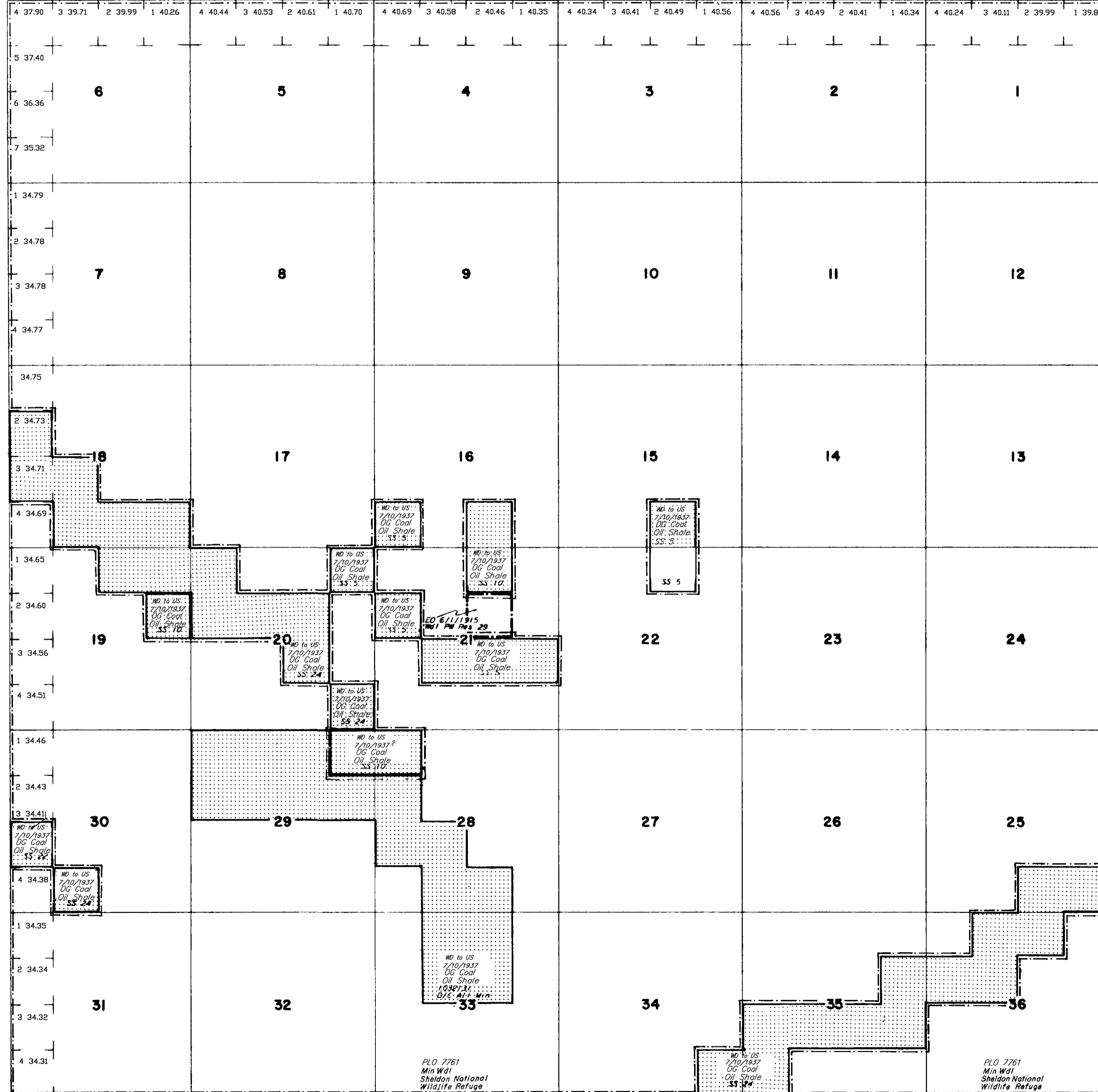

INDEX TO SEGREGATED TRACTS				
RESURVEY	ORIGINAL SURVEY			
	TRACT NO	T	R	SEC

FOR ORDERS EFFECTING DISPOSAL OR USE OF UNIDENTIFIED LANDS WITHDRAWN FOR CLASSIFICATION, MINERALS, WATER AND/OR OTHER PUBLIC PURPOSES, REFER TO INDEX OF MISCELLANEOUS DOCUMENTS.

All TP included in Surface Wdl Charles Sheldon Antelope R
EO 1522 12/12/1936, Chgd to Sheldon National Wildlife
Refuge P.L.O. 5634 5/3/1978

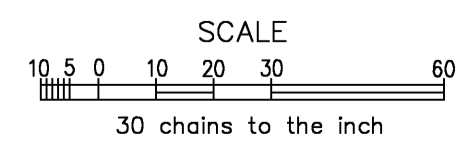

WARNING STATEMENT
This plat is the Bureau's representation of the Record of Title and should be used only as a graphic display of the township survey data. Records hereon do not reflect title changes which may have been effected by the lateral movements of rivers or other bodies of water. Refer to the cadastral surveys for official survey information.

CURRENT TO	BY
2/19/20	ART
12/23/09	MS
5/11/11	MS
7/30/13	MS

C-020
T. 45 N.
R. 23 E.