

TOWNSHIP 45 NORTH RANGE 21 EAST OF THE MOUNT DIABLO MERIDIAN, NEVADA

WASHOE COUNTY
SUSANVILLE GR DIST

STATUS OF PUBLIC DOMAIN
LAND AND MINERAL TITLES

MT PLAT

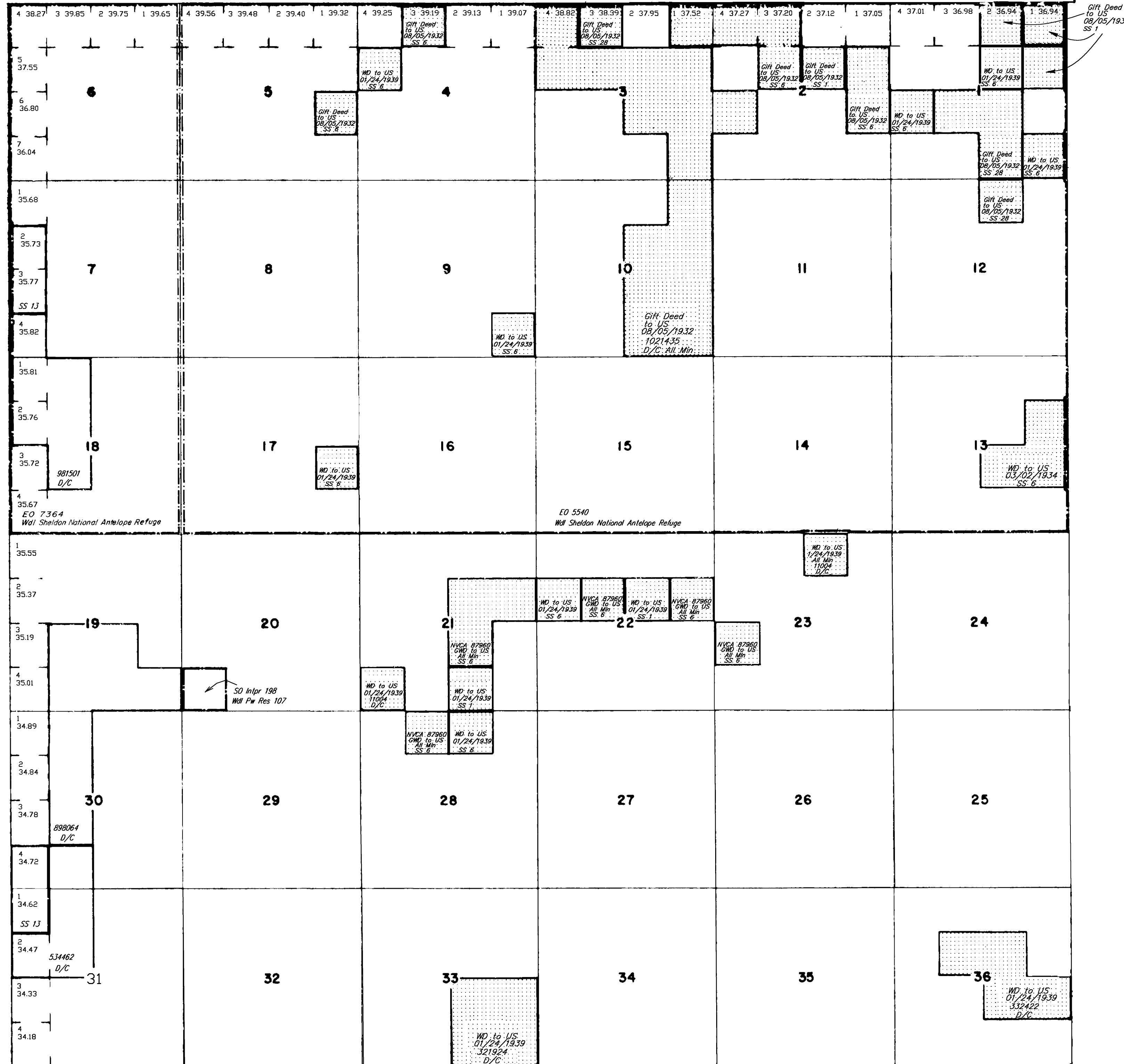

INDEX TO SEGREGATED TRACTS table with columns: RESURVEY, ORIGINAL SURVEY, TRACT NO, T, R, SEC, SUBDIVISION.

FOR ORDERS EFFECTING DISPOSAL OR USE OF UNIDENTIFIED LANDS WITHDRAWN FOR CLASSIFICATION, MINERALS, WATER AND/OR OTHER PUBLIC PURPOSES, REFER TO INDEX OF MISCELLANEOUS DOCUMENTS.

Wd Sheldon National Wildlife Refuge PLO 5634
5/3/1978 affects Secs. 1-18, all

WSA (see Dist/50 maps for exact Bdrs)
Sec. 20-36

Table with columns: CURRENT TO, BY. Contains dates and names: 11/13/15 MS, 10/15/19 DMG, 06/18/2020 LAJ.

N-020
T. 45N
R. 21E

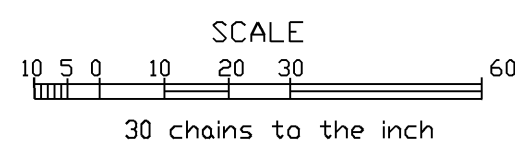

WARNING STATEMENT

This plat is the Bureau's representation of the Record of Title and should be used only as a graphic display of the township survey data. Records hereon do not reflect title changes which may have been effected by the lateral movements of rivers or other bodies of water. Refer to the cadastral surveys for official survey information.