

TOWNSHIP 41 NORTH RANGE 37 EAST OF THE MOUNT DIABLO MERIDIAN, NEVADA

STATUS OF PUBLIC DOMAIN
LAND AND MINERAL TITLES

**MTP
SUPPL Sec 21**

INDEX TO SEGREGATED TRACTS			
REF SURVEY	ORIGINAL SURVEY		
TRACT NO.	T	R	SEC

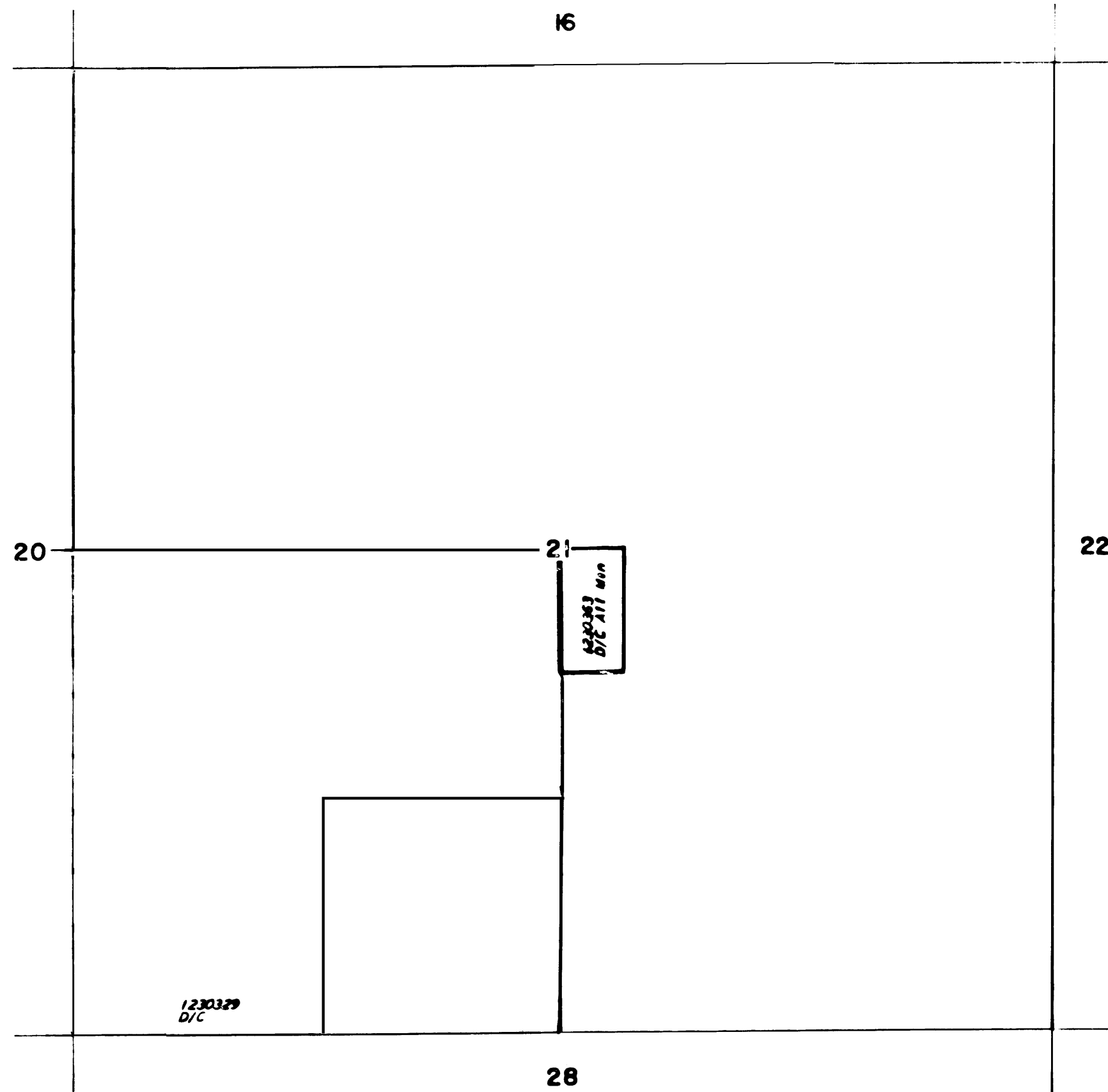

FOR ORDERS EFFECTING DISPOSAL OR USE OF
UNIDENTIFIED LANDS WITHDRAWN FOR CLASSIFICATION,
MINERALS, WATER AND/OR OTHER PUBLIC PURPOSES,
REFER TO INDEX OF MISCELLANEOUS DOCUMENTS.

BLM OCL Nonsuitable DLE affects:
Sec 21 NW 1/4, SE 1/4 SE 1/4;

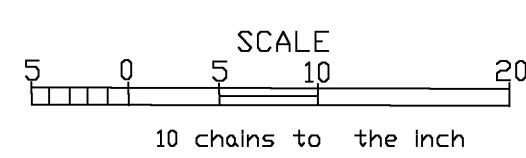

WARNING STATEMENT
This plot is the Bureau's Record of Title and should be used only
as a graphic display of the township survey data. Records hereon
do not reflect title changes which may have been effected
by lateral movements of rivers or other bodies of water. Refer
to the cadastral surveys for official survey information.

CURRENT TO	BY
8/5/03	MS
6/21/10	MS

N 020
MTP Suppl
Sec 21
T 41 N
R 37 E