

UNSURVEYED TOWNSHIP 40 NORTH RANGE 22 EAST OF THE MOUNT DIABLO MERIDIAN, NEVADA

PROTRACTION DIAGRAM NO.295

WASHOE COUNTY
SUSANVILLE GR DIST

STATUS OF PUBLIC DOMAIN
LAND AND MINERAL TITLES

OG PLAT

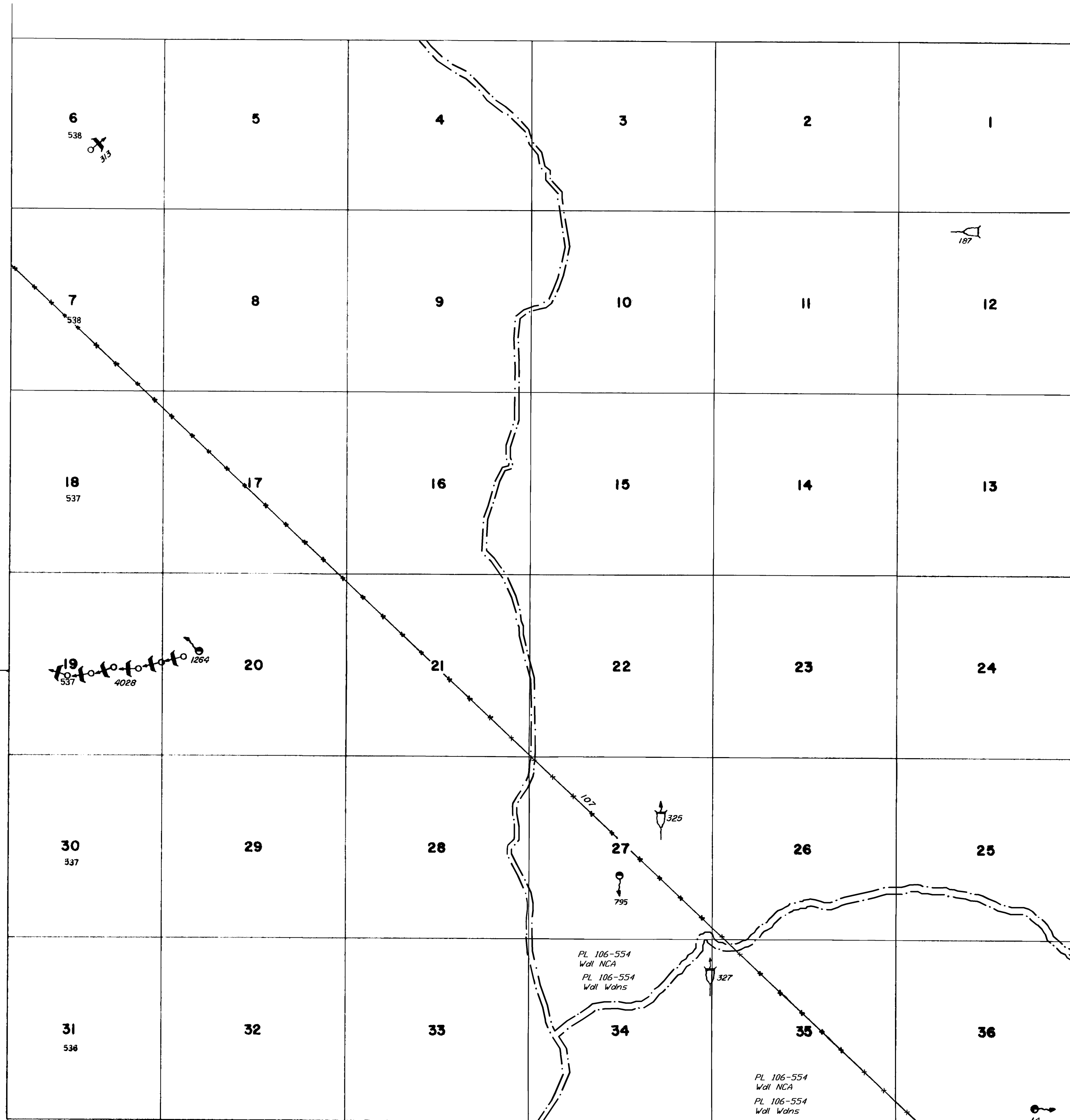

INDEX TO SEGREGATED TRACTS				
RESURVEY	ORIGINAL SURVEY			
	TRACT NO	T	R	SEC
				SUBDIVISION

FOR ORDERS EFFECTING DISPOSAL OR USE OF UNIDENTIFIED LANDS WITHDRAWN FOR CLASSIFICATION, MINERALS, WATER AND/OR OTHER PUBLIC PURPOSES, REFER TO INDEX OF MISCELLANEOUS DOCUMENTS.

PL 323 affects Tp

*PL 106-554 Little High Rock Canyon Wans: N 74466
affects Secs: 25-28,34-36,(W/D).*

*PL 106-554 High Rock Canyon Wans: N 74467
affects Secs: 1-4,9-16,21-28,34-36,(W/D).*

*PL 106-554 Black Rock Desert - High Rock Canyon
Emigrant Trails NCA: N 74460*

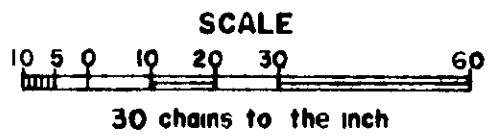

WARNING STATEMENT
This plat is the Bureau's Record of Title, and should be used only as a graphic display of the township survey data. Records herein do not reflect title changes which may have been effected by lateral movements of rivers or other bodies of water. Refer to the cadastral surveys for official survey information.

CURRENT TO	BY
12/31/2003	SL

C-020
T. 40 N
R. 22 E