

TOWNSHIP 37 NORTH RANGE 21 EAST OF THE MOUNT DIABLO MERIDIAN, NEVADA

WASHOE COUNTY
SUSANVILLE GR DIST

STATUS OF PUBLIC DOMAIN
LAND AND MINERAL TITLES

OG PLAT

INDEX TO SEGREGATED TRACTS				
RESURVEY	ORIGINAL SURVEY			
	TRACT NO	T	R	SEC

FOR ORDERS EFFECTING DISPOSAL OR USE OF
UNIDENTIFIED LANDS WITHDRAWN FOR CLASSIFICATION,
MINERALS, WATER AND/OR OTHER PUBLIC PURPOSES,
REFER TO INDEX OF MISCELLANEOUS DOCUMENTS.

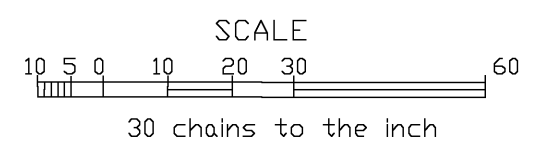
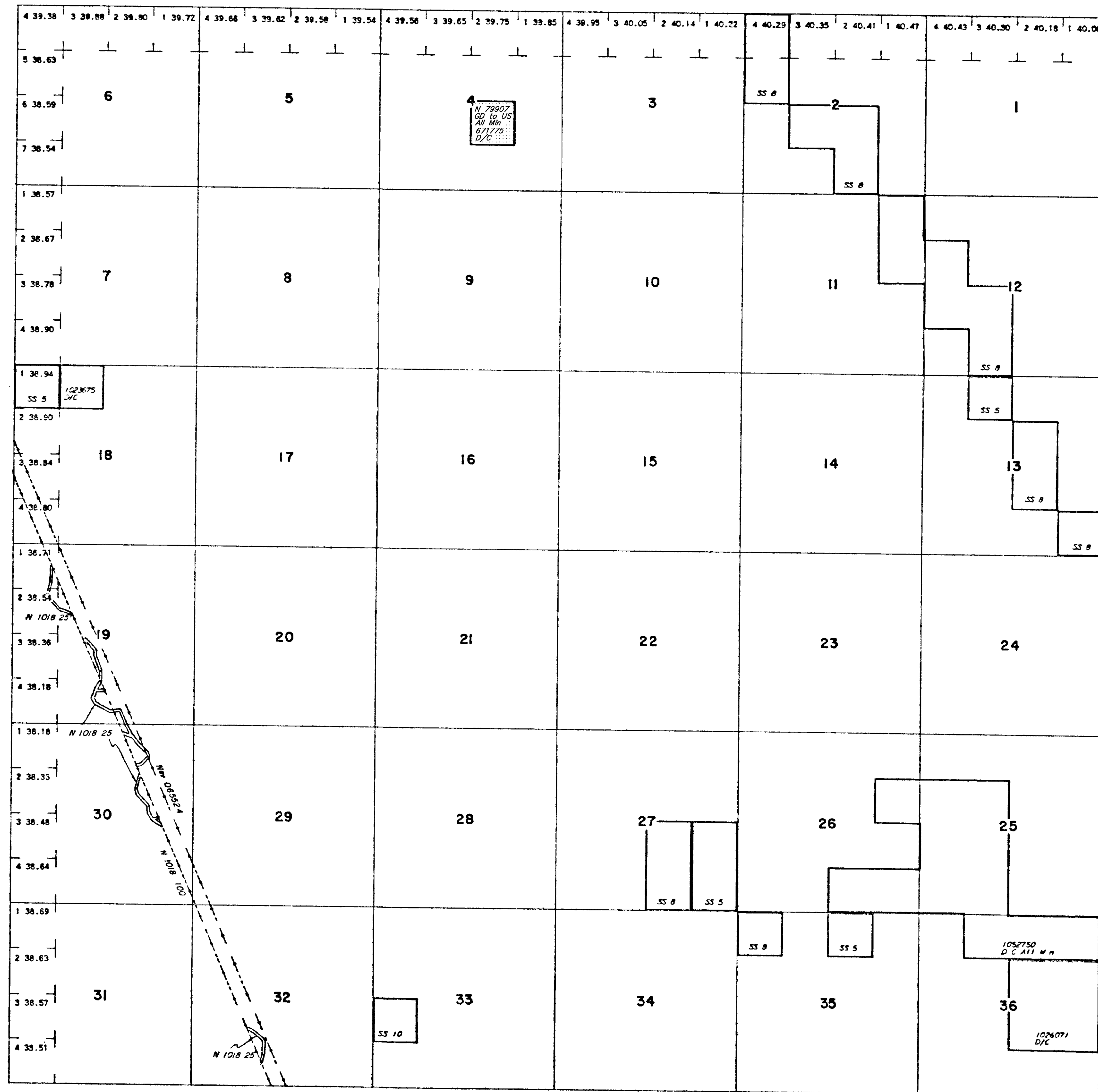

WARNING STATEMENT

This plat is the Bureau's representation of the Record of Title and should be used only as a graphic display of the township survey data. Records hereon do not reflect title changes which may have been effected by the lateral movements of rivers or other bodies of water. Refer to the cadastral surveys for official survey information.

CURRENT TO	BY
9/11/14	MS
7/26/2017	MJC

C-020
T. 37N
R. 21E