

UNSURVEYED TOWNSHIP 36 NORTH RANGE 27 EAST OF THE MOUNT DIABLO MERIDIAN, NEVADA

PROTRACTION DIAGRAM NO. 264

HUMBOLDT COUNTY
WINNEMUCCA GR DIST

**STATUS OF PUBLIC DOMAIN
LAND AND MINERAL TITLES**

MT PLAT

INDEX TO SEGREGATED TRACTS				
RESURVEY	ORIGINAL SURVEY			
TRACT NO	T	R	SEC	SUBDIVISION

FOR ORDERS EFFECTING DISPOSAL OR USE OF UNIDENTIFIED LANDS WITHDRAWN FOR CLASSIFICATION, MINERALS, WATER AND/OR OTHER PUBLIC PURPOSES, REFER TO INDEX OF MISCELLANEOUS DOCUMENTS.

PL 106-554 Black Rock Desert Wdms: N 74461

PL 106-554 Black Rock Desert - High Rock Canyon
Emigrant Trails NCA: N 74460

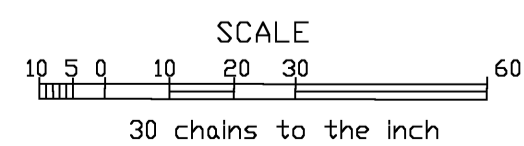
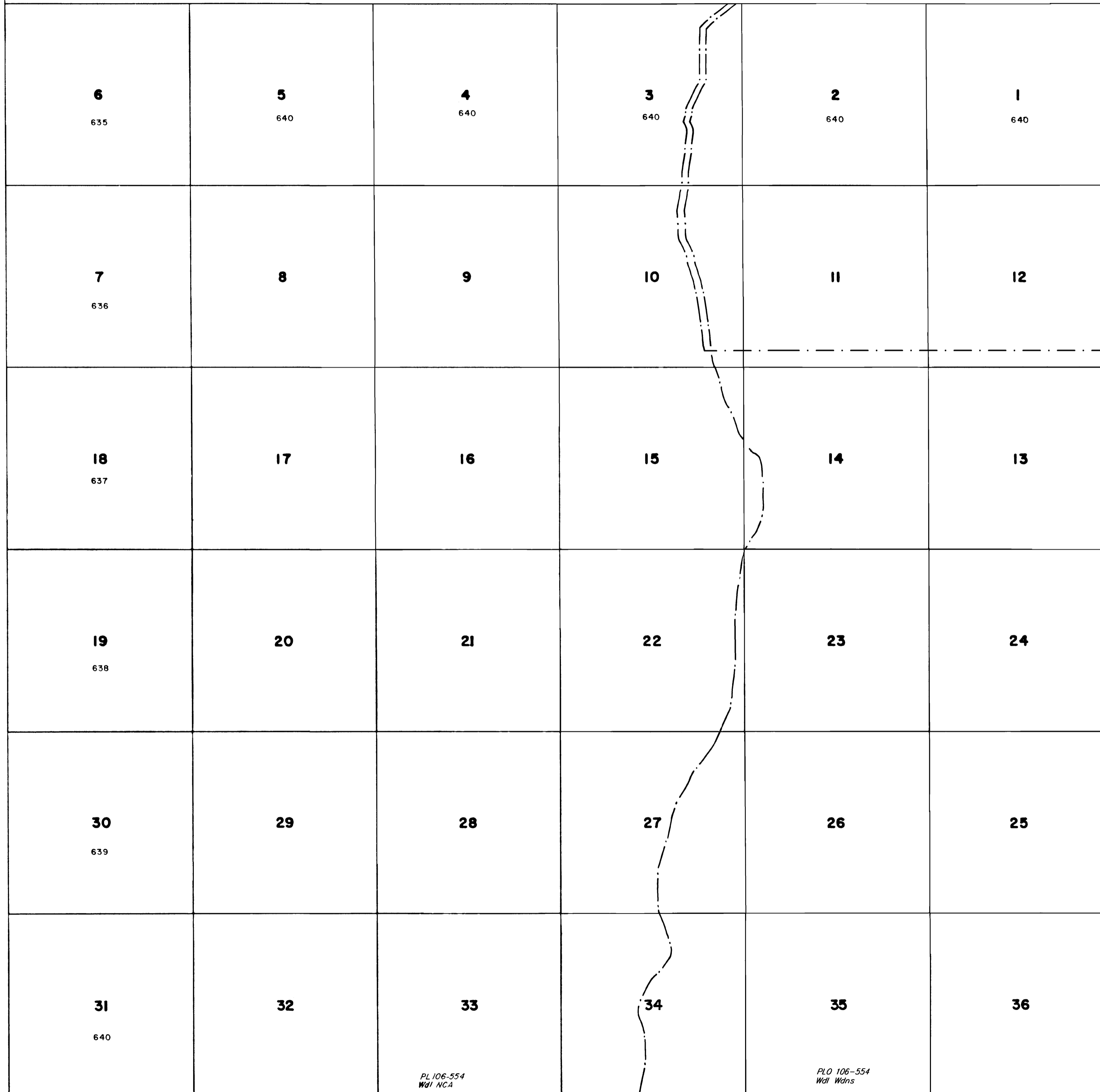

WARNING STATEMENT
This plat is the Bureau's representation of the Record of Title and should be used only as a graphic display of the township survey data. Records hereon do not reflect title changes which may have been effected by lateral movements of rivers or other bodies of water. Refer to the cadastral surveys for official survey information.

CURRENT TO	BY
12/31/2003	SL

**N020
T. 36 N
R. 27 E**