

TOWNSHIP 36 NORTH RANGE 23 EAST OF THE MOUNT DIABLO MERIDIAN, NEVADA

WASHOE COUNTY
WINNEMUCCA GR DIST

STATUS OF PUBLIC DOMAIN
LAND AND MINERAL TITLES

MT PLAT

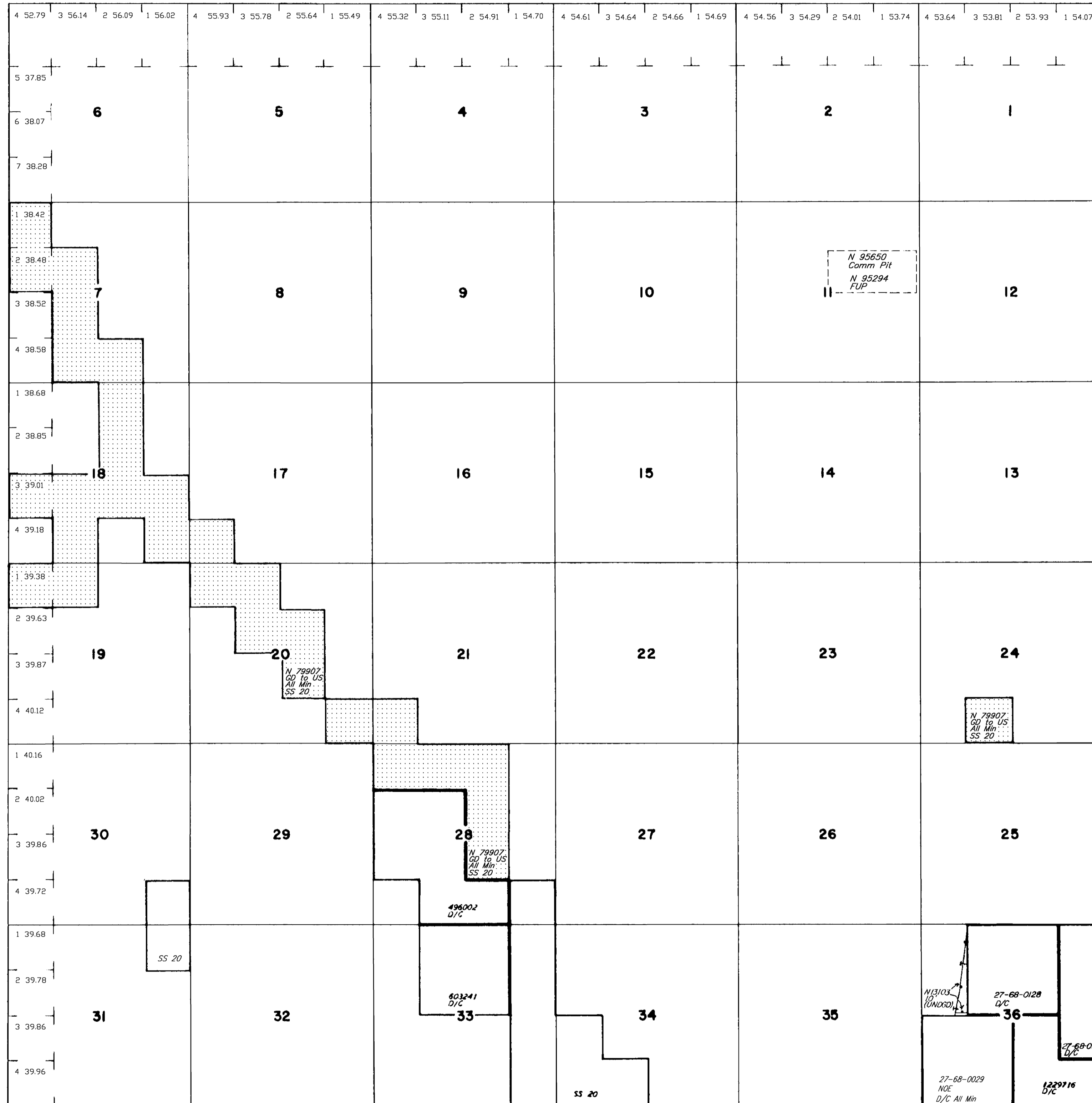

INDEX TO SEGREGATED TRACTS				
RESURVEY	ORIGINAL SURVEY			
	TRACT NO	T	R	SEC

FOR ORDERS EFFECTING DISPOSAL OR USE OF UNIDENTIFIED LANDS WITHDRAWN FOR CLASSIFICATION, MINERALS, WATER AND/OR OTHER PUBLIC PURPOSES, REFER TO INDEX OF MISCELLANEOUS DOCUMENTS.

CURRENT TO	BY	CURRENT TO	BY
07/30/2004	GRC		
07/05/2007	MS		
08/01/2017	MJC		
03/26/2020	LAJ		

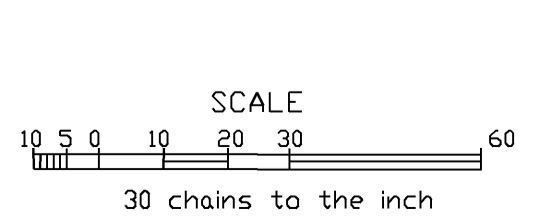

WARNING STATEMENT

This plat is the Bureau's representation of the Record of Title and should be used only as a graphic display of the township survey data. Records hereon do not reflect title changes which may have been effected by the lateral movements of rivers or other bodies of water. Refer to the cadastral surveys for official survey information.

PLAT TYPE