

TOWNSHIP 29 NORTH RANGE 40 EAST OF THE MOUNT DIABLO MERIDIAN, NEVADA

PERSHING COUNTY
WINNEMUCCA GR DIST

STATUS OF PUBLIC DOMAIN
LAND AND MINERAL TITLES
AND ACQUIRED LANDS

MT PLAT

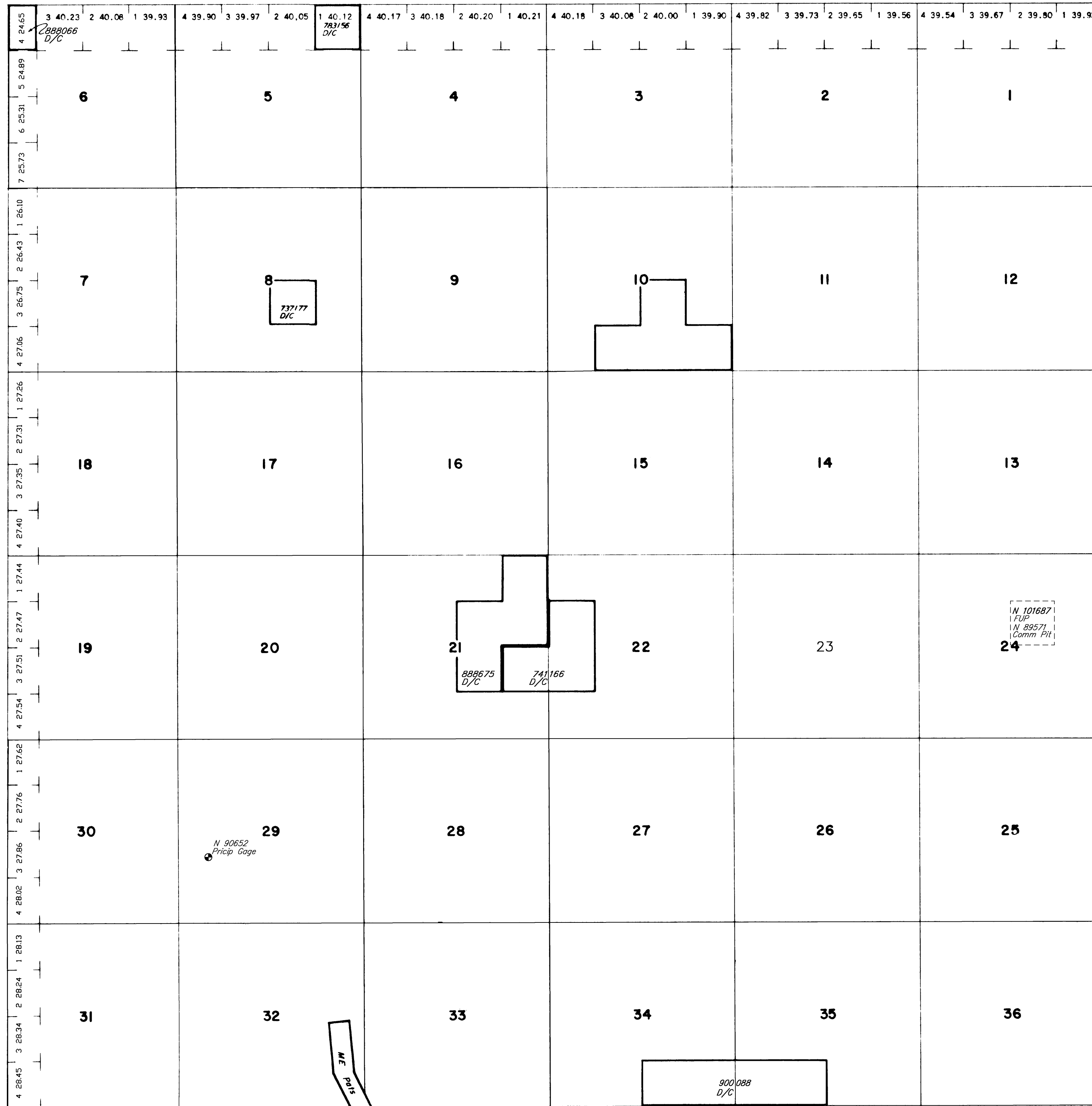

INDEX TO SEGREGATED TRACTS				
RESURVEY	ORIGINAL SURVEY			
TRACT NO	T	R	SEC	SUBDIVISION

FOR ORDERS EFFECTING DISPOSAL OR USE OF UNIDENTIFIED LANDS WITHDRAWN FOR CLASSIFICATION, MINERALS, WATER AND/OR OTHER PUBLIC PURPOSES, REFER TO INDEX OF MISCELLANEOUS DOCUMENTS.

WSA (see Dist/SO maps for exact Bdrs)
Secs: 18, 19, 30

Blank lines for recording information.

CURRENT TO	BY	CURRENT TO	BY
03/25/2024	TJ		

Lat. 40°20'N
Long. 117°25'W

T. 29 N
R. 40 E
1

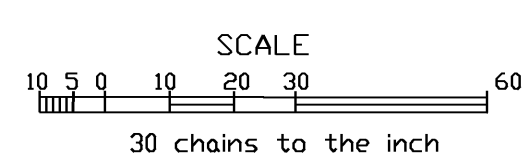

WARNING STATEMENT
This plat is the Bureau's representation of the Record of Title and should be used only as a graphic display of the township survey data. Records hereon do not reflect title changes which may have been effected by the lateral movements of rivers or other bodies of water. Refer to the cadastral surveys for official survey information.

PLAT TYPE