

TOWNSHIP 28 NORTH RANGE 20 EAST OF THE MOUNT DIABLO MERIDIAN, NEVADA

WASHOE COUNTY

STATUS OF PUBLIC DOMAIN
LAND AND MINERAL TITLES

MT PLAT

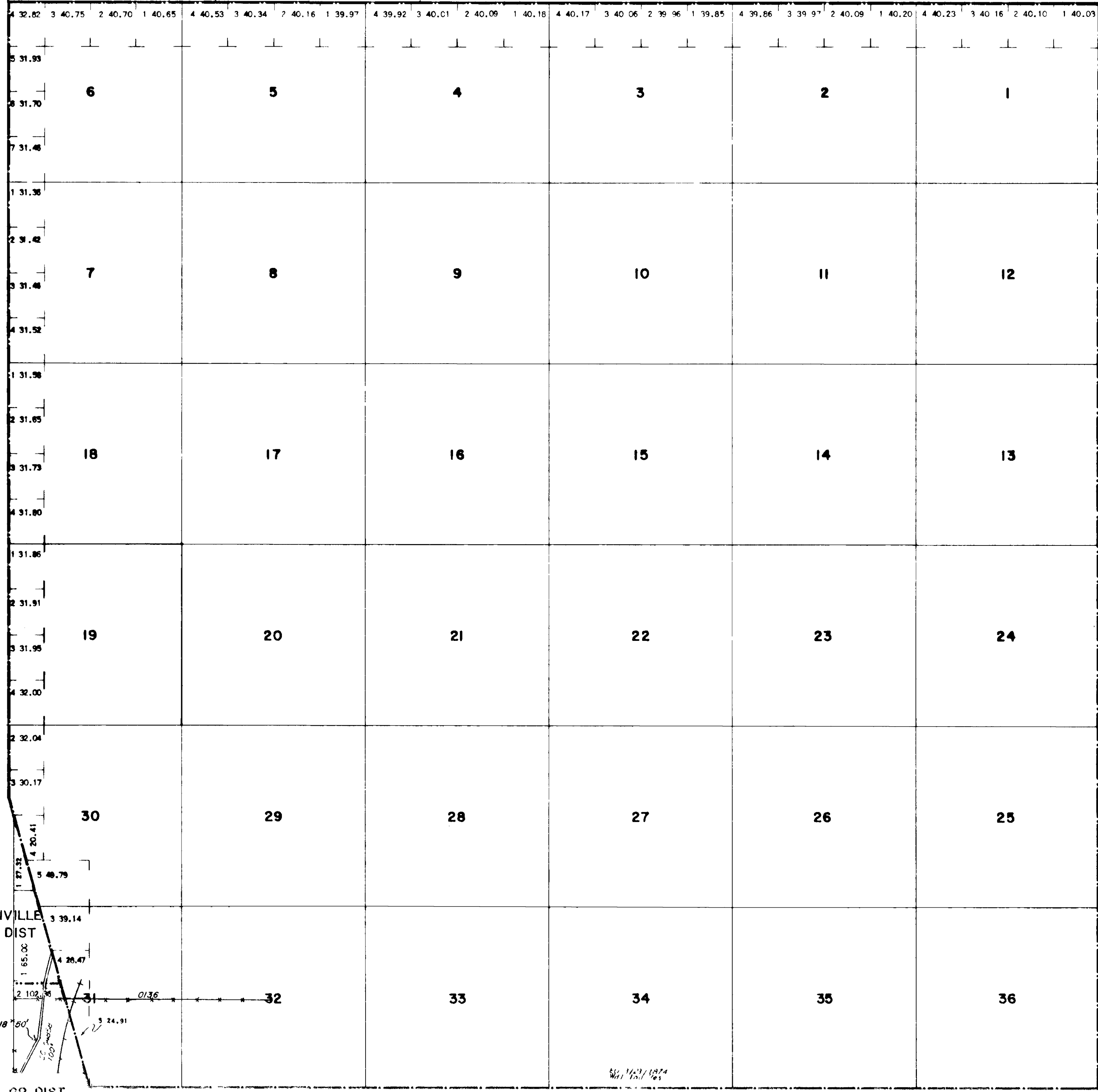

INDEX TO SEGREGATED TRACTS				
RESURVEY TRACT NO	ORIGINAL SURVEY			
	T	R	SEC	SUBDIVISION

FOR ORDERS EFFECTING DISPOSAL OR USE OF UNIDENTIFIED LANDS WITHDRAWN FOR CLASSIFICATION, MINERALS, WATER AND/OR OTHER PUBLIC PURPOSES, REFER TO INDEX OF MISCELLANEOUS DOCUMENTS.

Location of following State selection lands in Sec 19 are questionable (See Surveys of 1872 and 1911)
SS 2 approximately W 1/2 NE 1/4, NE 1/4 NW 1/4
SS 4 " NE 1/4 SE 1/4
SS 9 " NE 1/4 SW 1/4

CURRENT TO	BY

CARSON CITY GR DIST

Lat. 40°14'43"N
Long. 119°40'39"W

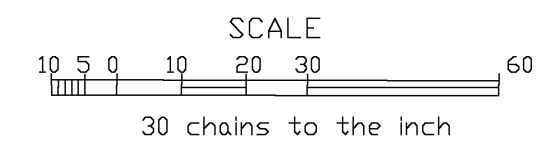

WARNING STATEMENT
This plat is the Bureau's Record of Title and should be used only as a graphic display of the township survey data. Records hereon do not reflect title changes which may have been effected by lateral movements of rivers or other bodies of water. Refer to the cadastral surveys for official survey information.

N-020
7-29-11
R-205