

TOWNSHIP 27 NORTH RANGE 68 EAST OF THE MOUNT DIABLO MERIDIAN, NEVADA

ELKO COUNTY  
ELKO GR DIST

STATUS OF PUBLIC DOMAIN  
LAND AND MINERAL TITLES

MT PLAT

INDEX TO SEGREGATED TRACTS				
RESURVEY	ORIGINAL SURVEY			
TRACT NO	T	R	SEC	SUBDIVISION

FOR ORDERS EFFECTING DISPOSAL OR USE OF  
UNIDENTIFIED LANDS WITHDRAWN FOR CLASSIFICATION,  
MINERALS, WATER AND/OR OTHER PUBLIC PURPOSES.  
REFER TO INDEX OF MISCELLANEOUS DOCUMENTS

BLM 0 CI UNSUITABLE DLE

Sec 9: S1/2

Sec 10: S1/2

Sec 15: A11

Sec 16: N1/2, E1/2SW1/4

Sec 17: E1/2

Sec 21: N1/2

N 93900 AML Physical Safety Closures Project dated 2/24/2009 Affects:

Sec 3: Lot 8.

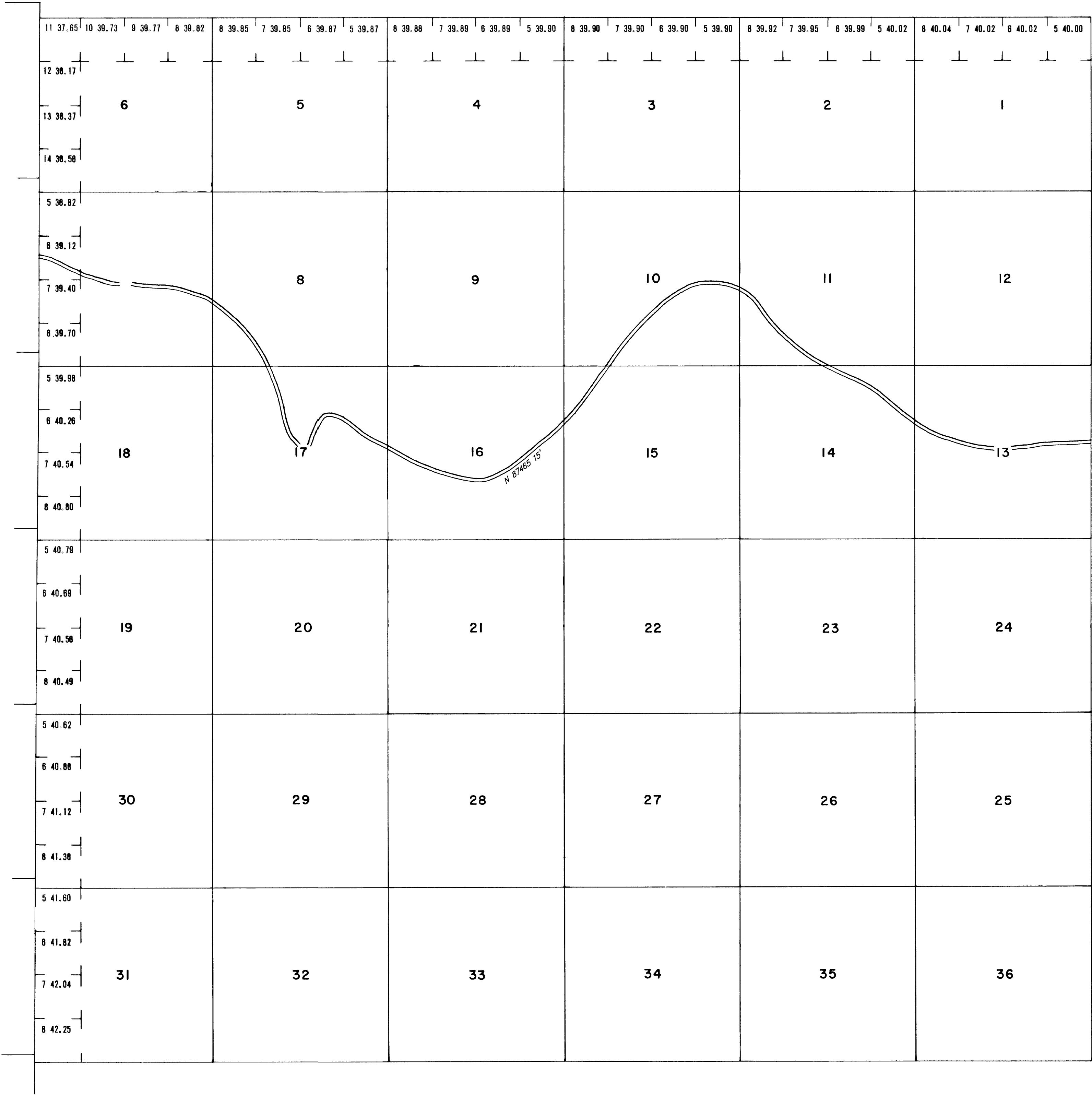

CURRENT TO	BY	CURRENT TO	BY
05/05/2025	KD		

T. 27 N  
R. 68 E

PLAT TYPE
-----------