

TOWNSHIP 22 NORTH RANGE 32 EAST OF THE MOUNT DIABLO MERIDIAN, NEVADA

CHURCHILL COUNTY
CARSON CITY

STATUS OF PUBLIC DOMAIN
LAND AND MINERAL TITLES
AND ACQUIRED LANDS

MT PLAT

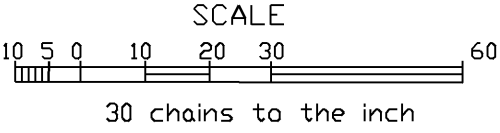
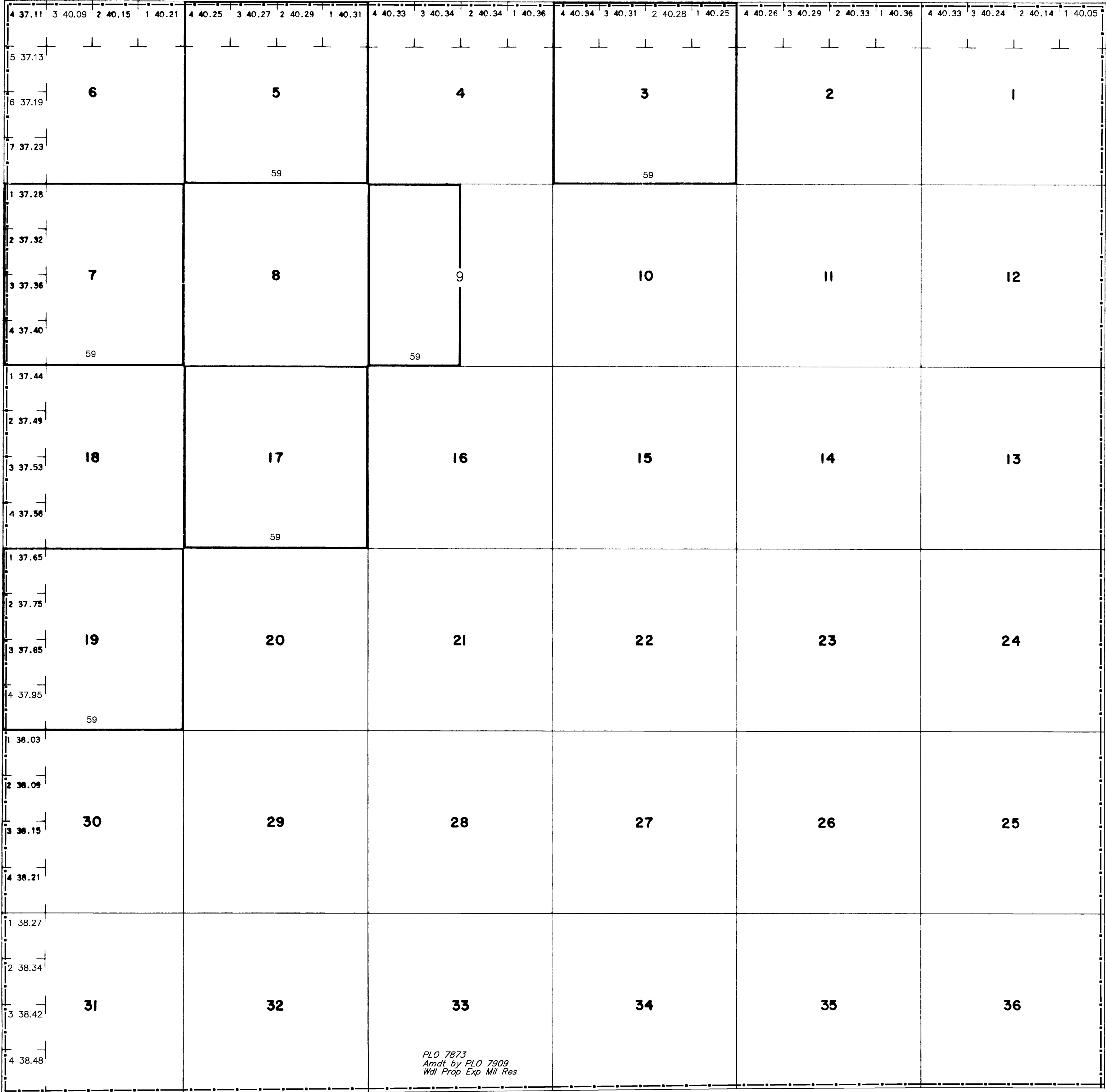

WARNING STATEMENT

This plat is the Bureau's representation of the Record of Title and should be used only as a graphic display of the township survey data. Records hereon do not reflect title changes which may have been affected by the lateral movements of rivers or other bodies of water. Refer to the cadastral surveys for official survey information.

INDEX TO SEGREGATED TRACTS				
RESURVEY	ORIGINAL SURVEY			
TRACT NO	T	R	SEC	SUBDIVISION

FOR ORDERS EFFECTING DISPOSAL OR USE OF UNIDENTIFIED LANDS WITHDRAWN FOR CLASSIFICATION, MINERALS, WATER AND/OR OTHER PUBLIC PURPOSES. REFER TO INDEX OF MISCELLANEOUS DOCUMENTS.

All Tp included in Wdl Recl Proj SO 7/2/1902, SO 8/4/1904.

DEPENDENT RESURVEY ACPT 8/23/1994

CURRENT TO	BY	CURRENT TO	BY
12/16/2024	TJ		

PLAT TYPE

T. 22 N
R. 32 E