

# PARTIALLY SURVEYED TOWNSHIP 17 NORTH RANGE 37 EAST OF THE MOUNT DIABLO MERIDIAN, NEVADA

PROTRACTION DIAGRAM NO 30

CHURCHILL COUNTY

STATUS OF PUBLIC DOMAIN  
LAND AND MINERAL TITLES  
AND ACQUIRED LANDS

## GEO PLAT

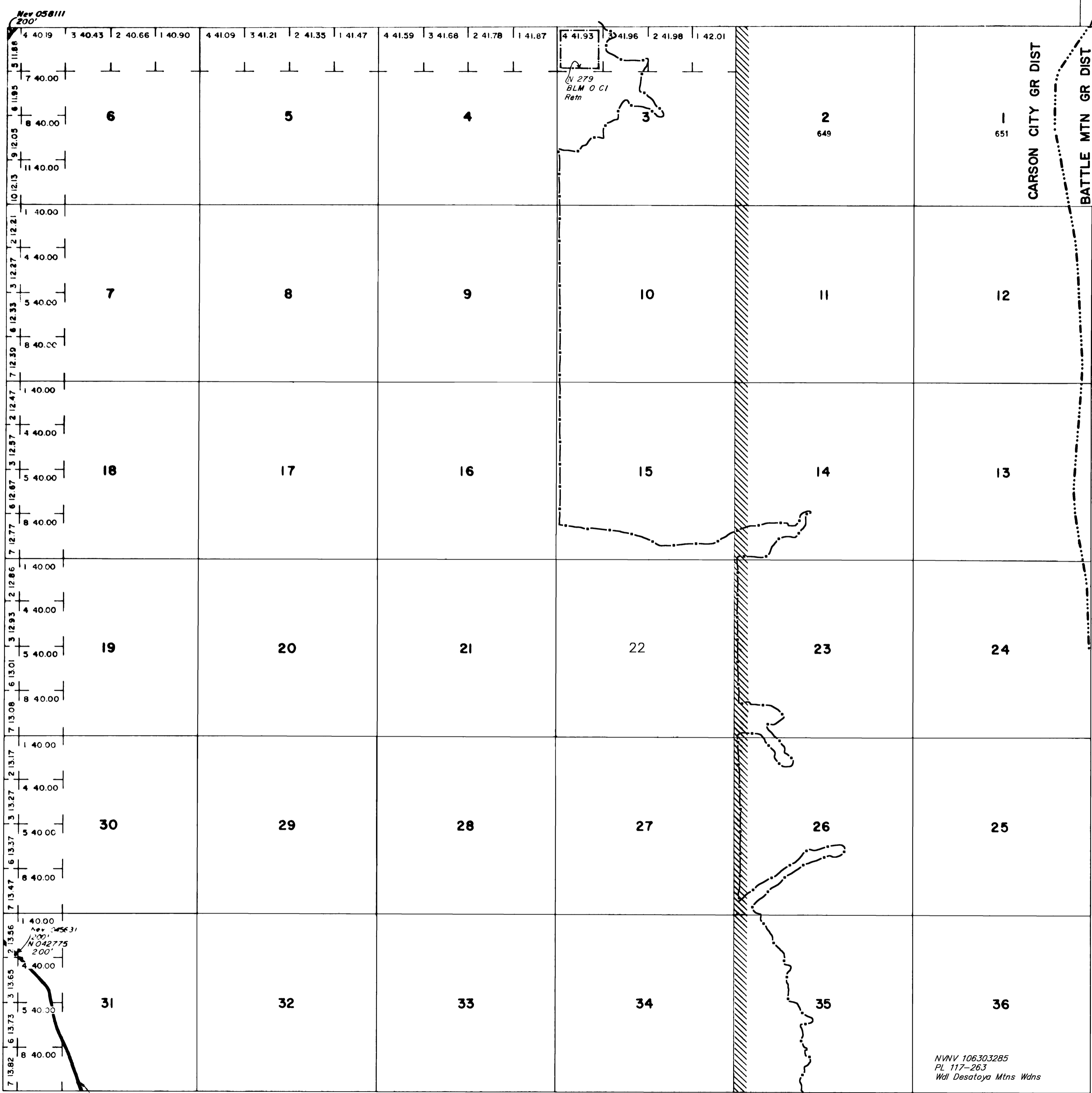

INDEX TO SEGREGATED TRACTS				
RESURVEY	ORIGINAL SURVEY			
TRACT NO	T	R	SEC	SUBDIVISION

FOR ORDERS EFFECTING DISPOSAL OR USE OF UNIDENTIFIED LANDS WITHDRAWN FOR CLASSIFICATION, MINERALS, WATER AND/OR OTHER PUBLIC PURPOSES. REFER TO INDEX OF MISCELLANEOUS DOCUMENTS.

N 1025 CI Retn Segr 8/8/1968 affects  
Secs: 1, 2, 13, lying within Lander County

NVNV 106303285, PL 117-263;  
Wal Desatoya Mtns Wdns affects;  
Secs: 1-3, 10-15, 23-26, 35, 36.

CURRENT TO	BY	CURRENT TO	BY
11/30/2023	MR		

PLAT TYPE

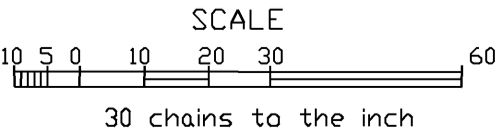

WARNING STATEMENT  
This plat is the Bureau's representation of the Record of Title and should be used only as a graphic display of the township survey data. Records hereon do not reflect title changes which may have been effected by the lateral movements of rivers or other bodies of water. Refer to the cadastral surveys for official survey information.