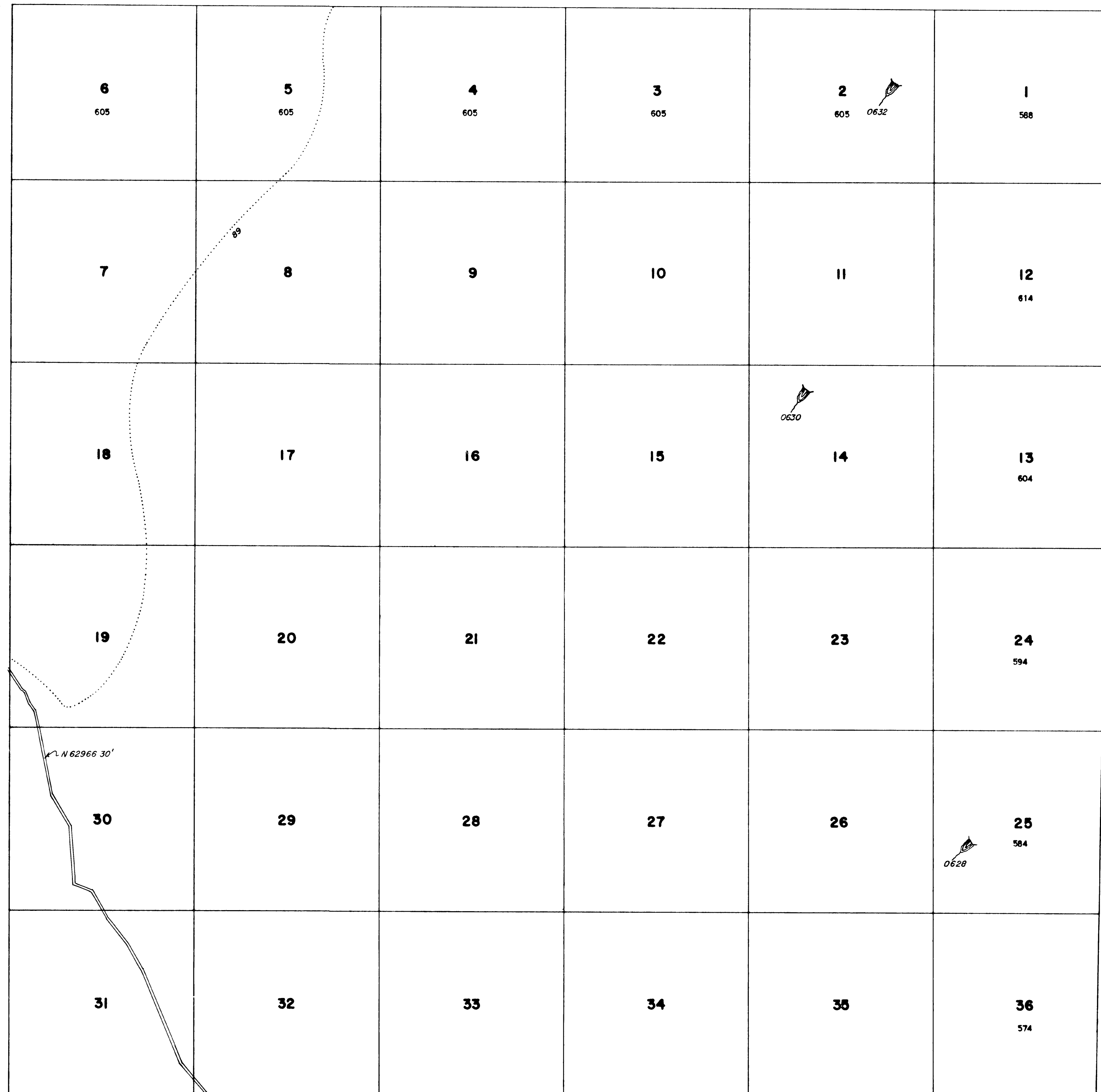

PROTRACTION DIAGRAM NO 125

## STATUS OF PUBLIC DOMAIN LAND AND MINERAL TITLES

Lat. 39°12'26.192"N  
Long. 115°49'58.950"W

[illegible]

FOR ORDERS EFFECTING DISPOSAL OR USE OF  
UNIDENTIFIED LANDS WITHDRAWN FOR CLASSIFICATION,  
MINERALS, WATER AND/OR OTHER PUBLIC PURPOSES,  
REFER TO INDEX OF MISCELLANEOUS DOCUMENTS.

This image shows a single page of white paper with horizontal blue or grey ruling lines. The lines are evenly spaced and run across the width of the page. There are no margins, text, or other markings on the paper.[illegible]

N-040

T. 15 N

55 E

## WARNING STATEMENT

This plot is the Bureau's Record of Title and should be used only as a graphic display of the township survey data. Records hereon do not reflect title changes which may have been effected by lateral movements of rivers or other bodies of water. Refer to the cadastral surveys for official survey information.

Diagram of a 30 chains to the inch scale. The scale is marked from 0 to 60 inches. The first 10 inches are divided into 30 equal segments, each representing 1 chain. The remaining 50 inches are marked at 10-inch intervals (10, 20, 30, 40, 50, 60).