

# UNSURVEYED TOWNSHIP 14 NORTH RANGE 39 EAST OF THE MOUNT DIABLO MERIDIAN, NEVADA

PROTRACTION DIAGRAM NO. 254

NYE COUNTY  
BATTLE MTN GR DIST

STATUS OF PUBLIC DOMAIN  
LAND AND MINERAL TITLES  
AND ACQUIRED LANDS

## MT PLAT

INDEX TO SEGREGATED TRACTS				
RESURVEY TRACT NO	ORIGINAL SURVEY			
	T	R	SEC	SUBDIVISION

*FOR ORDERS EFFECTING DISPOSAL OR USE OF UNIDENTIFIED LANDS WITHDRAWN FOR CLASSIFICATION, MINERALS, WATER AND/OR OTHER PUBLIC PURPOSES, REFER TO INDEX OF MISCELLANEOUS DOCUMENTS.*

*The following actions affect this Tp:*

*Nev 052022 Determination P.L. 167 (Act of Cong 7/23/1955) complete 5/19/1961. All N.F. surface management by USFS*

*N7230 Easement 44LD513 FS affects Secs 5, 19 & 30*

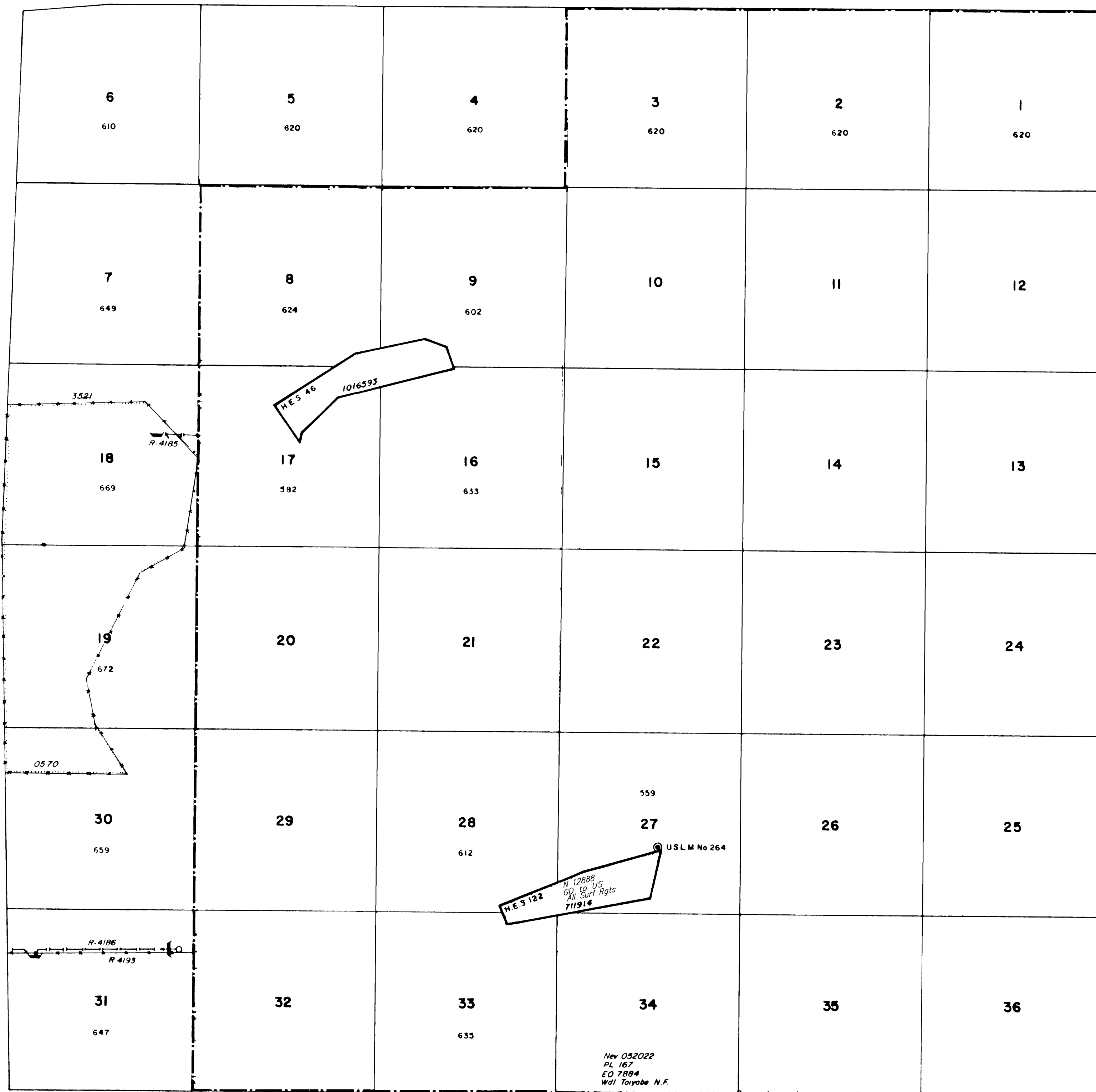

Lat. 39°01'40.492"N  
Long 117°38'46.776"W

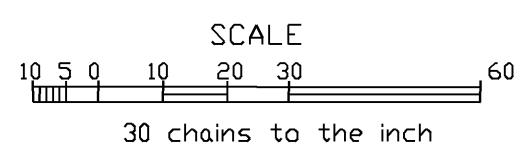

WARNING STATEMENT

This plat is the Bureau's Record of Title and should be used only as a graphic display of the township survey data. Records hereon do not reflect title changes which may have been effected by lateral movements of rivers or other bodies of water. Refer to the cadastral surveys for official survey information.

CURRENT TO	BY

N-060  
T. 14 N.  
R. 39 E.