

WHITE PINE COUNTY  
ELY GR DIST

OG PLAT

FOR ORDERS EFFECTING DISPOSAL OR USE OF  
UNIDENTIFIED LANDS WITHDRAWN FOR CLASSIFICATION,  
MINERALS, WATER AND/OR OTHER PUBLIC PURPOSES.  
REFER TO INDEX OF MISCELLANEOUS DOCUMENTS.

N-040  
12N  
64E

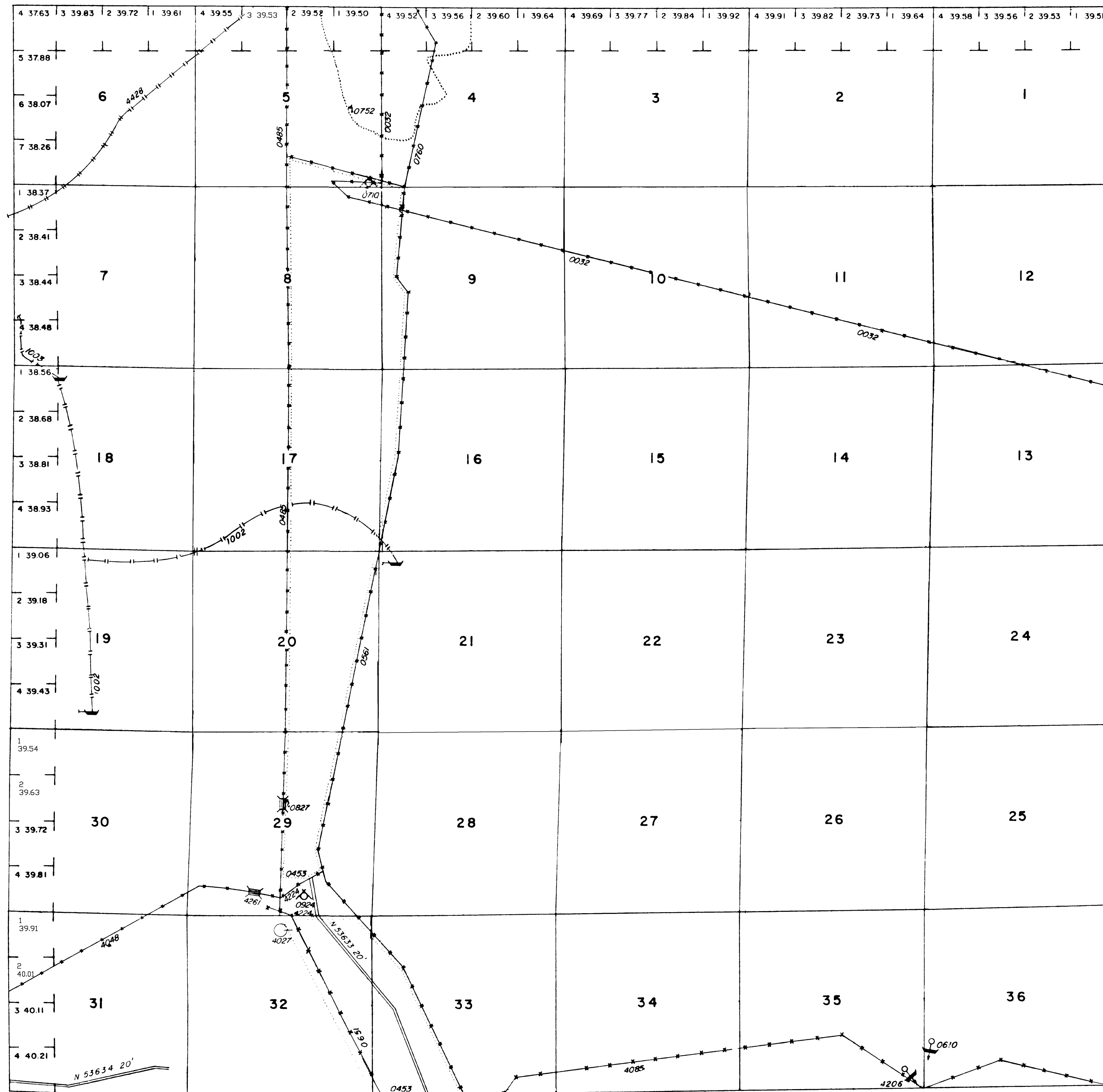

Lat.  $38^{\circ}51'04''$  N.  
Long.  $114^{\circ}43'31''$  W.

SCALE

10 5 0 10 20 30 60

30 chains to the inch

## WARNING STATEMENT

This plot is the Bureau's Record of Title and should be used only as a graphic display of the township survey data. Records hereon do not reflect title changes which may have been effected by lateral movements of rivers or other bodies of water. Refer to the cadastral surveys for official survey information.