

TOWNSHIP 11 NORTH RANGE 37 EAST OF THE MOUNT DIABLO MERIDIAN, NEVADA

NYE COUNTY
BATTLE MTN GR DIST

STATUS OF PUBLIC DOMAIN
LAND AND MINERAL TITLES

MT PLAT

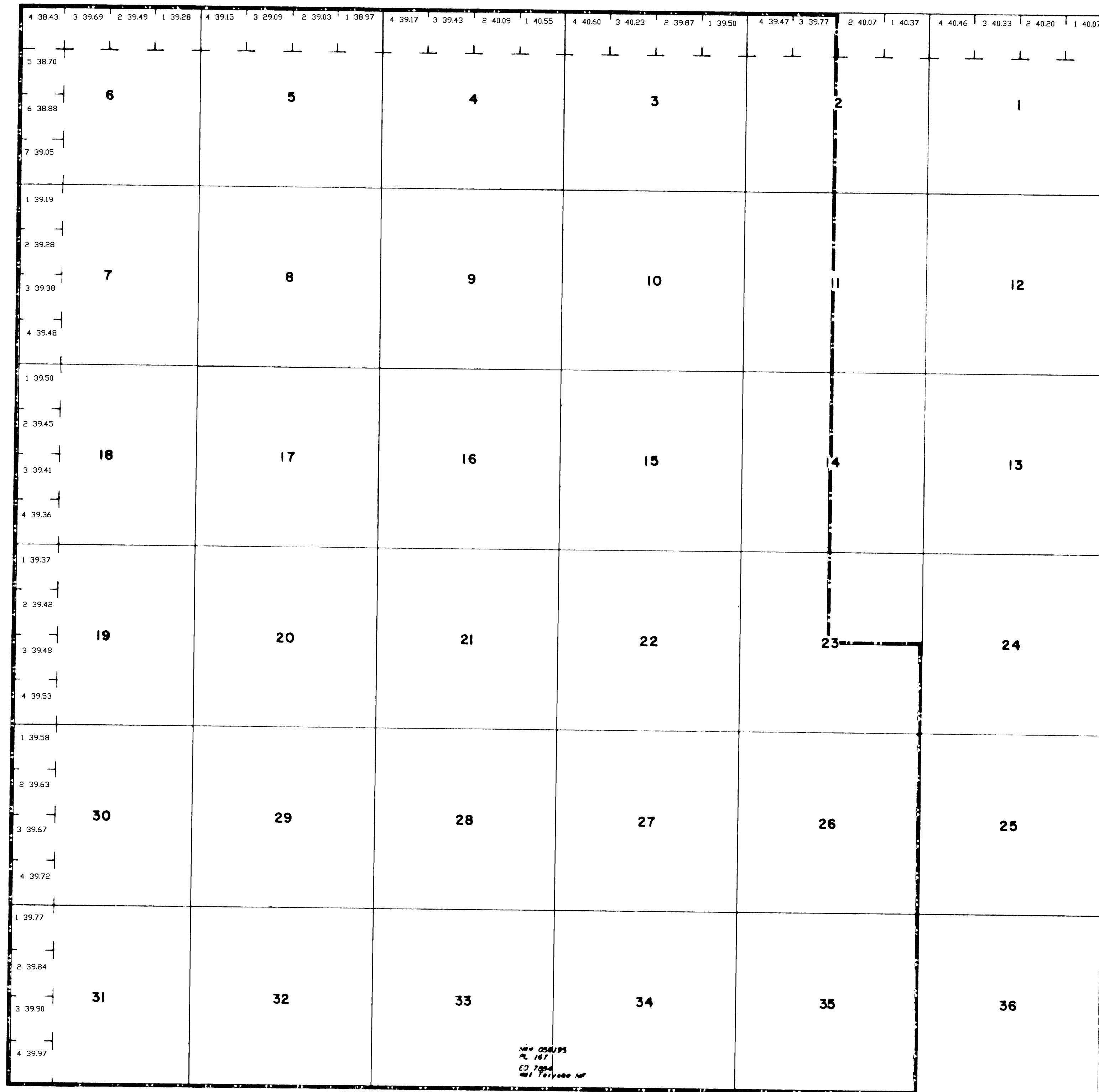

INDEX TO SEGREGATED TRACTS				
RESURVEY	ORIGINAL SURVEY			
TRACT NO	T	R	SEC	SUBDIVISION

FOR ORDERS EFFECTING DISPOSAL OR USE OF UNIDENTIFIED LANDS WITHDRAWN FOR CLASSIFICATION, MINERALS, WATER AND/OR OTHER PUBLIC PURPOSES, REFER TO INDEX OF MISCELLANEOUS DOCUMENTS.

Nev 056195 Determination P.L. 167 (Act of Cong 7/23/1955) complete 4/30/1962. All N.F. surface management by USES except mining claims. Canyon Nos 1, 2, 3; Juniper No 1, 2, 3, 4, 5, 6, 7, 8; in Sec 15, 16, 21, 22, 28, 29, 32, 33, 34

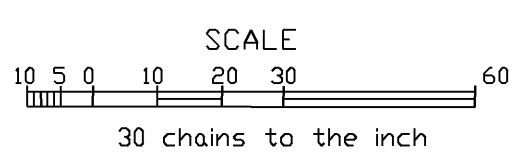

WARNING STATEMENT
This plat is the Bureau's Record of Title and should be used only as a graphic display of the township survey data. Records hereon do not reflect title changes which may have been effected by lateral movements of rivers or other bodies of water. Refer to the cadastral surveys for official survey information.

CURRENT TO	BY