

UNSURVEYED TOWNSHIP 9 NORTH RANGE 40 EAST OF THE MOUNT DIABLO MERIDIAN, NEVADA

PROTRACTION DIAGRAM NO. 211

NYE COUNTY

STATUS OF PUBLIC DOMAIN
LAND AND MINERAL TITLES

MT PLAT

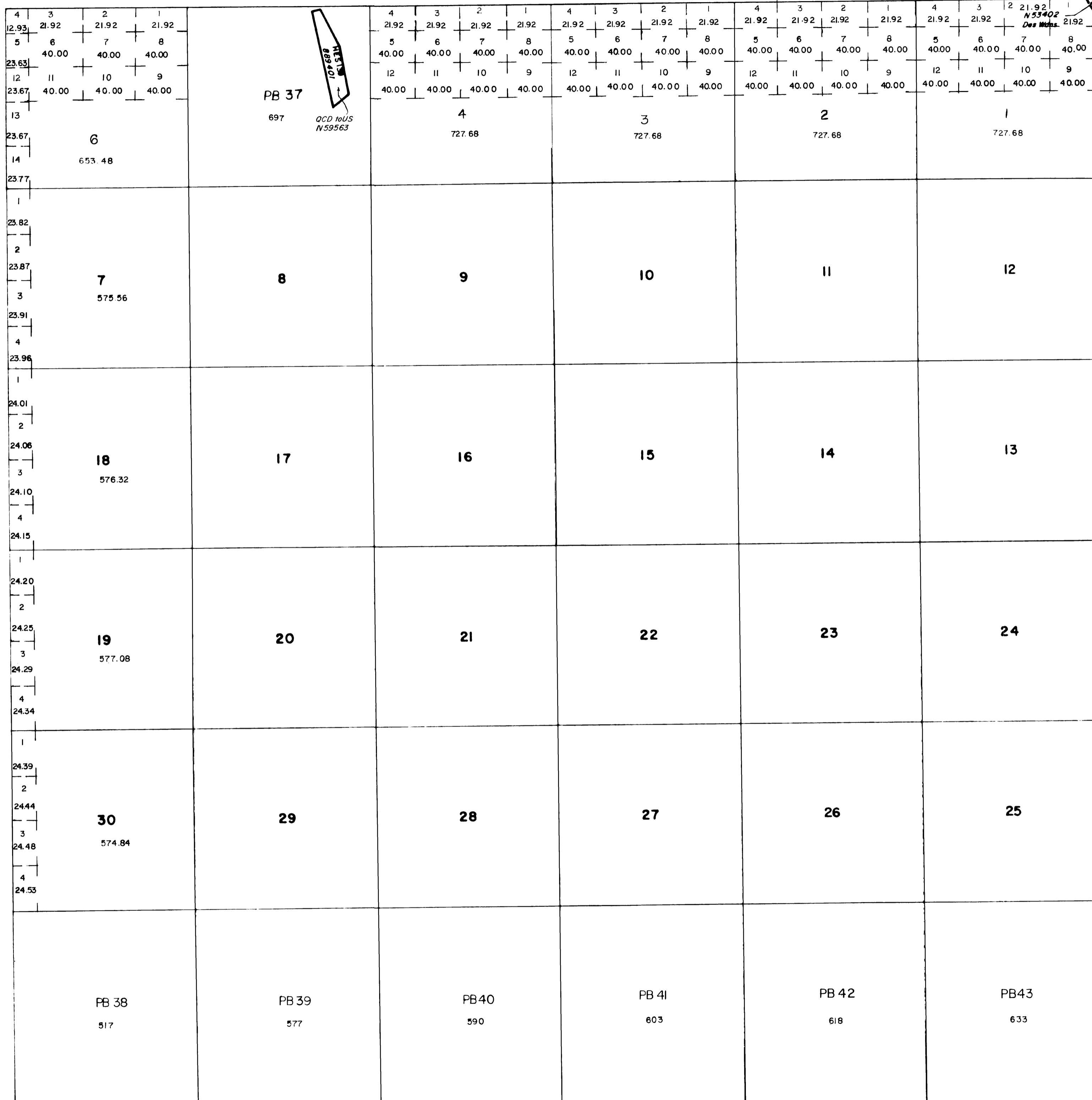

RESURVEY		ORIGINAL SURVEY			
TRACT NO.	T	R	SEC	SUBDIVISION	

FOR ORDERS EFFECTING DISPOSAL OR USE OF UNIDENTIFIED LANDS WITHDRAWN FOR CLASSIFICATION, MINERALS, WATER AND/OR OTHER PUBLIC PURPOSES, REFER TO INDEX OF MISCELLANEOUS DOCUMENTS.

All TP included in Bd1 Toriyabe N.F. EG 7894 5/9/1930

*All TP included in Mex 056195 Determination P. 167 (Act of Cong 7/23/1955) complete 4/30/1962
All N.F. surface management by USFS except mining claim OR, Secs 7, 10*

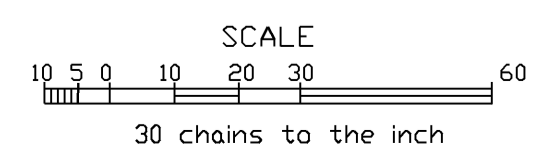

WARNING STATEMENT
This plat is the Bureau's representation of the Record of Title and should be used only as a graphic display of the township survey data. Records hereon do not reflect title changes which may have been effected by the lateral movements of rivers or other bodies of water. Refer to the cadastral surveys for official survey information.

CURRENT TO	BY	CURRENT TO	BY
08/23/2023	DMG		

PLAT TYPE

T. 9 N
R. 40 E