

TOWNSHIP 9 NORTH RANGE 34 EAST OF THE MOUNT DIABLO MERIDIAN, NEVADA

MINERAL COUNTY
CARSON CITY GR DIST

STATUS OF PUBLIC DOMAIN
LAND AND MINERAL TITLES

MT PLAT

INDEX TO SEGREGATED TRACTS				
RESURVEY		ORIGINAL SURVEY		
TRACT NO	T	R	SEC	SUBDIVISION

FOR ORDERS EFFECTING DISPOSAL OR USE OF UNIDENTIFIED LANDS WITHDRAWN FOR CLASSIFICATION, MINERALS, WATER AND/OR OTHER PUBLIC PURPOSES, REFER TO INDEX OF MISCELLANEOUS DOCUMENTS.

WSA (see Dist./SO maps for exact Bdrs)
Secs: 1-18 20-28

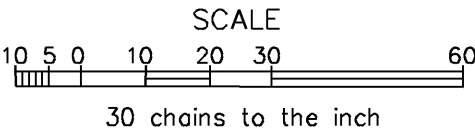
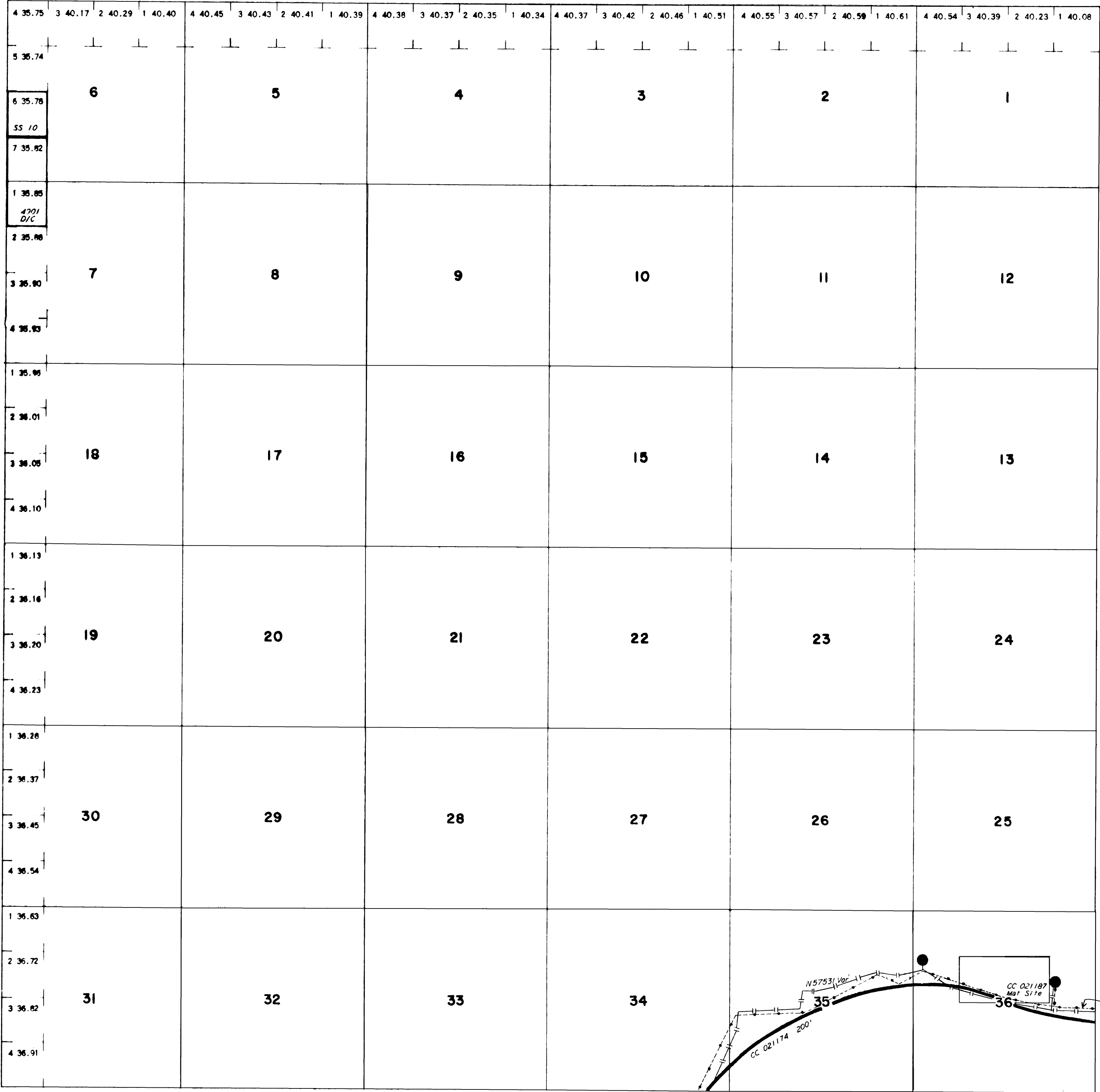

WARNING STATEMENT
This plat is the Bureau's representation of the Record of Title and should be used only as a graphic display of the township survey data. Records hereon do not reflect title changes which may have been effected by the lateral movements of rivers or other bodies of water. Refer to the cadastral surveys for official survey information.

CURRENT TO	BY
7/30/03	MS
2/17/11	MS
06/28/2022	SAL

N030
T. 9N
R. 34E