

PARTIALLY SURVEYED TOWNSHIP 8 NORTH RANGE 41 EAST OF THE MOUNT DIABLO MERIDIAN, NEVADA

PROTRACTION DIAGRAM NO. 212

NYE COUNTY  
BATTLE MTN GR DIST

STATUS OF PUBLIC DOMAIN  
LAND AND MINERAL TITLES

MT PLAT

INDEX TO SEGREGATED TRACTS				
RESURVEY		ORIGINAL SURVEY		
TRACT NO	T	R	SEC	SUBDIVISION

FOR ORDERS EFFECTING DISPOSAL OR USE OF UNIDENTIFIED LANDS WITHDRAWN FOR CLASSIFICATION, MINERALS, WATER AND/OR OTHER PUBLIC PURPOSES, REFER TO INDEX OF MISCELLANEOUS DOCUMENTS.

The following actions affect this TP:  
Nev US5135 Determination P.L. 167 (Act of Cong 7/23/1955) complete 4/30/1962. All N.F. surface management by USFS

Portion of East boundary independent resurvey 9/10/1965

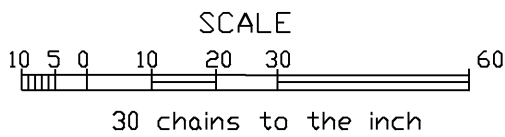
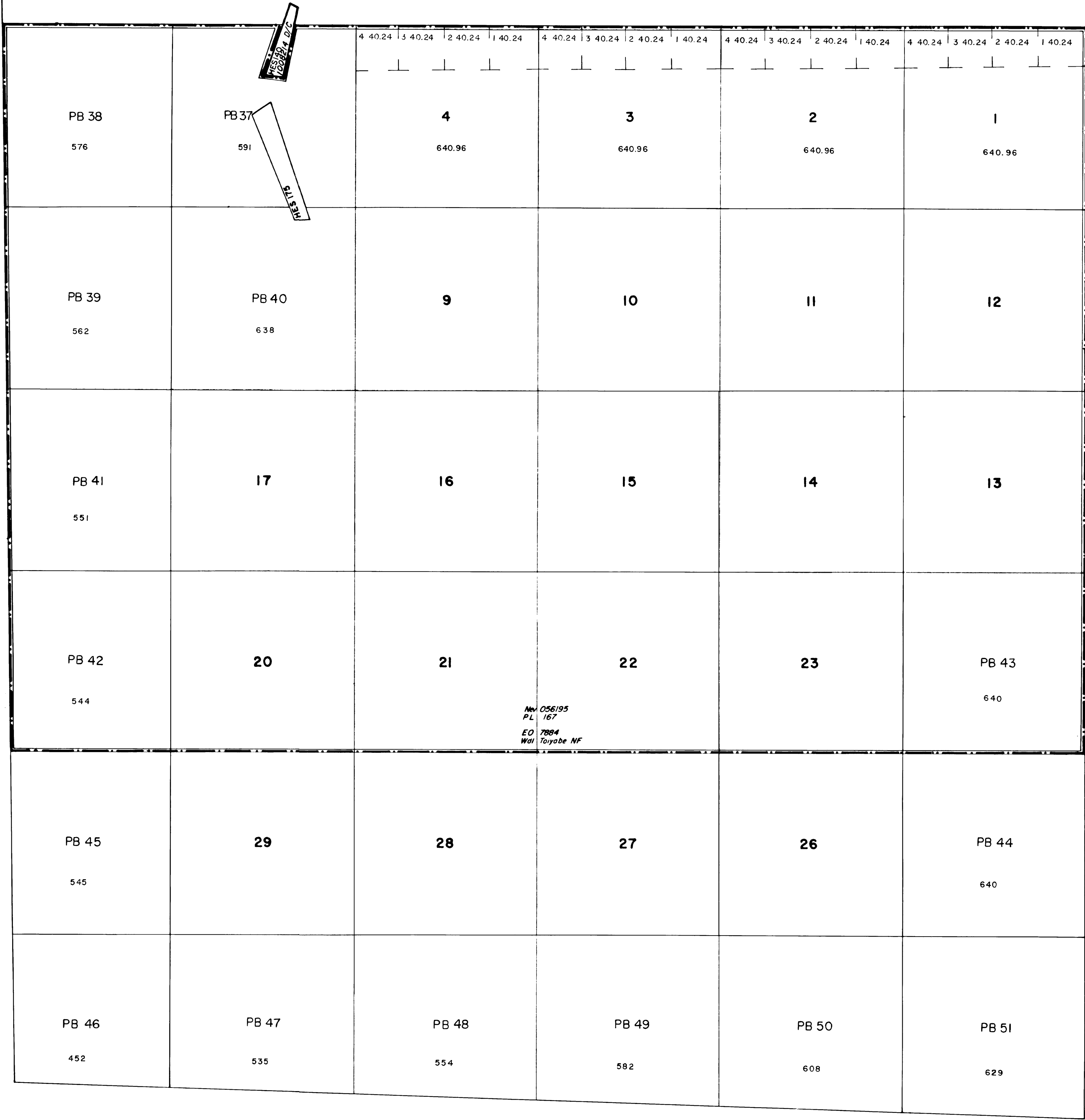

WARNING STATEMENT  
This plat is the Bureau's Record of Title and should be used only as a graphic display of the township survey data. Records hereon do not reflect title changes which may have been effected by lateral movements of rivers or other bodies of water. Refer to the cadastral surveys for official survey information.

CURRENT TO	BY

N-060  
T. 8N  
R. 41E