

UNSURVEYED TOWNSHIP 6 NORTH RANGE 37 EAST OF THE MOUNT DIABLO MERIDIAN, NEVADA

PROTRACTION DIAGRAM NO. 258

MINERAL COUNTY
ESMERALDA COUNTY

**STATUS OF PUBLIC DOMAIN
LAND AND MINERAL TITLES**

GEO PLAT

Lat. 38°24'48.105"N
Long. 117°54'42.087"W

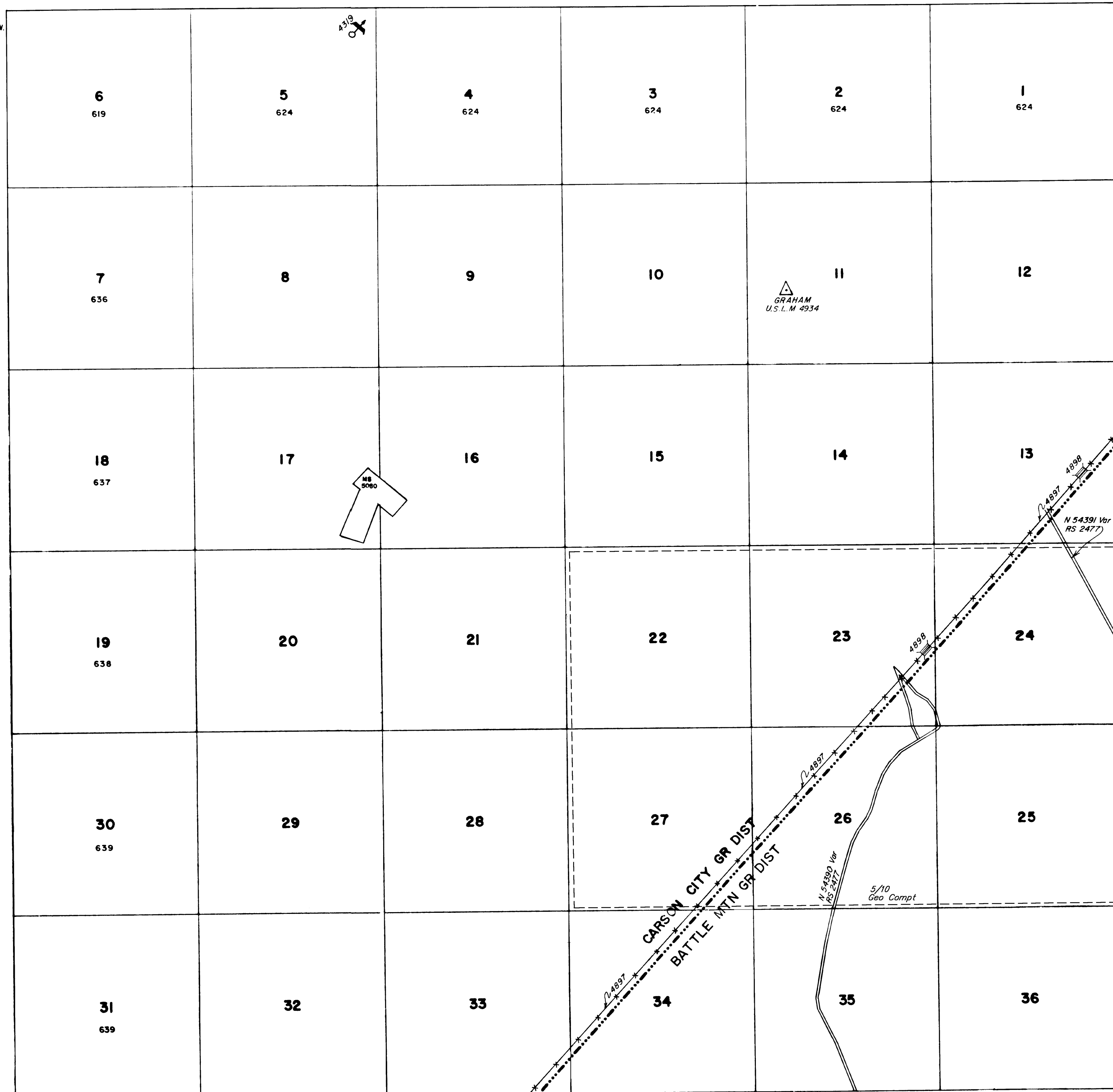

INDEX TO SEGREGATED TRACTS				
RESURVEY TRACT NO	ORIGINAL SURVEY			
	T	R	SEC	SUBDIVISION

FOR ORDERS EFFECTING DISPOSAL OR USE OF UNIDENTIFIED LANDS WITHDRAWN FOR CLASSIFICATION, MINERALS, WATER AND/OR OTHER PUBLIC PURPOSES, REFER TO INDEX OF MISCELLANEOUS DOCUMENTS.

N 46253 R/W Research Trenches W/I
 Sec 3: E/2NW1/4, NE1/4SE1/4
 Sec 10: SE1/4NE1/4
 Sec 11: SW1/4SW1/4
 Sec 15: NE1/4NE1/4

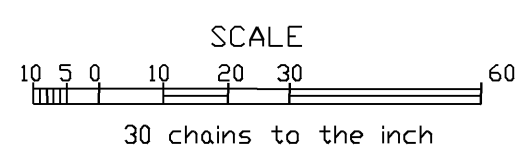

WARNING STATEMENT
 This plat is the Bureau's Record of Title and should be used only as a graphic display of the township survey data. Records hereon do not reflect title changes which may have been effected by lateral movements of rivers or other bodies of water. Refer to the cadastral surveys for official survey information.

CURRENT TO	BY
12/10/09	MS
3/23/10	MS

N 030
 N 060
 T 6 N
 R 37 E