

PARTIALLY SURVEYED TOWNSHIP 5 NORTH RANGE 42 EAST OF THE MOUNT DIABLO MERIDIAN, NEVADA

PROTRACTION DIAGRAM NO.214

NYE COUNTY
BATTLE MTN GR DIST

STATUS OF PUBLIC DOMAIN
LAND AND MINERAL TITLES

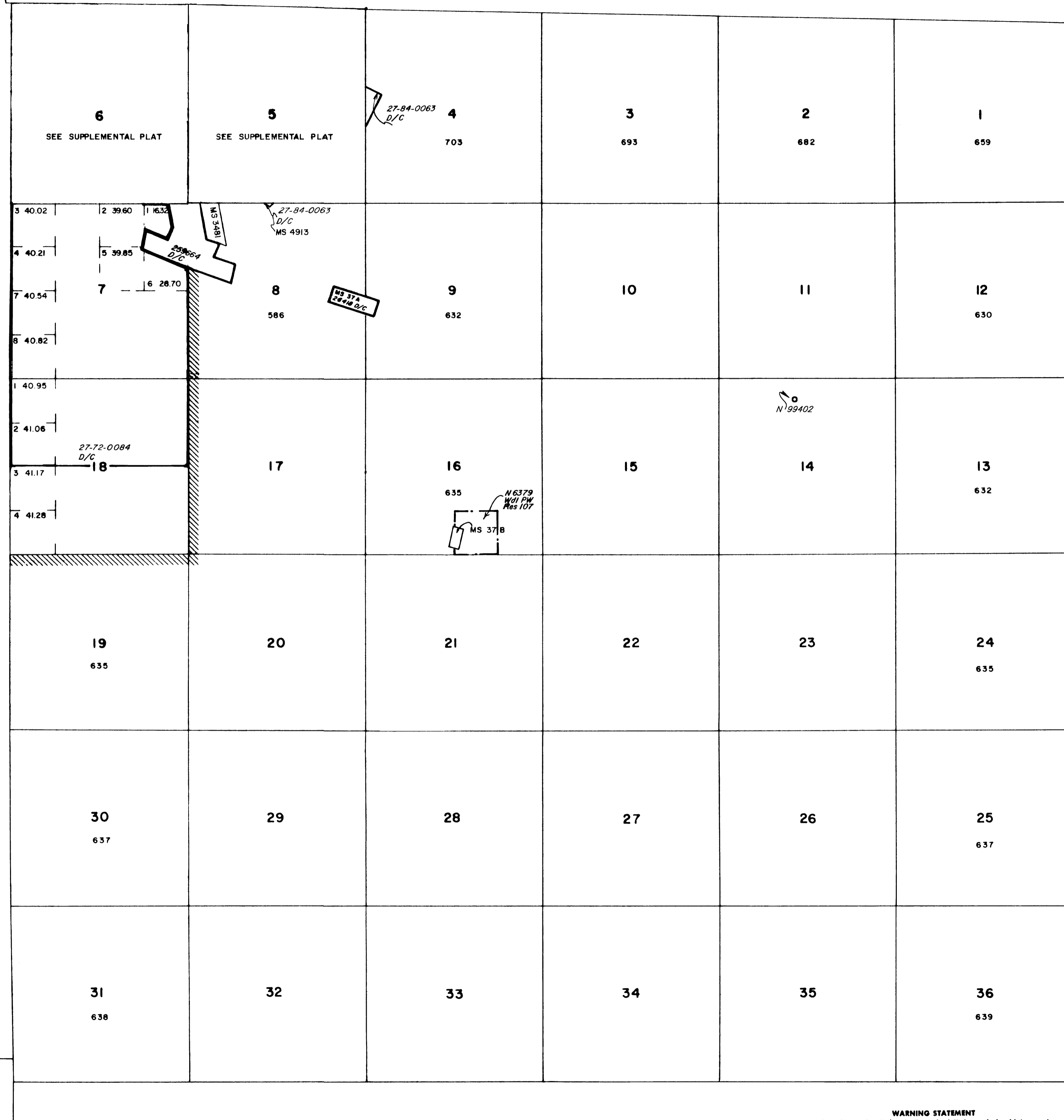

MT PLAT

INDEX TO SEGREGATED TRACTS				
RESURVEY TRACT NO	ORIGINAL SURVEY			SUBDIVISION
	T	R	SEC	

FOR ORDERS EFFECTING DISPOSAL OR USE OF UNIDENTIFIED LANDS WITHDRAWN FOR CLASSIFICATION, MINERALS, WATER AND/OR OTHER PUBLIC PURPOSES. REFER TO INDEX OF MISCELLANEOUS DOCUMENTS.

CURRENT TO	BY
10-6-82	
10-11-82	
11-24-83	
10-2-84	JML
8-26-99	YB
03/26/2020	LAJ

Lat. 38°14'18.1" N.
Long. 117°12'07.4" W.

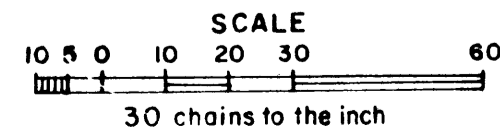

WARNING STATEMENT
This plat is the Bureau's Record of Title, and should be used only as a graphic display of the township survey data. Records hereon do not reflect title changes which may have been effected by lateral movements of rivers or other bodies of water. Refer to the cadastral surveys for official survey information.

N-060
T 5 N.
R 42 E