

# TOWNSHIP 2 NORTH RANGE 53 EAST OF THE MOUNT DIABLO MERIDIAN, NEVADA

NYE COUNTY  
BATTLE MTN GR DIST

STATUS OF PUBLIC DOMAIN  
LAND AND MINERAL TITLES

## MT PLAT

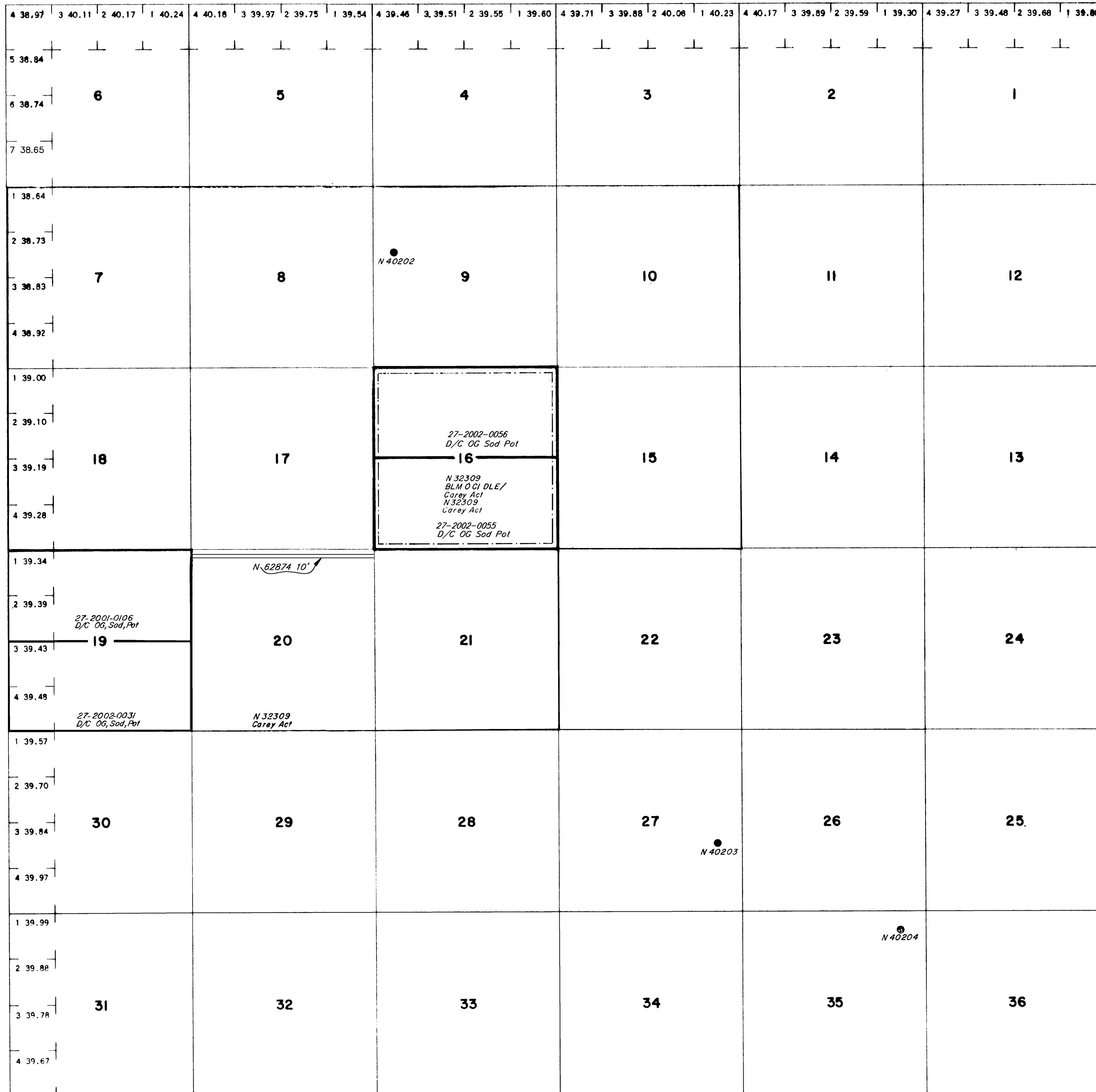

RESURVEY	ORIGINAL SURVEY			
	TRACT NO	T	R	SEC

FOR ORDERS EFFECTING DISPOSAL OR USE OF UNIDENTIFIED LANDS WITHDRAWN FOR CLASSIFICATION, MINERALS, WATER AND/OR OTHER PUBLIC PURPOSES, REFER TO INDEX OF MISCELLANEOUS DOCUMENTS.

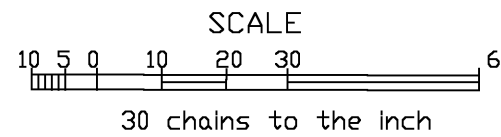

WARNING STATEMENT  
This plat is the Bureau's representation of the Record of Title and should be used only as a graphic display of the township survey data. Records hereon do not reflect title changes which may have been effected by the lateral movements of rivers or other bodies of water. Refer to the cadastral surveys for official survey information.

CURRENT TO	BY
4/2/21	
1-25-83	
7/18/85	Jack
3-13-86	RTA
11-9-91	KB
8/22/01	Sec
3/4/02	SLI
6/14/02	SLI
09/16/2021	SAL

N-060  
T...2N  
R. 53E